



**TECHNICAL MANUAL
for ELECTROMECHANICAL CC 875
ELECTRONIC CC 875 L and CC 875 E
CASSETTE SPLIT SYSTEMS**

This manual provides technical and installation information for
ELECTROMECHANICAL CC 875, ELECTRONIC CC 875 L and CC 875 E systems:-
INDOOR UNIT: 555 series CC 875, CC875 L or CC875 E

	INDEX	PAGE
GENERAL	Part numbers, dimensions and weights	2
	Features/accessories, optional heating, airflows	3
SELECTION	Performance data	4 - 7
	Discharge velocities, fresh air supply	8
	Branch duct, discharge blanking	9
ELECTRICAL	Electrical Data	9
	Recommended Fuse Sizes	10
SOUND LEVELS	Sound Pressure/Sound Power Levels	11
UNIT INSTALLATION	CC 875 unpacking	12
	Dimensions, weights, chassis removal	13
	Pipework, restrictors	14
	Condensate drain	15
	Air outlet blanking, fitting the fascia	16
	Electrical supply and interconnecting options	17
	CC875 fan speed selection	17
	CC875 L PCBA configuration	18
	Outdoor unit supply wiring, fire link	18
	Additional refrigerant and oil	19
	Check list	20
	WIRING DIAGRAMS	CC 875 units
Interconnecting wiring		
OPERATING INSTRUCTIONS	CC 875	26-27
	CC 875 L	28-30
	CC 875 E	31-35
IMAGE 875 KITS	Electric heater kits	36-39
	5m high condensate pump	40-42
	BMS interface kit	43
	Fresh air inlet	44
	Branch duct discharge spigot	45
	Remote temperature sensor kit	46
	EMC termination Kit (CC 875 E units only)	47
COMPONENT IDENTIFICATION	Exploded views showing components	48-49
FAULT FINDING	All units	50-53

55508077-06

TEV LTD, ARMYTAGE ROAD, BRIGHOUSE, WEST YORKSHIRE, HD6 1QF. TEL: + 44 (0) 1484 405600 FAX: +44 (0) 1484 405620
EMAIL: sales@marstair.com WEB: www.marstair.com

The **CC 875 CASSETTE** range consists of the 555 series CC875 cassette indoor units.

PART NUMBERS

CC875 COOL AND HEAT PUMP MODELS

	Fitted with lift pump			Fitted with condensate pump		
Electronic L	80L	110L	140L	80L	110L	140L
part number	55522013	55522014	55522015	55522028	55522029	55522030
Electronic E	80E	110E	140E	80E	110E	140E
Part Number	55522016	55522017	55522018	55522031	55522032	55522033

CC875 COOL ONLY MODELS

	Fitted with lift pump			Fitted with condensate pump		
Electromechanical	80	110	140	80	110	140
Part Number	55522001	55522002	55522003	55522019	55522020	55522021
Electronic L	80L	110L	140L	80L	110L	140L
Part Number	55522004	55522005	55522006	55522022	55522023	55522024
Electronic E	80E	110E	140E	80E	110E	140E
Part Number	55522007	55522008	55522009	55522025	55522026	55522027

CC875 FASCIA

All models	55522000
------------	----------

UNPACKED DIMENSIONS and WEIGHTS

CEILING CASSETTE 875 (inc. fascia)

Model	CC 875		
	80	110	140
HEIGHT mm	314	314	314
WIDTH mm	880	880	880
DEPTH mm	967	967	967
WEIGHT kg	36	40	44

PACKED DIMENSIONS AND WEIGHTS

CEILING CASSETTE 875 Units

Model	CC 875 chassis		
	80	110	140
HEIGHT mm	385	385	385
WIDTH mm	1120	1120	1120
DEPTH mm	930	930	930
WEIGHT kg	41	45	49

CC 875 fascia
80 / 110 / 140
100
1060
1060
8

FEATURES/ACCESSORIES

INDOOR UNITS

	CC 875	CC 875 L	CC875 E
Electric heating	*	*	*
Automatic air deflection (vane motor)	*	*	*
De-ice thermostat / sensor	STD	STD	STD
2 fan speed combinations	STD	STD	STD
Remote infrared control	-	STD	STD
Remote hard wired control	STD	-	STD
0.5m lift pump	FFO	FFO	FFO
5m high condensate pump	FFO / *	FFO / *	FFO / *
Fresh air duct spigot	*	*	*
Branch duct spigot	*	*	*
Programmable timer	*	STD	STD
Long life washable filter	STD	STD	STD
BMS alarm interface	-	-	*
EMC termination kit	-	-	*
Remote temperature sensor	STD	*	*

STD = standard FFO = factory fitted option * = site option --- = not available

OPTIONAL ELECTRIC HEATING (kW)

CC 875 All Models				
240V 50Hz	1	2	3	4
230V 50Hz	0.9	1.8	2.75	3.7

AIRFLOWS

Range 2	Low (Speed 1)	Low (Speed 2)	Medium (Speed 3)	High (Speed 4)
Range 1		Medium (Speed 2)	High (Speed 3)	
CC 875	m ³ /s	m ³ /s	m ³ /s	m ³ /s
80	0.33	0.37	0.45	0.54
110	0.32	0.36	0.45	0.53
140	0.30	0.35	0.43	0.50

Technical Information R407C

	MODEL	AIR ON °C	HUMIDITY % RH	EVAPORATING TEMPERATURE °C											
				-2.5		0		2.5		5		7.5		10	
				TOTAL	SENS	TOTAL	SENS	TOTAL	SENS	TOTAL	SENS	TOTAL	SENS	TOTAL	SENS
LOW FAN SPEED	80	10	70	2.94	2.11	2.24	1.71	1.53	1.33	0.93	0.93	0.46	0.46	-	-
		12.7	70	3.79	2.50	3.10	2.11	2.38	1.35	1.62	1.35	0.97	0.97	0.50	0.50
		15	70	4.57	2.82	3.87	2.44	3.16	2.07	2.39	1.70	1.58	1.32	0.93	0.93
		18	60	5.14	3.31	4.45	2.94	3.74	2.58	2.97	2.22	2.15	1.85	1.48	1.48
		21	50	5.62	3.82	4.93	3.46	4.21	3.10	3.45	2.74	2.63	2.38	2.02	2.02
	110	10	70	3.78	2.62	2.94	2.14	2.10	1.66	1.22	1.22	0.69	0.69	-	-
		12.7	70	4.54	2.97	3.71	2.50	2.86	2.04	1.94	1.57	1.10	1.10	0.58	0.58
		15	70	5.46	3.38	4.63	2.90	3.78	2.45	2.87	1.98	1.89	1.52	1.06	1.06
		18	60	7.45	4.46	6.62	3.99	5.78	3.55	4.87	3.10	3.90	2.66	2.84	2.84
		21	50	6.70	4.54	5.88	4.07	5.03	3.62	4.13	3.18	3.15	2.72	2.30	2.30
	140	10	70	3.78	2.61	2.88	2.10	1.97	1.58	1.10	1.10	0.55	0.55	-	-
		12.7	70	4.86	3.14	3.97	2.62	3.06	2.12	2.08	1.61	1.14	1.14	0.59	0.59
		15	70	5.84	3.58	4.95	3.06	4.05	2.57	3.07	2.06	2.03	1.56	1.09	1.09
		18	60	6.55	4.18	5.67	3.66	4.78	3.18	3.81	2.67	2.77	2.18	1.72	1.72
		21	50	7.14	4.78	6.26	4.27	5.37	3.78	4.41	3.29	3.38	2.80	2.35	2.35
MEDIUM FAN SPEED	80	10	70	3.72	2.73	2.83	2.23	1.93	1.75	1.23	1.23	0.62	0.62	-	-
		12.7	70	4.80	3.21	3.91	2.74	3.01	2.27	2.04	1.80	1.30	1.30	0.68	0.68
		15	70	5.79	3.59	4.90	3.14	3.99	2.69	3.02	2.23	1.98	1.77	1.25	1.25
		18	60	6.53	4.26	5.64	3.82	4.73	3.38	3.75	2.94	2.71	2.48	1.99	1.99
		21	50	7.14	4.95	6.25	4.52	5.34	4.10	4.36	3.66	3.31	3.31	2.72	2.72
	110	10	70	4.59	3.32	3.50	2.69	2.38	2.08	1.46	1.46	0.74	0.74	-	-
		12.7	70	5.92	3.93	4.83	3.31	3.71	2.72	2.52	2.12	1.52	1.52	0.79	0.79
		15	70	7.14	4.43	6.05	3.83	4.93	3.25	3.74	2.66	2.46	2.07	1.46	1.46
		18	60	8.04	5.21	6.94	4.62	5.83	4.05	4.64	3.47	3.36	2.90	2.32	2.32
		21	50	8.77	6.00	7.69	5.42	6.58	4.86	5.38	4.30	4.10	3.73	3.18	3.18
	140	10	70	5.18	3.64	3.95	2.94	2.70	2.25	1.58	1.58	0.79	0.79	-	-
		12.7	70	6.68	4.36	5.45	3.66	4.19	2.98	2.86	2.29	1.63	1.63	0.86	0.86
		15	70	8.04	4.96	6.82	4.27	5.56	3.59	4.22	2.91	2.78	2.22	1.57	1.57
		18	60	9.04	5.82	7.82	5.12	6.57	4.47	5.23	3.80	3.80	3.13	2.49	2.49
		21	50	9.85	6.69	8.64	6.00	7.39	5.34	6.06	4.67	4.63	4.01	3.40	3.40
HIGH FAN SPEED	80	10	70	4.42	3.32	3.36	2.75	2.28	2.28	1.54	1.54	0.78	0.78	-	-
		12.7	70	5.37	3.74	4.30	3.19	3.22	2.65	2.15	2.15	1.40	1.40	0.63	0.63
		15	70	6.90	4.34	5.83	3.82	4.74	3.30	3.58	2.78	2.33	2.33	1.57	1.57
		18	60	7.78	5.18	6.71	4.69	5.62	4.18	4.46	3.67	3.25	3.25	2.50	2.50
		21	50	8.51	6.09	7.45	5.60	6.35	5.11	5.18	4.61	4.16	4.16	3.42	3.42
	110	10	70	5.69	4.19	4.34	3.43	2.95	2.70	1.90	1.90	0.96	0.96	-	-
		12.7	70	7.34	4.94	5.98	4.20	4.59	3.49	3.11	2.76	1.99	1.99	1.04	1.04
		15	70	8.86	5.54	7.50	4.83	6.10	4.14	4.62	3.43	3.02	2.71	1.92	1.92
		18	60	9.98	6.56	8.62	5.87	7.22	5.19	5.74	4.50	4.14	3.80	3.06	3.06
		21	50	10.90	7.63	9.55	6.95	8.15	6.29	6.66	5.61	5.09	5.09	4.18	4.18
	140	10	70	6.55	4.72	4.99	3.84	3.40	2.96	2.09	2.09	1.05	1.05	-	-
		12.7	70	8.44	5.59	6.89	4.74	5.30	3.88	3.59	3.02	2.17	2.17	1.14	1.14
		15	70	10.17	6.34	8.62	5.47	7.02	4.64	5.32	3.80	3.50	2.95	2.09	2.09
		18	60	11.45	7.44	9.90	6.60	8.30	5.78	6.61	4.95	4.78	4.12	3.32	3.32
		21	50	12.50	8.58	10.95	7.75	9.36	6.94	7.66	6.13	5.84	5.31	4.54	4.54

Technical Information
R134A

	MODEL	AIR ON °C	HUMIDITY % RH	EVAPORATING TEMPERATURE °C											
				-2.5		0		2.5		5		7.5		10	
				TOTAL	SENS	TOTAL	SENS	TOTAL	SENS	TOTAL	SENS	TOTAL	SENS	TOTAL	SENS
LOW FAN SPEED	80	10	70	2.97	2.13	2.26	1.72	1.54	1.33	0.93	0.93	0.46	0.46	-	-
		12.7	70	3.82	2.52	3.12	2.13	2.39	1.74	1.62	1.36	0.97	0.97	0.50	0.50
		15	70	4.62	2.84	3.90	2.46	3.18	2.08	2.40	1.70	1.58	1.33	0.93	0.93
		18	60	5.19	3.34	4.49	2.96	3.76	2.59	2.98	2.22	2.16	1.85	1.48	1.48
		21	50	5.67	3.85	4.96	3.48	4.24	3.12	3.46	2.75	2.63	2.38	2.02	2.02
	110	10	70	3.55	2.50	2.70	2.02	1.84	1.54	1.06	1.06	0.54	0.54	-	-
		12.7	70	4.58	2.99	3.73	2.50	2.86	2.04	1.94	1.57	1.10	1.10	0.58	0.58
		15	70	5.50	3.40	4.66	2.91	3.80	2.46	2.88	1.99	1.90	1.53	1.06	1.06
		18	60	6.19	3.98	5.35	3.50	4.49	3.05	3.58	2.58	2.58	2.12	1.69	1.69
		21	50	6.74	4.56	5.91	4.09	5.06	3.63	4.14	3.18	3.16	2.72	2.30	2.30
	140	10	70	3.79	2.62	2.90	2.10	1.98	1.59	1.10	1.10	0.55	0.55	-	-
		12.7	70	4.87	3.14	3.98	2.63	3.06	2.13	2.09	1.61	1.14	1.14	0.59	0.59
		15	70	5.86	3.59	4.97	3.08	4.06	2.58	3.08	2.06	2.03	1.56	1.09	1.09
		18	60	6.58	4.20	5.70	3.68	4.79	3.18	3.82	2.68	2.77	2.18	1.72	1.72
		21	50	7.16	4.79	6.29	4.29	5.38	3.78	4.42	3.30	3.38	2.80	2.34	2.34
MEDIUM FAN SPEED	80	10	70	3.77	2.75	2.86	2.25	1.94	1.76	1.24	1.24	0.62	0.62	-	-
		12.7	70	4.86	3.24	3.95	2.75	3.03	2.28	2.05	1.80	1.30	1.30	0.68	0.68
		15	70	5.86	3.63	4.95	3.17	4.02	2.70	3.03	2.24	1.98	1.77	1.25	1.25
		18	60	6.61	4.30	5.70	3.84	4.77	3.40	3.78	2.94	2.72	2.48	1.99	1.99
		21	50	7.22	5.00	6.31	4.55	5.38	4.11	4.38	3.67	3.31	3.31	2.72	2.72
	110	10	70	4.64	3.34	3.53	2.70	2.40	2.09	1.46	1.46	0.74	0.74	-	-
		12.7	70	5.98	3.96	4.87	3.34	3.74	2.74	2.54	2.13	1.52	1.52	0.79	0.79
		15	70	7.21	4.46	6.10	3.86	4.96	3.26	3.75	2.67	2.46	2.07	1.46	1.46
		18	60	8.11	5.25	7.01	4.65	5.87	4.07	4.66	3.49	3.36	2.90	2.32	2.32
		21	50	8.86	6.05	7.75	5.46	6.62	4.89	5.40	4.31	4.11	3.73	3.18	3.18
	140	10	70	5.22	3.66	3.98	2.95	2.71	2.26	1.58	1.58	0.79	0.79	-	-
		12.7	70	6.73	4.41	5.48	3.68	4.22	2.99	2.86	2.30	1.63	1.63	0.86	0.86
		15	70	8.10	4.99	6.86	4.30	5.58	3.60	4.23	2.91	2.78	2.23	1.57	1.57
		18	60	9.10	5.86	7.86	5.15	6.60	4.49	5.25	3.81	3.80	3.13	2.49	2.49
		21	50	9.92	6.73	8.69	6.02	7.43	5.35	6.08	4.68	4.64	4.02	3.40	3.40
HIGH FAN SPEED	80	10	70	4.49	3.36	3.41	2.78	2.30	2.30	1.54	1.54	0.78	0.78	-	-
		12.7	70	5.80	3.93	4.71	3.38	3.60	2.82	2.43	2.26	1.62	1.62	0.85	0.85
		15	70	6.99	4.39	5.90	3.86	4.79	3.33	3.60	2.79	2.33	2.33	1.57	1.57
		18	60	7.90	5.24	6.80	4.73	5.68	4.21	4.49	3.69	3.25	3.25	2.50	2.50
		21	50	8.63	6.14	7.54	5.64	6.42	5.14	5.22	4.62	4.16	4.16	3.42	3.42
	110	10	70	5.77	4.24	4.38	3.46	2.98	2.70	1.90	1.90	0.96	0.96	-	-
		12.7	70	7.44	4.98	6.05	4.24	4.63	3.50	3.13	2.77	1.99	1.99	1.04	1.04
		15	70	8.97	5.60	7.58	4.87	6.15	4.16	4.64	3.44	3.03	2.72	1.92	1.92
		18	60	10.11	6.62	8.72	5.92	7.29	5.22	5.77	4.52	4.15	3.81	3.06	3.06
		21	50	11.05	7.70	9.66	6.60	8.22	6.32	6.70	5.63	5.10	5.10	4.18	4.18
	140	10	70	6.62	4.76	5.03	3.86	3.42	2.98	2.09	2.09	1.05	1.05	-	-
		12.7	70	8.53	5.64	6.94	4.77	5.33	3.90	3.61	3.03	2.17	2.17	1.14	1.14
		15	70	10.27	6.39	8.69	5.51	7.07	4.66	5.34	3.81	3.50	2.95	2.09	2.09
		18	60	11.56	7.50	9.98	6.64	8.36	5.81	6.63	4.97	4.79	4.13	3.32	3.32
		21	50	12.62	8.65	11.04	7.80	9.42	6.98	7.70	6.14	5.85	5.31	4.53	4.53

Technical Information
R404A

	MODEL	AIR ON °C	HUMIDITY % RH	EVAPORATING TEMPERATURE °C											
				-2.5		0		2.5		5		7.5		10	
				TOTAL	SENS	TOTAL	SENS	TOTAL	SENS	TOTAL	SENS	TOTAL	SENS	TOTAL	SENS
LOW FAN SPEED	80	10	70	2.90	2.09	2.21	1.70	1.50	1.31	0.92	0.92	0.46	0.46	-	-
		12.7	70	3.74	2.47	3.05	2.09	2.34	1.72	1.59	1.34	0.96	0.96	0.50	0.50
		15	70	4.50	2.78	3.82	2.41	3.11	2.05	2.36	1.68	1.55	1.55	0.93	0.93
		18	60	5.08	3.27	4.39	2.91	3.69	2.56	2.93	2.20	2.12	1.83	1.47	1.47
		21	50	5.54	3.78	4.86	3.42	4.15	3.07	3.40	2.72	2.59	2.37	2.01	2.01
	110	10	70	3.50	2.46	2.66	1.99	1.82	1.52	1.06	1.06	0.54	0.54	-	-
		12.7	70	4.50	2.94	3.67	2.47	2.82	2.02	1.92	1.56	1.10	1.10	0.58	0.58
		15	70	5.42	3.34	4.59	2.87	3.74	2.43	2.84	1.98	1.87	1.51	1.06	1.06
		18	60	6.09	3.93	5.26	3.46	4.42	3.01	3.53	2.56	2.56	2.11	1.68	1.68
		21	50	6.64	4.50	5.82	4.04	4.98	3.60	4.09	3.15	3.12	2.70	2.29	2.29
	140	10	70	3.75	2.59	2.86	2.09	1.95	1.58	1.10	1.10	0.55	0.55	-	-
		12.7	70	4.82	3.12	3.94	2.61	3.04	2.11	2.06	1.60	1.14	1.14	0.59	0.59
		15	70	5.80	3.55	4.92	3.05	4.02	2.55	3.06	2.06	2.02	1.55	1.09	1.09
		18	60	6.51	4.16	5.64	3.65	4.74	3.16	3.78	2.66	2.75	2.17	1.72	1.72
		21	50	7.09	4.74	6.22	4.25	5.34	3.77	4.38	3.28	3.35	2.78	2.34	2.34
MEDIUM FAN SPEED	80	10	70	3.66	2.69	2.78	2.21	1.89	1.74	1.22	1.22	0.62	0.62	-	-
		12.7	70	4.71	3.16	3.84	2.70	2.95	2.24	2.00	1.78	1.28	1.28	0.67	0.67
		15	70	5.69	3.54	4.82	3.10	3.92	2.66	2.96	2.21	1.94	1.75	1.24	1.24
		18	60	6.42	4.20	5.54	3.77	4.64	3.34	3.69	2.90	2.66	2.46	1.97	1.97
		21	50	7.01	4.89	6.14	4.46	5.24	4.05	4.28	3.62	3.28	3.28	2.70	2.70
	110	10	70	4.53	3.28	3.45	2.66	2.35	2.06	1.45	1.45	0.73	0.73	-	-
		12.7	70	5.84	3.88	4.76	3.28	3.66	2.69	2.48	2.10	1.5	1.50	0.79	0.79
		15	70	7.03	4.37	5.96	3.78	4.86	3.22	3.68	2.64	2.42	2.06	1.46	1.46
		18	60	7.92	5.14	6.85	4.5	5.74	4.01	4.57	3.44	3.30	2.87	2.31	2.31
		21	50	8.65	5.94	7.58	5.37	6.48	4.82	5.30	4.26	4.04	3.70	3.15	3.15
	140	10	70	5.13	3.61	3.91	2.91	2.67	2.23	1.57	1.57	0.79	0.79	-	-
		12.7	70	6.61	4.32	5.39	3.62	4.15	2.96	2.82	2.27	1.62	1.62	0.85	0.85
		15	70	7.95	4.91	6.74	4.23	5.50	3.56	4.17	2.89	2.74	2.22	1.56	1.56
		18	60	8.94	5.77	7.74	5.08	6.50	4.43	5.18	3.77	3.75	3.10	2.48	2.48
		21	50	9.75	6.62	8.55	5.95	7.32	5.30	6.00	4.64	4.58	3.98	3.38	3.38
HIGH FAN SPEED	80	10	70	4.32	3.27	3.29	2.71	2.25	2.25	1.52	1.52	0.77	0.77	-	-
		12.7	70	5.58	3.82	4.55	3.29	3.49	2.77	2.36	2.23	1.60	1.60	0.84	0.84
		15	70	6.74	4.26	5.70	3.76	4.63	3.26	3.50	2.74	2.30	2.30	1.55	1.55
		18	60	7.61	5.10	6.57	4.62	5.50	4.14	4.35	3.63	3.21	3.21	2.47	2.47
		21	50	8.32	6.00	7.28	5.53	6.21	5.05	5.06	4.56	4.10	4.10	3.38	3.38
	110	10	70	5.58	4.14	4.25	3.39	2.89	2.66	1.88	1.88	0.95	0.95	-	-
		12.7	70	7.21	4.86	5.87	4.14	4.50	3.44	3.06	2.73	1.97	1.97	1.03	1.03
		15	70	8.70	5.45	7.35	4.76	5.98	4.08	4.53	3.39	2.97	2.69	1.90	1.90
		18	60	9.80	6.46	8.46	5.79	7.09	5.13	5.62	4.46	4.06	3.77	3.03	3.03
		21	50	10.70	7.53	9.38	6.86	8.0	6.22	6.54	5.55	5.04	5.04	4.14	4.14
	140	10	70	6.46	4.66	4.92	3.79	3.35	2.94	2.07	2.07	1.04	1.04	-	-
		12.7	70	8.32	5.54	6.78	4.68	5.22	3.84	3.54	2.99	2.15	2.15	1.13	1.13
		15	70	10.02	6.25	8.49	5.40	6.92	4.58	5.24	3.76	3.44	2.93	2.07	2.07
		18	60	11.28	7.35	9.75	6.52	8.18	5.72	6.50	4.90	4.70	4.09	3.30	3.30
		21	50	12.31	8.48	10.79	7.66	9.22	6.87	7.54	6.08	5.75	5.27	4.50	4.50

Technical Information R410A

	MODEL	AIR ON °C	HUMIDITY % RH	EVAPORATING TEMPERATURE °C											
				-2.5		0		2.5		5		7.5		10	
				TOTAL	SENS	TOTAL	SENS	TOTAL	SENS	TOTAL	SENS	TOTAL	SENS	TOTAL	SENS
LOW FAN SPEED	80	10	70	3.20	2.27	2.44	1.82	1.66	1.40	0.97	0.97	0.49	0.49	-	-
		12.7	70	4.13	2.70	3.37	2.26	2.60	1.85	1.77	1.42	1.01	1.01	0.53	0.53
		15	70	4.97	3.04	4.22	2.62	3.44	2.22	2.62	1.81	1.72	1.39	0.97	0.97
		18	60	5.59	3.56	4.84	3.15	4.07	2.75	3.25	2.34	2.36	1.94	1.54	1.54
		21	50	6.10	4.09	5.36	3.68	4.59	3.29	3.77	2.89	2.88	2.49	2.10	2.10
	110	10	70	3.74	2.62	2.86	2.10	1.95	1.59	1.10	1.10	0.55	0.55	-	-
		12.7	70	4.82	3.14	3.94	2.62	3.04	2.12	2.07	1.63	1.14	1.14	0.59	0.59
		15	70	5.80	3.56	4.92	3.06	4.02	2.58	3.06	2.08	2.02	1.58	1.09	1.09
		18	60	6.52	4.17	5.65	3.67	4.75	3.18	3.79	2.69	2.76	2.20	1.73	1.73
		21	50	7.10	4.78	6.23	4.26	5.34	3.78	4.39	3.30	3.36	2.82	2.35	2.35
	140	10	70	3.92	2.70	2.99	2.16	2.05	1.62	1.11	1.11	0.56	0.56	-	-
		12.7	70	5.03	3.24	4.11	2.71	3.18	2.18	2.17	1.65	1.15	1.15	0.60	0.60
		15	70	6.05	3.70	5.14	3.18	4.20	2.66	3.19	2.12	2.11	1.60	1.10	1.10
		18	60	6.79	4.32	5.88	3.78	4.95	3.27	3.96	2.74	2.88	2.22	1.74	1.73
		21	50	7.38	4.92	6.49	4.40	5.57	3.88	4.58	3.38	3.50	2.86	2.38	2.36
MEDIUM FAN SPEED	80	10	70	4.18	2.99	3.18	2.42	2.18	1.88	1.32	1.32	0.66	0.66	-	-
		12.7	70	5.39	3.53	4.40	2.98	3.38	2.46	2.30	1.93	1.38	1.38	0.72	0.72
		15	70	6.50	3.97	5.51	3.45	4.50	2.94	3.41	2.42	2.24	1.89	1.32	1.32
		18	60	7.32	4.67	6.34	4.16	5.32	3.66	4.23	3.15	3.07	2.63	2.10	2.10
		21	50	8.00	5.39	7.02	4.89	6.00	4.40	4.92	3.90	3.75	3.39	2.88	2.88
	110	10	70	5.02	3.54	3.83	2.88	2.62	2.20	1.53	1.53	0.77	0.77	-	-
		12.7	70	6.47	4.25	5.29	3.57	4.07	2.90	2.77	2.24	1.58	1.58	0.82	0.82
		15	70	7.79	4.81	6.61	4.14	5.40	3.49	4.10	2.84	2.70	2.18	1.52	1.52
		18	60	8.77	5.62	7.59	4.96	6.38	4.33	5.09	3.69	3.70	3.04	2.42	2.42
		21	50	9.57	6.45	8.39	5.80	7.19	5.18	5.90	4.54	4.50	3.90	3.30	3.30
	140	10	70	5.53	3.84	4.22	3.10	2.88	2.35	1.62	1.62	0.82	0.82	-	-
		12.7	70	7.11	4.61	5.82	3.86	4.48	3.14	3.05	2.39	1.68	1.68	0.87	0.87
		15	70	8.56	5.26	7.26	4.50	5.94	3.79	4.51	3.06	2.98	2.32	1.61	1.61
		18	60	9.62	6.14	8.33	5.41	7.01	4.70	5.59	3.98	4.06	3.25	2.55	2.55
		21	50	10.47	7.04	9.19	6.30	7.88	5.59	6.47	4.87	4.95	4.15	3.48	3.48
HIGH FAN SPEED	80	10	70	5.10	3.70	3.89	3.03	2.65	2.38	1.68	1.68	0.85	0.85	-	-
		12.7	70	6.59	4.35	5.38	3.71	4.14	3.09	2.80	2.44	1.75	1.75	0.92	0.92
		15	70	7.95	4.87	6.74	4.26	5.49	3.66	4.15	3.04	2.73	2.40	1.70	1.70
		18	60	8.97	5.77	5.35	5.18	6.50	4.59	5.17	3.98	3.74	3.37	2.70	2.70
		21	50	9.81	6.70	8.59	6.13	7.34	5.55	6.01	4.96	4.50	4.50	3.70	3.70
	110	10	70	6.42	4.62	4.90	3.74	3.34	2.90	2.03	2.03	1.02	1.02	-	-
		12.7	70	8.27	5.46	6.75	4.61	5.19	3.79	3.53	2.96	2.11	2.11	1.10	1.10
		15	70	9.98	6.14	8.46	5.33	6.90	4.53	5.22	3.72	3.44	2.90	2.04	2.04
		18	60	11.23	7.22	9.72	6.42	8.16	5.64	6.50	4.85	4.70	4.05	3.24	3.24
		21	50	12.26	8.34	10.75	7.55	9.20	6.78	7.54	6.01	5.75	5.22	4.42	4.42
	140	10	70	7.18	5.06	5.48	4.09	3.74	3.14	2.18	2.18	1.10	1.10	-	-
		12.7	70	9.25	6.06	7.55	5.10	5.82	4.15	3.95	3.20	2.26	2.26	1.18	1.18
		15	70	11.14	6.89	9.44	5.92	7.71	4.99	5.85	4.06	3.86	3.12	2.18	2.18
		18	60	12.52	8.06	10.84	7.10	9.11	6.19	7.26	5.26	5.27	4.34	3.45	3.45
		21	50	13.66	9.23	11.98	8.30	10.26	7.39	8.42	6.49	6.43	5.57	4.71	4.71

CEILING CASSETTE 875 AIR THROWS

CEILING CASSETTE 875 AIR THROWS

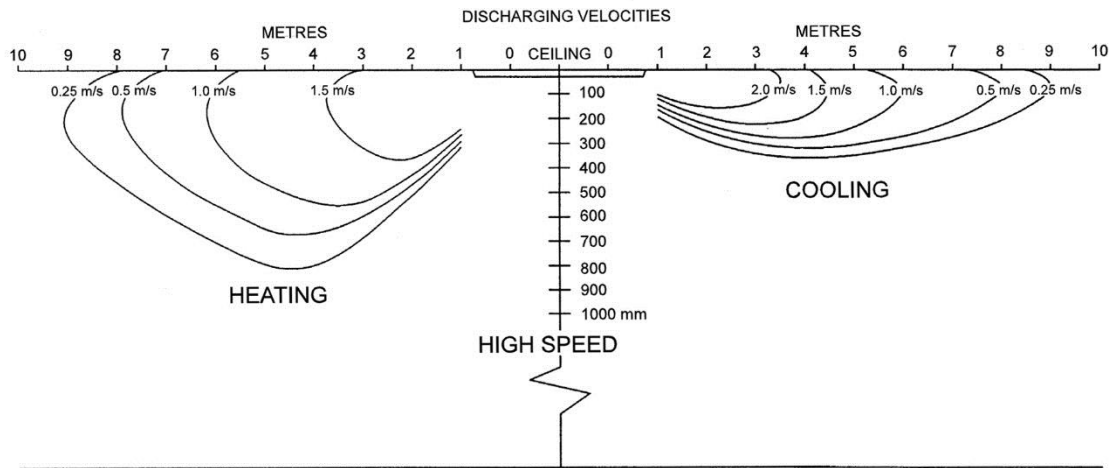

FRESH AIR SUPPLY (see page 56 for kit details)

CC 875 units are fitted with an inlet to allow the installer to provide a fresh air supply

The 100mm dia. spigot is available as kit 55200305.

The installer must provide ductwork, a screened source of fresh air and an auxiliary fan.

The auxiliary fan must be sized to overcome the resistance of the filter, the ductwork and the cassette itself. (To prevent excessive noise, the maximum fresh air volume should be less than 5% of the nominal air volume for any given unit and fan speed).

The auxiliary fan should be connected to a separate electrical circuit, appropriately fused and isolated.

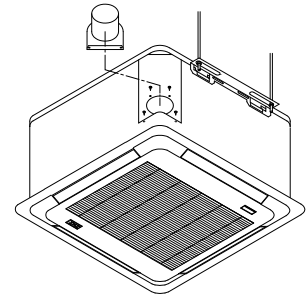

BRANCH DUCT (see page 57 for kit details)

This kit provides an air discharge into an adjacent room

The branch duct **MUST** be taken from the access point on the chassis, (kit details shown on page 57).

Ductwork should be fully insulated and supported throughout its length.

The graphs below show the airflow passed by a single branch duct: it can be seen that 3-way discharge on the unit, by blanking off the fascia side to which the branch duct has been connected, will enhance the branch airflow.

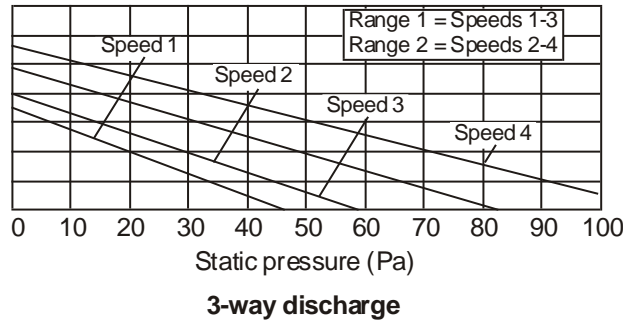
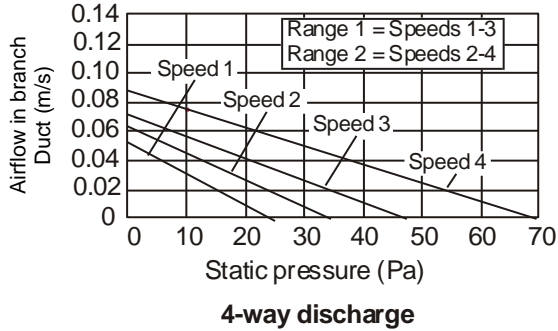

DISCHARGE BLANKING

On cool only air conditioners, and heat pump systems without boost heaters, it is possible to blank off the airflow of any one of the four sides (on latest models with kit 55500316).

This will assist applications such as L shaped rooms etc..

IMPORTANT NOTE:

On units fitted with electric heating, **DO NOT** blank off any side as this will restrict airflow over the heating elements. causing them to overheat.

1. Fit the six foam blanking pieces prior to refitting the fascia.
2. Select the side to be blocked.
3. Wedge the six foam blanking pieces into the relevant air discharge slots of the chassis ensuring that the upper surface is 50mm below the top of the outer side wall of the chassis.

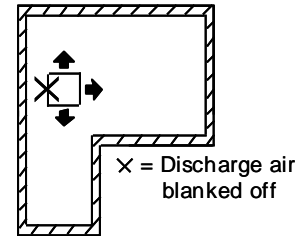

ELECTRICAL LOADS: Amps (230V 50Hz 1Ph) or A/Ph (400V 50Hz 3PhN)

CC 875	80				110				140			
Lift Pump (10watts)	9 mA				9 mA				9 mA			
Fan Motor	0.9				0.9				0.9			
Electric heater (A/C) H1 / H2 / H3 / H4	4.0	8.0	12.0	8.0+8.0	4.0	8.0	12.0	8.0+8.0	4.0	8.0	12.0	8.0+8.0
Electric heater (HP) H1 / H2 / H3 / H4	4.0	8.0	12.0	8.0+8.0	4.0	8.0	12.0	8.0+8.0	4.0	8.0	12.0	8.0+8.0

H1= 0.9 kW H2= 1.8 kW H3= 2.75 kW H4= 3.7 kW @ 230V

FUSES / DISJONCTEURS / SICHERUNGEN - HRC Type (EN60269) - MCBs (EN60898)

WHEN MATCHED WITH MARSTAIR OUTDOOR UNITS

FUSE RATING / TAILLE DES DISJONCTEURS / EMPFOHLENE SICHERUNG (A)

1Ph - 230 V (R407C, R22)

CC875										
	80 (L) (E)					110 (L) (E)				
MCU+	S	H1	H2	H3	H4	S	H1	H2	H3	H4
60	20	20	20	20	-	-	-	-	-	-
80	25	25	25	25	-	25	25	25	25	-
90	-	-	-	-	-	32	32	32	32	-
MHPUL(E)										
80	25	32	32	40	-	25	32	32	40	-
DCUE										
60	25	25	25	25	-	-	-	-	-	-
80	32	32	32	32	-	32	32	32	32	-

S = No Electric Heating / Sans Batterie Electrique / Ohne Elektroheizung

H = + Electric Heaters / + Batterie Electrique / Mit Elektroheizung

H1= 0.9 kW H2= 1.8 kW H3= 2.75 kW H4= 3.7 kW @ 230V.

FUSE RATING / TAILLE DES DISJONCTEURS / EMPFOHLENE SICHERUNG (A/Ph)

3Ph - 400 V (R407C, R22)

CC875															
	80 (L) (E)					110 (L) (E)					140 (L) (E)				
MCU+	S	H1	H2	H3	H4	S	H1	H2	H3	H4	S	H1	H2	H3	H4
60	10	10	16	16	16	-	-	-	-	-	-	-	-	-	-
80	10	10	16	16	16	10	10	16	16	16	-	-	-	-	-
90	-	-	-	-	-	16	16	16	16	16	-	-	-	-	-
100	-	-	-	-	-	16	16	16	16	16	16	16	16	16	16
130	-	-	-	-	-	-	-	-	-	-	16	16	16	16	16
150	-	-	-	-	-	-	-	-	-	-	25	25	25	25	25
MHPUL(E)															
80	10	16	20	25	20	-	-	-	-	-	-	-	-	-	-
100	-	-	-	-	-	16	20	20	25	20	-	-	-	-	-
150	-	-	-	-	-	-	-	-	-	-	25	25	32	32	32
DCUE															
60	16	16	16	16	16	-	-	-	-	-	-	-	-	-	-
80	16	16	16	16	16	16	16	16	16	16	-	-	-	-	-

S = No Electric Heating / Sans Batterie Electrique / Ohne Elektroheizung

H = + Electric Heaters / + Batterie Electrique / Mit Elektroheizung

H1= 0.9 kW H2= 1.8 kW H3= 2.75 kW H4= 3.7 kW @ 230V.

FUSE RATING / TAILLE DES DISJONCTEURS / EMPFOHLENE SICHERUNG (A)

CC875 E + MHPUE ONLY (with separate supplies to electronic indoor and outdoor units)

Provided that both indoor and outdoor units are electronic ('E') and control cables between them are data cables, the units may be independently supplied and fused.

CC875	S	H1	H2	H3	H4
80E	5	10	16	16	16
110E	5	10	16	16	16
140E	5	10	16	16	16

UNIT SIZE	60	80	100	150
DCUE 1Ph	25	32	-	-
MHPUE 1Ph	-	20	-	-
DCUE 3Ph	16	16	-	-
MHPUE 3Ph	-	10	16	20

S = No Electric Heating / Sans Batterie Electrique / Ohne Elektroheizung

H = + Electric Heaters / + Batterie Electrique / Mit Elektroheizung

H1= 0.9 kW H2= 1.8 kW H3= 2.75 kW H4= 3.7 kW @ 230V.

SOUND POWER and SOUND PRESSURE LEVELS

(speed 1 = lowest, 4 = highest: Range 1 = speeds 1,2,3: Range 2 = speeds 2, 3, 4)

MODEL	SPEED	SOUND POWER LEVELS							SOUND PRESSURE LEVELS	
		Frequency Hz						dBA	dBA	NC
		125	250	500	1K	2K	4K			
80	1	56.4	56.2	53.9	54.9	45.1	34.6	57	39	35
	2	59.1	58.7	56.0	57.0	49.5	39.2	60	42	38
	3	63.4	62.4	59.3	59.5	54.2	45.6	63	45	40
	4	66.1	65.5	62.9	62.5	57.8	50.8	66	48	43
110	1	60.6	58.2	55.7	56.2	46.1	35.8	59	41	35
	2	63.1	60.5	57.8	58.4	50.6	40.3	61	43	38
	3	66.3	63.7	60.8	60.8	55.2	46.4	64	46	40
	4	68.8	67.1	64.5	63.9	59.1	52.6	68	50	43
140	1	64.7	60.2	57.5	57.4	47.1	36.9	60	42	38
	2	67.1	62.3	59.5	59.7	51.7	41.4	63	45	40
	3	69.2	64.9	62.2	62.0	56.2	47.1	65	47	43
	4	71.5	68.6	66.1	65.2	60.3	54.4	69	51	46

Sound Power Levels were obtained in conformance with ISO 3745. Values are shown in dB with a standard reference of 1 pW.
 Sound Pressure Levels are dB relative to $2 \times 10^{-5} \text{N/m}^2$ and are calculated from results measured in anechoic conditions.
 Values relate to a position of 3m away from the centre line of the unit, 1m down.

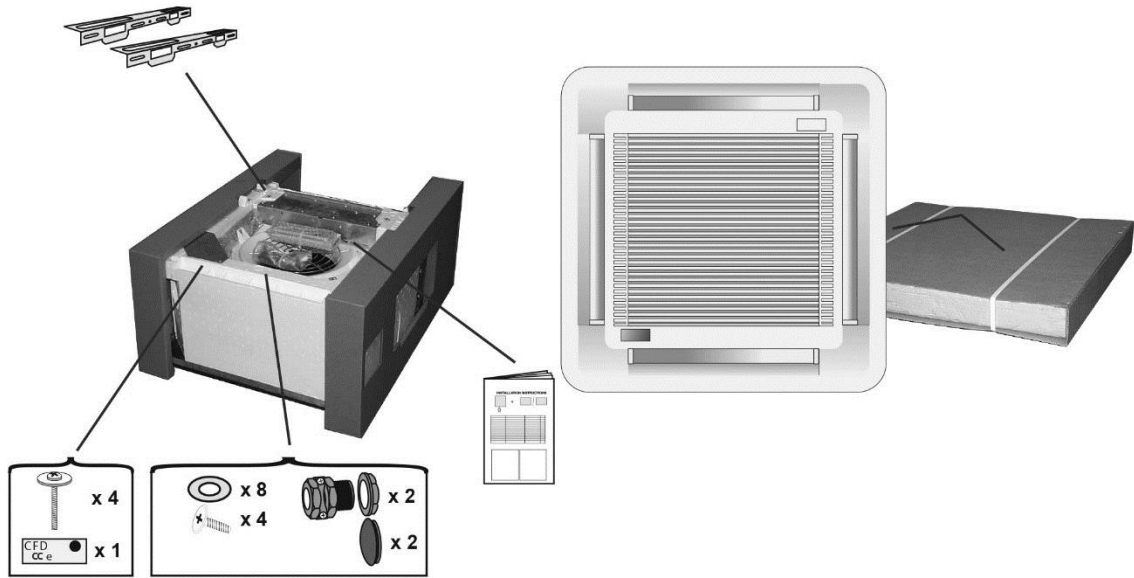

OPTIONS - (Fit any of these kits before installing the unit: some may also be factory fitted)

OPTIONS - (A monter avant d'installer l'unité)

ZUBEHÖR - (Alle Bausätze einbauen bevor das Gerät montiert wird: viele sind auch werkseingebaut lieferbar)

875 / 875L / 875E	
55500305 VANE MOTOR KIT KIT MOTEUR DE VOILETS LUFTLAMELLENMOTOR	
55500311 / 312 / 313 / 314 1 / 2 / 3 / 4 kW ELECTRIC HEATER KIT KIT BATTERIE ELECTRIQUE 1 / 2 / 3 / 4 kW 1 / 2 / 3 / 4 kW ELEKTROHEIZUNGBAUSATZ	
55500303 CONDENSATE PUMP (5m HEAD) POMPE CONDENSATS (5m) KONDENSATPUMPE (5m)	
55500304 ADJACENT ROOM SPIGOT PIQUAGE DERIVATION NEBENRAUMANSCHLUSS	
55200305 FRESH AIR SPIGOT PIQUAGE AIR NEUF FRISCHLUFTANSCHLUSS	
55500316 FOAM BLANKING KIT SCHAUMSTOFF ABDECKUNG	

875	
97200212 RCC30 RETURN AIR TEMPERATURE SENSOR RCC30 RÜCKLUFTFÜHLER	
55200151 PROGRAMMABLE TIMER HORLOGE PROGRAMMABLE ZEITSCHALTUHR PROGRAMMIERBAR	
875E	
53800423 BMS ALARM INTERFACE	
55200301 EMC TERMINATION GLAND	
00526077 CABLE (FOR HANDSET) KABEL (FÜR FERNBEDIENUNG)	
53800402 WALL TEMPERATURE SENSOR LUFTTEMPERATURFERNFÜHLER	

DIMENSIONS & WEIGHTS / DIMENSIONS ET POIDS / ABMESSUNGEN & GEWICHTE

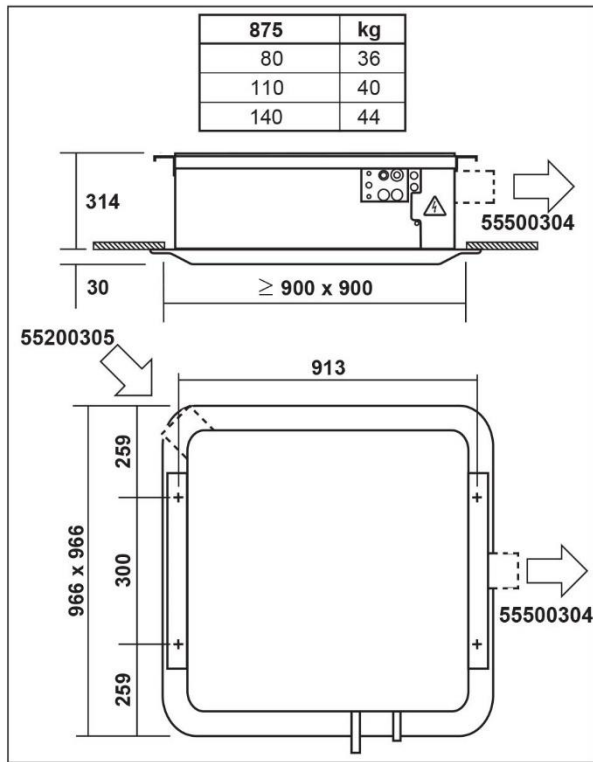

REMOVAL OF CHASSIS / D...POSE DU CHASSIS / ABBAU DES GEHÄUSES

FOR EASIER ACCESS (SOLID CEILINGS)
 POUR UN MONTAGE FACILE AU PLAFOND
 FÜR BESSERE ZUGFÄHIGKEIT (ABGEHÄNGTE DECKEN)

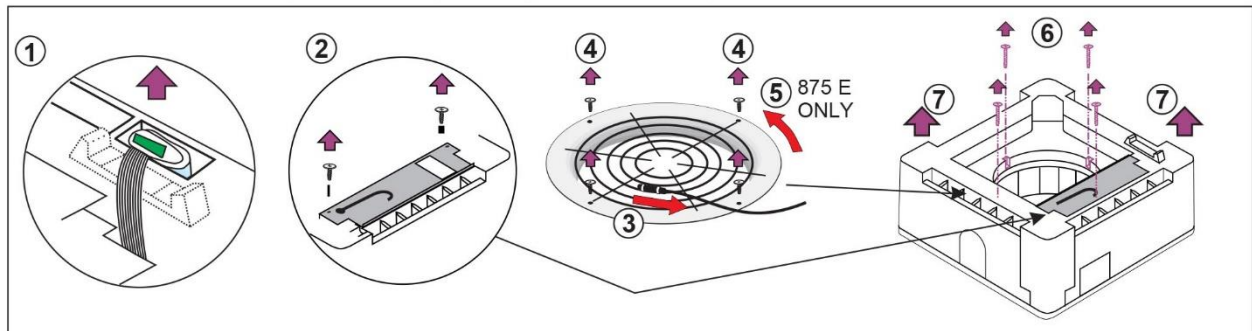

INSTALLATION / MONTAGE

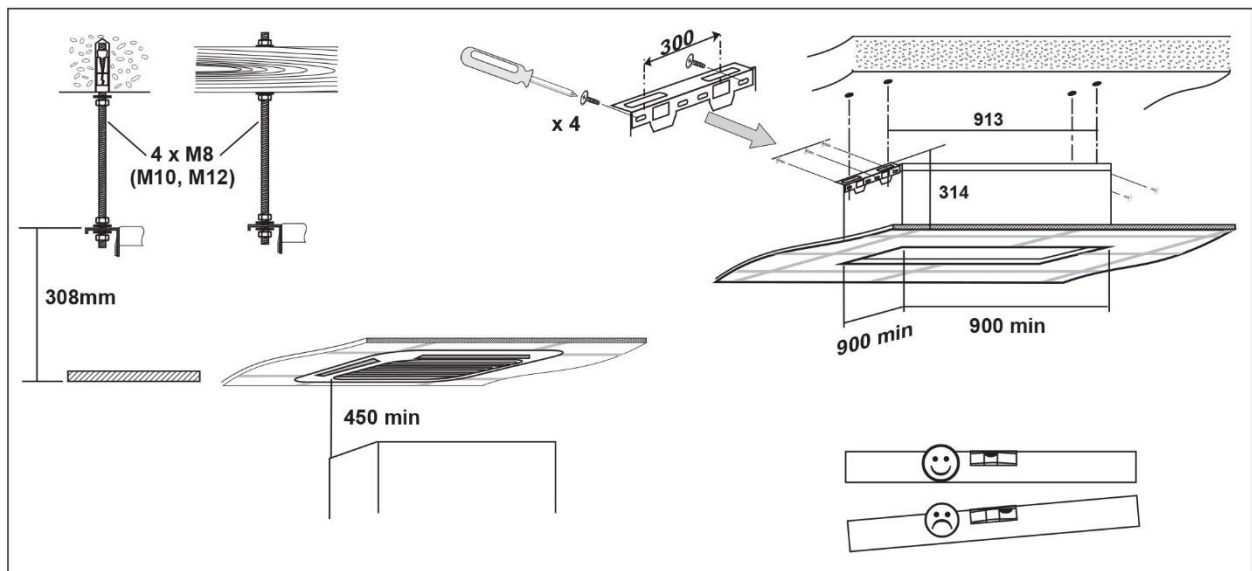

REFRIGERATION PIPEWORK / TUYAUTERIES / ROHRLEITUNGEN

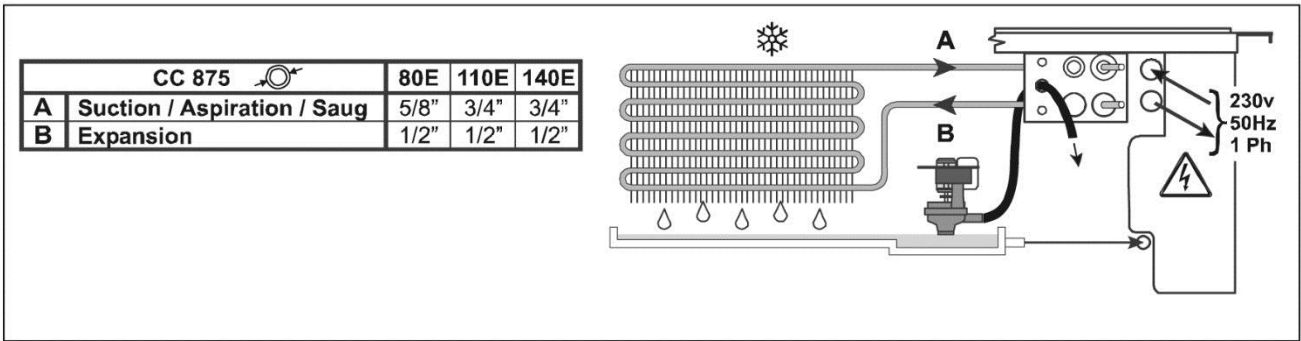

RESTRICTORS

Marstair outdoor units (cool only & heat pumps) are supplied with expansion assemblies and cooling restrictors fitted.

MCU+	15	20	30	40	45	50	60	80	90	100	130	150	165	180	200
Restrictor	0.033	0.033	0.040	0.044	0.046	0.050	0.052	0.057	0.063	0.068	0.071	0.080	0.082		N/A

HEAT PUMP HEATING

All heat pump units have an additional expansion assembly supplied loose inside the unit. This is to be fitted to some indoor units for heating. Fit the assembly within 10m of the indoor unit in the expansion line.
 Note: The refrigerant flow is from indoor to outdoor, opposite to cooling assembly. Placing it directly at the indoor coil may cause increased noise during the heating cycle. No separate check valve is needed. The expansion assembly and line must be fully insulated.

Note: The indoor units below are fitted with heating capillaries.

CC875/80H, CC875/110H, CC875/140H

The additional heating expansion assembly (supplied loose in the heat pump unit) is not required.

Retain as a spare.

PIPEWORK CONNECTION / RACCORDMENT DES TUYAUTERIES / ROHRLEITUNGEN

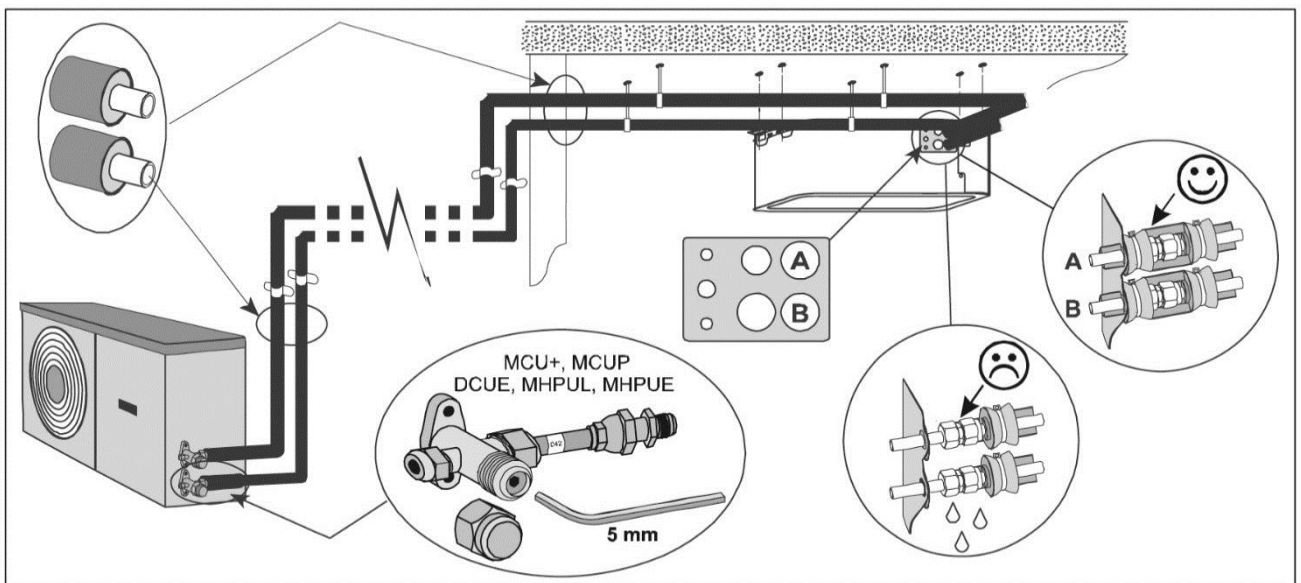

CONDENSATE DRAIN PIPING / EVACUATION CONDENSATS / KONDENSWASSERLEITUNG

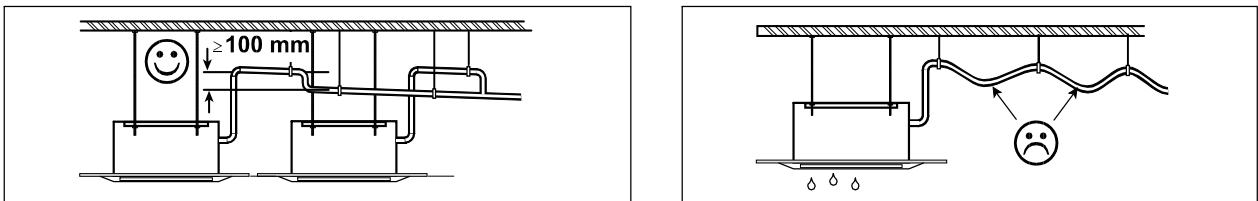
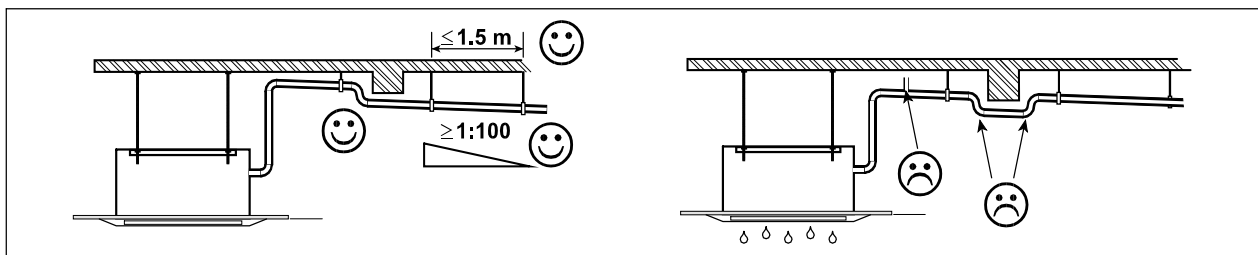
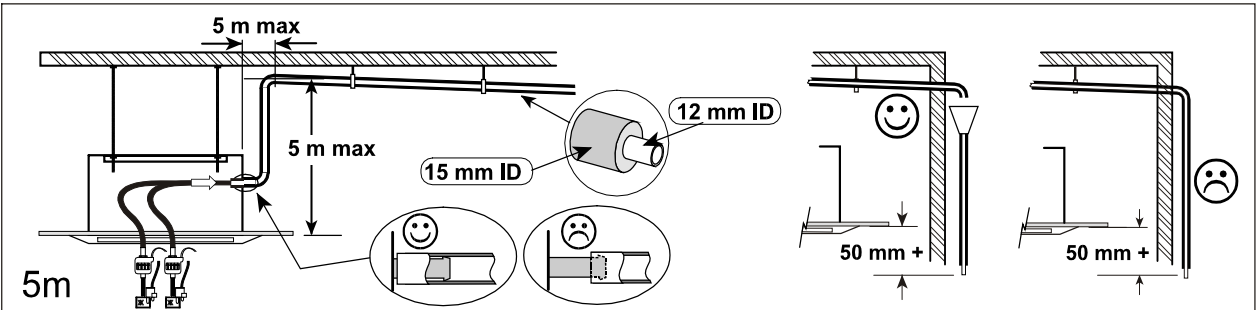
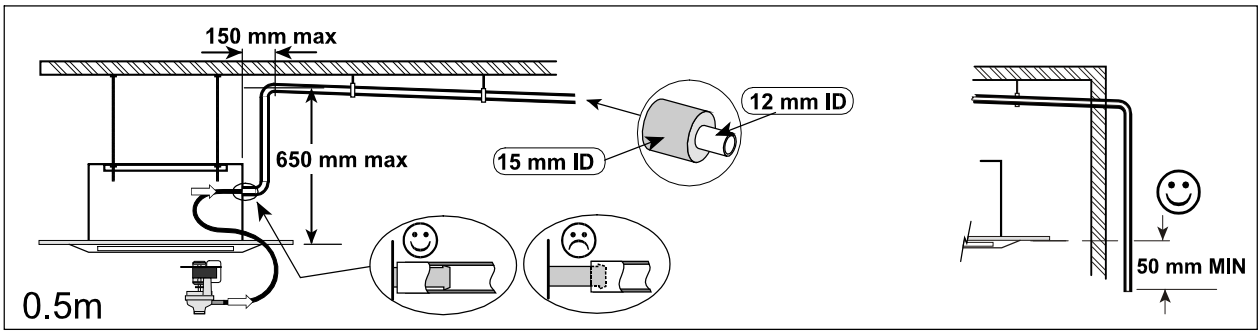

TESTING

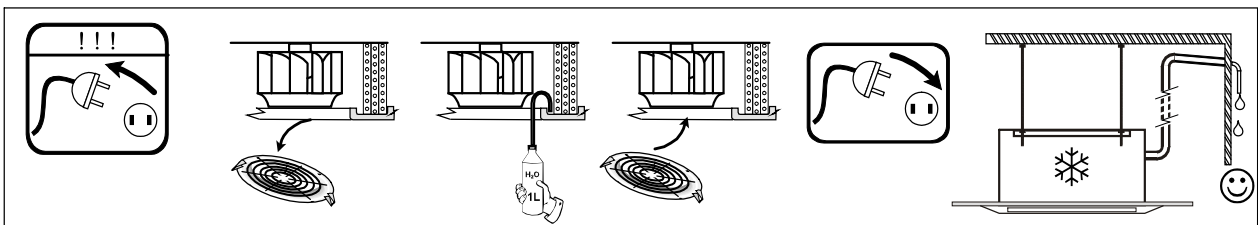

REINSTALLING THE CHASSIS / REPOSE DU CHÂSSIS / GEHÄUSEEINBAU

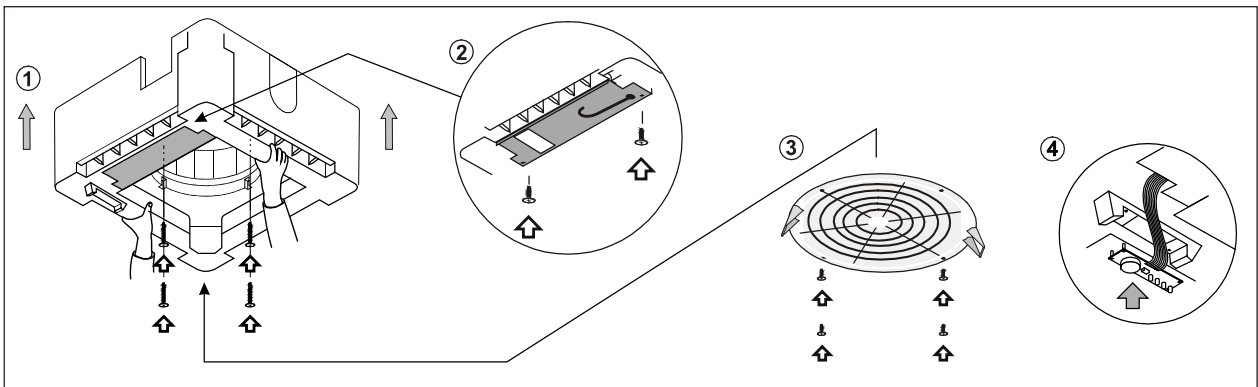

AIR OUTLET BLANKING - KIT 55500316
OBTURATION D'UN CÔTÉ DE SOUFLAGE - KIT 55500316
ABSPERRUNG DES LUFTAUSLASSES - KIT 55500316

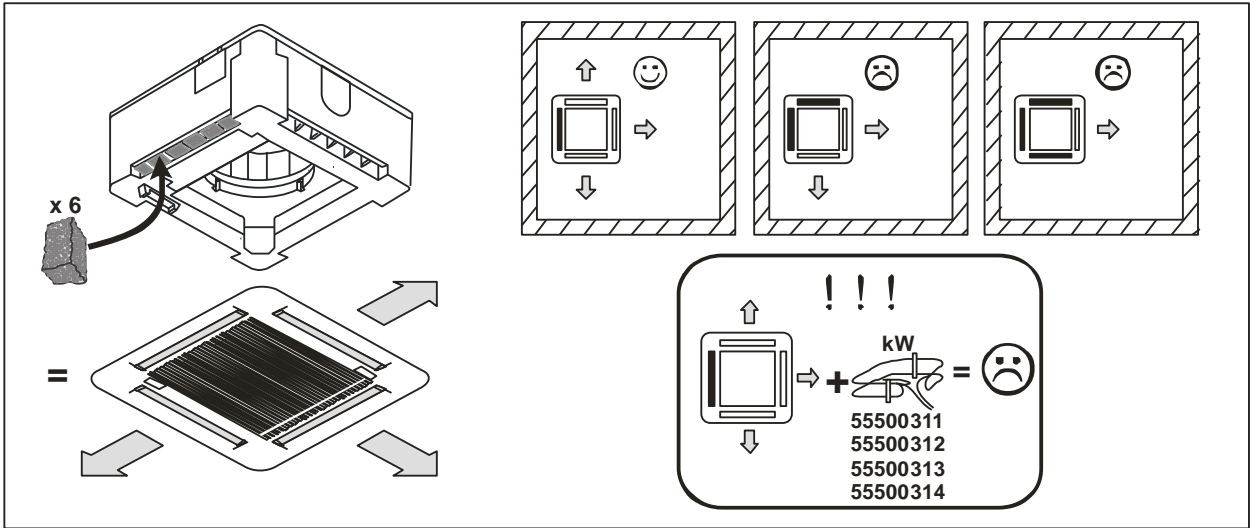

REINSTALLING THE CHASSIS / REPOSE DU CHÂSSIS / GEHÄUSEEINBAU

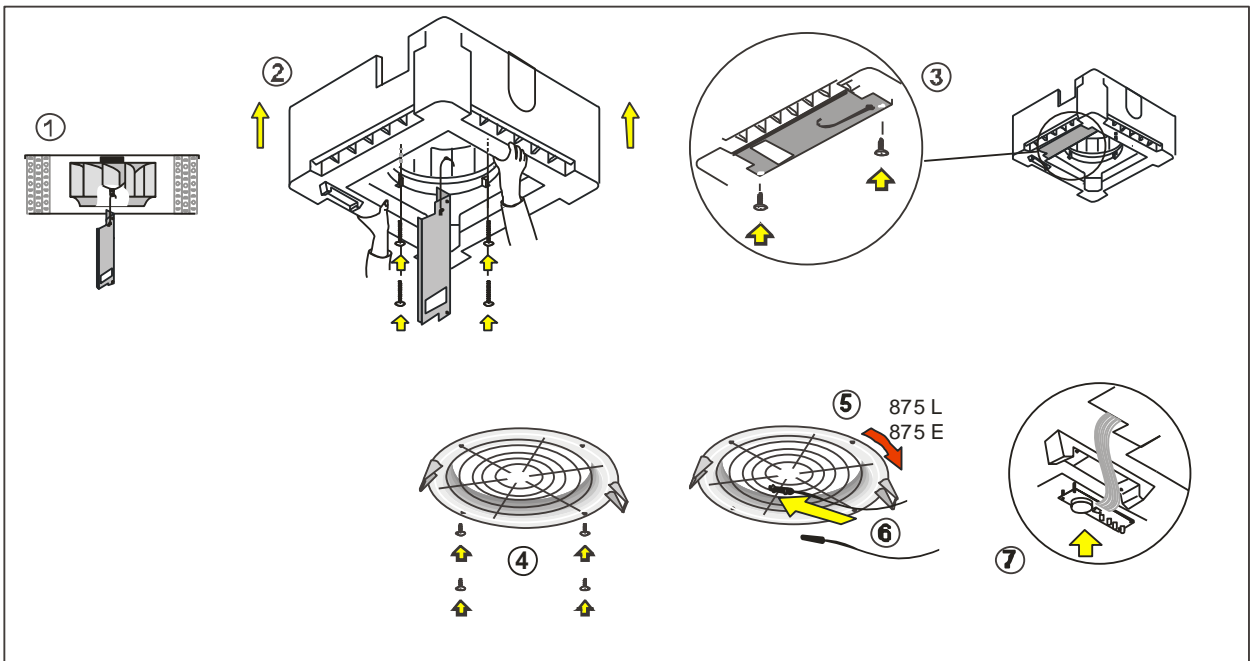

FITTING THE FASCIA / FIXATION DU PLENUM / BLENDMONTAGE

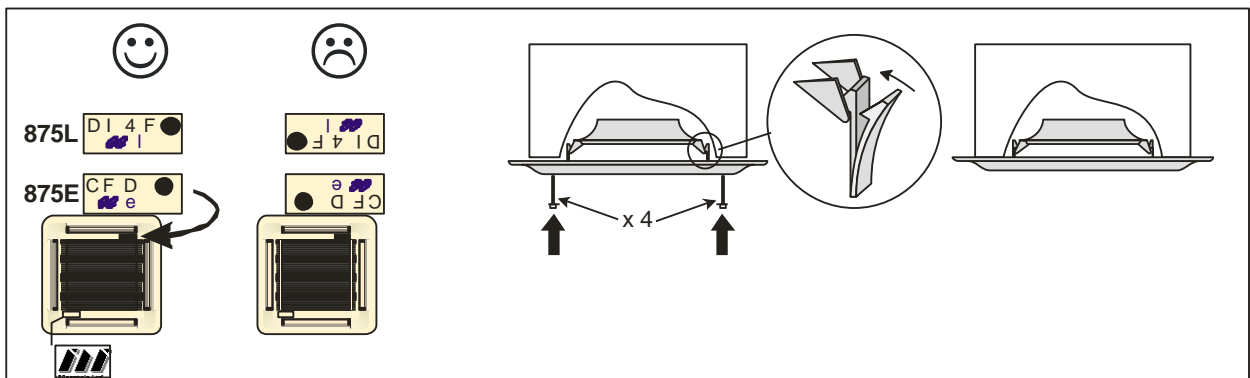

PIPE CONNECTIONS

Pipework is terminated with flare nut connectors, adjacent to the access panel. Units are supplied with the following male flare connections (sizes in inches):-

Model Size	CC875		
	80	110	140
Suction	5/8	3/4	3/4
Expansion	1/2	1/2	1/2

Indoor units have a low pressure holding charge of nitrogen, which may be released into the atmosphere without damage to the environment. This should be done prior to making pipework connections.

ELECTRICAL SUPPLY

1. Mains, control and interconnecting cables must be supplied and fitted by the installer. Follow local and national wiring regulations.
2. Cables must be size compatible with the recommended system fuse size.
3. Position an isolator switch within easy reach of the indoor unit.
4. Ensure the equipment is earthed.
5. Access to the terminal rail is gained by removing the electrics box cover in the corner of the unit next to the condensate drain (see adjacent photo).

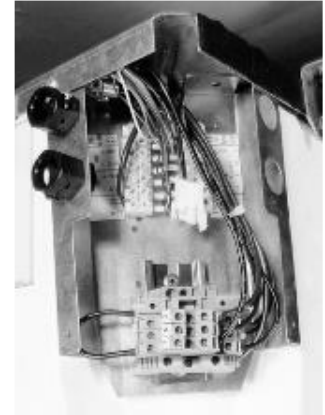

INTERCONNECTING WIRING

Interconnecting wiring diagrams are shown on pages 38 to 40.

875E SYSTEMS: An EMC gland kit (part number 55200301) **MUST** be used if the system is:-

Hard wired to a handset (1 data cable)
Fitted with a remote temperature sensor (1 data cable)

A heat pump (1 data cable)
BMS controlled (2 data cables)
Networked (2 data cables)

One termination gland can be used for up to 3 cables. Each cable is four core screened cable, available from TEV in 100m rolls, part number 00526077.

Details of the kit are on page 59.

875E MATCHED WITH EITHER MHPUE, OR DCUE

It is recommended that these systems should have a supply taken to the outdoor / ducted unit **AND** a separate supply taken to the indoor unit, which in many cases can be from a domestic 13/16 Amp socket (see fuse tables page 10). Communication cables should be screened 2 core (max. 0.75mm²) non polarised, grounded at both ends using the clamps provided.

DO NOT use coaxial or mineral insulated cables.

ALL OTHER SYSTEMS:

Cables should be run to the outdoor unit with interconnecting cables run back to the indoor unit.

FAN SPEED RANGE SELECTION / SÉLECTION DES VITESSES DE VENTILATION / LÜFTERSTUFENAUSWAHL

m ³ /s	D	C	B	A
CC 875 - 80	0.53	0.45	0.36	0.32
CC 875 - 110	0.52	0.44	0.36	0.32
CC 875 - 140	0.50	0.43	0.35	0.30

875 DC FAN SPEED SELECTION

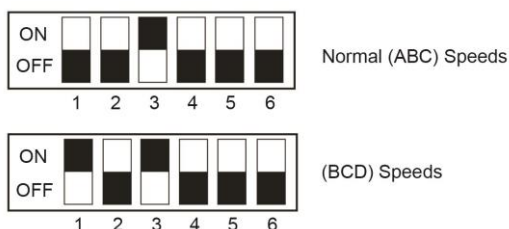

875 AC FAN SPEED SELECTION

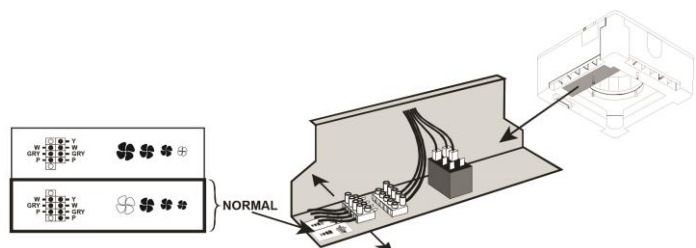

CC875L + MHPUL

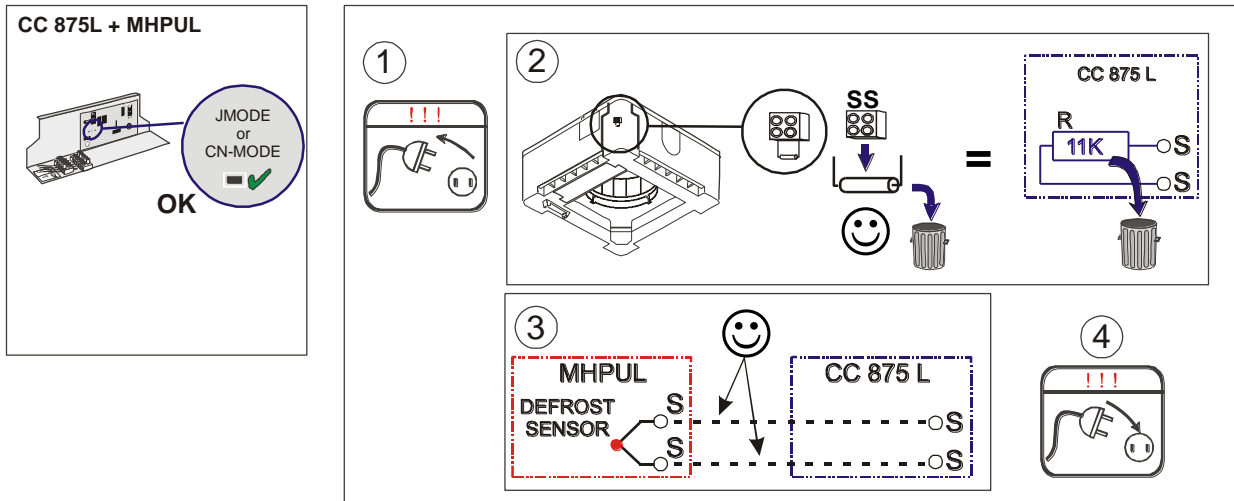

CC 875L MCU+ / MCUP / DCUE

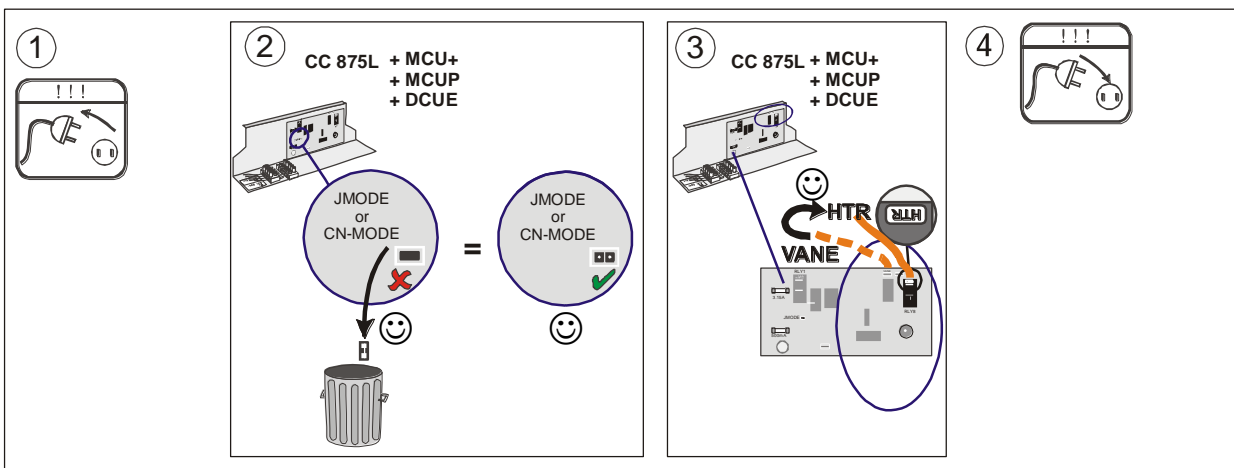

OUTDOOR UNIT WIRING

Cable entry for the outdoor unit electrics is through the cabinet to a terminal block.

Outdoor unit fan motors have a single speed and are ready for use at all outdoor temperatures.

MCU condensing units are suitable for temperate climates. If continuous running is expected at ambient temperatures of 15°C or lower, a head pressure control kit is recommended.

MCU+, MHPUE, DCUE and DHPUE fan motors are supplied wired via a head pressure controller to give maximum control.

Ensure all connections are secure and that both units are earthed.

3 Ph COMPRESSOR ROTATION

On 3 Ph units it is possible for the compressor to run backwards. This becomes obvious on start up: the compressor will not develop a normal running pressure differential and the top will not become warm. It may be excessively noisy. To reverse the rotation, switch off the mains power, identify the phase supplying the indoor unit, and exchange the other two incoming supply phases.

DATA PLATES

Because of the ability to mix-match indoor and outdoor units, the data plate only gives information on outdoor units. To obtain the system details, input power and currents from indoor and outdoor units should be added together. Data plates show basic units with electric heater kit loads shown separately.

FIRE LINK

Electromechanical models In order to automatically switch off the fan in the event of a fire, fit an external switch (240V, 3A, closed to run, volt free contact) between terminal block terminal 2 and the Marstair remote control thermostat terminal 2 (L). This switch should be operated by the building's fire alarm or BMS system. See page 38

Electronic models: □L□ units: see page 39; □E□ units see page 40.

+R407C ? / +POE ? (g)

Add extra refrigerant and polyolester (POE) oil to systems as shown below . Figures assume pipe sizes as shown on page 14.

Ajouter du réfrigérant et de l'huile polyolester (POE) selon le tableau ci-dessous. Les tableaux sont basés sur le respect des diamètres de tuyauteries montrés page 14.

Zusätzliches Kältemittel und Öl Polyolester (POE) wie unten angegeben dem System zufügen. Die Abbildungen nehmen Leitungsgrößen wie auf Seite 14 gezeigt an.

>8m	Expansion Ø	3/8"	1/2"	5/8"	3/4"
	+R407C (g/m)	16	30	48	68

+R407C

		LENGTH OF EXPANSION LINE (m) / LONGUEUR DE LA LIGNE EXPANSION (m) / LANGE DER EXPANSIONSLEITUNG (m)														
CC 875	MCU+	< = 8	15	20	25	30	35	40	45	50	55	60	65	70	75	80
	MCUP, DCUE	R407C	R407C	R407C	R407C	R407C	R407C	R407C	R407C	R407C	R407C	R407C	R407C	R407C	R407C	R407C
80	60	0	200	350	500	650	800	950	1750	2000	2250	2450	2700	2950	3150	3400
80	80	0	200	350	500	650	1300	1500	1750	2000	2250	2450	2700	2950	3150	3400
110	80	180	400	550	700	850	1450	1700	1950	2150	2400	2650	2850	3100	3350	3600
110	90	440	650	800	1250	1500	1750	1950	2200	2450	2650	2900	4350	4700	5050	5400
110	100	170	400	750	1000	1200	1450	1700	1950	2150	3400	3750	4100	4450	4750	5100
140	100	0	220	600	800	1050	1300	1500	1750	2000	3250	3600	3900	4250	4600	4950
140	130	180	550	750	1000	1250	1450	1700	2750	3100	3400	3750	4100	4450	4800	5150
140	150	0	350	600	800	1050	1900	2200	2550	2900	3250	3600	3900	4250	6300	6800

CC 875L(E)	MHPUL(E)	R407C	R407C	R407C	R407C	R407C	R407C	R407C	R407C	R407C	R407C	R407C	R407C	R407C	R407C	R407C
80	80	520	750	900	1050	1200	1800	2050	2300	2500	2750	3000	3200	3450	3700	3900
110	100 (UK)	320	550	900	1150	1350	1600	1850	2100	2300	3550	3900	4250	4600	4900	5250
110	100 (NEMA)	420	650	1000	1250	1450	1700	1950	2200	2400	3650	4000	4350	4700	5000	5350
140	150	0	350	600	800	1050	1850	2200	2550	2900	3250	3600	3900	4250	6300	6800

+POE OIL

		LENGTH OF EXPANSION LINE (m) / LONGUEUR DE LA LIGNE EXPANSION (m) / LANGE DER EXPANSIONSLEITUNG (m)														
CC 875	MCU+	< = 8	15	20	25	30	35	40	45	50	55	60	65	70	75	80
	MCUP, DCUE	POE	POE	POE	POE	POE	POE	POE	POE	POE	POE	POE	POE	POE	POE	POE
80	60	0	0	50	50	50	50	50	150	150	150	200	200	200	250	250
80	80	0	0	50	50	50	100	100	150	150	150	200	200	200	250	250
110	80	0	50	50	50	50	100	100	150	150	150	200	200	200	250	250
110	90	50	50	50	100	100	100	150	150	150	200	200	300	350	350	400
110	100	0	50	50	50	100	100	100	150	150	250	250	300	300	350	350
140	100	0	0	50	50	100	100	100	150	150	250	250	300	300	350	350
140	130	0	50	50	50	100	100	100	200	200	250	250	300	300	350	350
140	150	0	50	50	50	100	150	150	200	200	250	250	300	300	450	500

CC 875L(E)	MHPUL(E)	POE	POE	POE	POE	POE	POE	POE	POE	POE	POE	POE	POE	POE	POE	POE
80	80	50	50	50	50	100	150	150	150	200	200	200	250	250	250	300
110	100	0	50	50	100	100	100	150	150	150	250	300	300	350	350	400
140	150	0	50	50	50	100	150	150	200	200	250	250	300	300	450	500

CC 875 INSTALLATION CHECK LIST		Page	Checked
1	Is the unit square and level with the ceiling ?	13	
2	Is the correct restrictor(s) fitted ?	14	
3	Are refrigerant pipes the correct diameters for the pipe run ? (also see outdoor unit)	14	
4	Is the pipework correctly supported throughout its length ?	14	
5	Is the expansion and suction pipework insulated right up to the unit ?	14	
6	Have all pipework joints been carefully checked for leaks ?	-	
7	Is the refrigerant charge / oil addition correct ?	26	
8	If applicable, has the blue wire on HPC 55000487 been returned to terminal 4 ?	25	
9	If the outdoor unit is a DCUE or MHPUE, has link JP6 been removed ?	25	
10	CC875 L pcb : if the outdoor unit is an MCU+ or DCUE, has link JMODE been removed?	22	
11	Is the fuse size correct ?	10	
12	Is the interconnecting wiring correct ?	38-40	
13	Is the selected fan speed appropriate for the application ?	21	
14	Does the system respond correctly to commands from the controller ?	41-47	
15	Is the condensate drain correctly sized, connected, supported and insulated ?	15	
16	Has the effectiveness of condensate removal system been tested and there are no leaks ?	15	
17	Is the air distribution as required?	16	
18	Have you fitted kit 55500316 if 3-way air discharge is required ?	16	
19	Is the IR reciver correctly fitted?	15	

CHECK LIST DE L'INSTALLATION DE CC 875		Page	Véifié
1	L'unité est-elle fixée de niveau ?	13	
2	Avez-vous monté les bons numéros de buse pour le système ?	14	
3	Avez-vous passé les bons diamètres de tuyauteries ?	14	
4	Les tuyauteries sont-elles correctement fixées ?	14	
5	Avez-vous isolé les tuyauteries jusqu'au châssis de l'unité ?	14	
6	Avez-vous effectué une recherche de fuites ?	-	
7	La charge de réfrigérant et d'huile est-elle correcte ?	26	
8	Si approprié, le fil bleu doit revenir a la borne 4 sur la carte HPC 55000487 ?	25	
9	Si l'unité extérieure est un DCUE ou MHPUE, avez-vous retiré le schunt JP6 ?	25	
10	CC875 L pcb: si l'unité extérieure est un MCU+ ou DCUE, avez-vous retiré le schunt JMODE?	22	
11	La taille du disjoncteur est-elle correcte ?	10	
12	Les câblages d'interconnexions sont-ils corrects ?	38-40	
13	Avez-vous sélectionné les vitesses de ventilation approprié ?	21	
14	Le système répond-t-il correctement à la télécommande ?	41-47	
15	L'évacuation des condensats est-elle correctement raccordée, supportée et isolée ?	15	
16	Avez-vous vérifié le bon fonctionnement de l'évacuation des condensats et qu'il n'y a pas de fuites ?	15	
17	La distribution d'air est-elle correcte ?	16	
18	Désirez vous un soufflage sur 3 côtés ? Kit 55500316	16	
19	La carte infra rouge réceptive est-elle bien installée?	15	

CC 875 MONTAGE PRÜFLISTE		Seite	Geprüft
1	Ist das Gerät waagrecht und eben eingebaut ?	13	
2	Ist die richtige Düse für das System eingebaut ?	14	
3	Sind die richtigen Rohrleitungsgrößen verlegt worden ? (siehe auch Aussengerät)	14	
4	Sind alle Rohrleitungen über deren gesamte Länge richtig befestigt ?	14	
5	Sind beide Leitungen bis zum Gerätegehäuse isoliert worden ?	14	
6	Sind alle Rohrleitungen und Verbindungen auf Leckagen untersucht worden ?	-	
7	Ist die Kältemittel und Ölfüllung richtig ?	26	
8	Falls das Aussengerät der Typ MCUP ist, ist der blaue Draht zurück an Klemme 4 angeschlossen worden ?	25	
9	Falls das Aussengerät ein DCUE oder MHPUE, ist, ist die Brücke JP6 entfernt worden ?	25	
10	CC875 L pcb: Falls das Aussengerät ein MCUP oder MHPUL ist, sind die Brücke JMODE entfernt worden?	22	
11	Ist die Sicherungsgröße richtig ?	10	
12	Ist die Verbindungsverdrahtung richtig ?	38-40	
13	Ist die richtige Lüfterdrehzahl eingestellt worden ?	21	
14	Nimmt das System die Befehle des Reglers an ?	41-47	
15	Ist die Tauwasserleitung richtig angeschlossen, aufgehängt und isoliert ?	15	
16	Prüfen Sie nach, ob daß Kondenswasser richtig abfließen kann und keine Leckstellen vorhanden sind ?	15	
17	Ist die Luftverteilung wie gewünscht ?	16	
18	3 Wege Ausblas? Bausatz 55500316	16	
19	Ist die Infrarotempfängerplattine richtig montiert?	15	

CC875 WIRING DIAGRAM

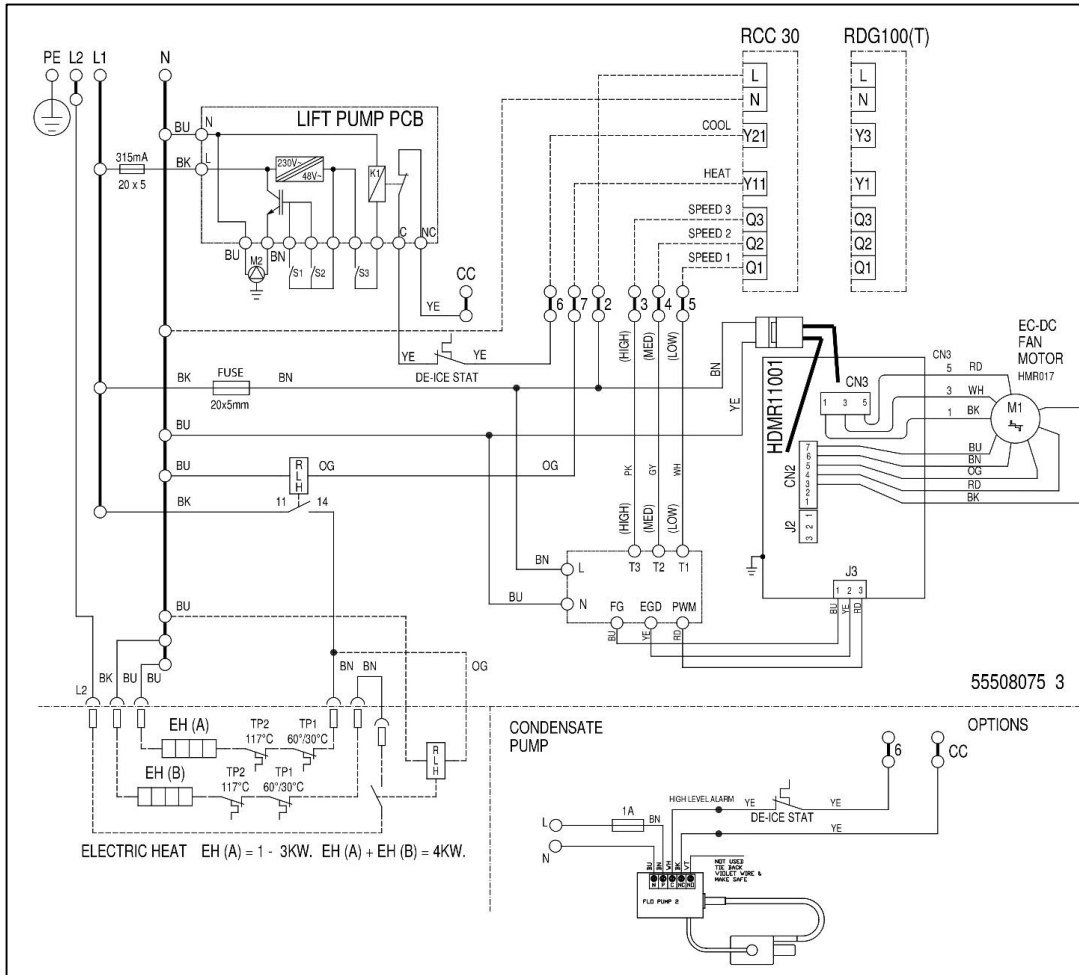

BN	BROWN
BK	BLACK
BU	BLUE
GN	GREEN
GY	GREY
OG	ORANGE
PK	PINK
RD	RED
TQ	TURQUOISE
VT	VIOLET
WH	WHITE
YE	YELLOW
AC	AIR CONDITIONER
C	CAPACITOR
CC	CONTROL CIRCUIT
EH	ELECTRIC HEATER
-->	INSTALLER SUPPLIED
IRHW	INFRA RED (WIRED)
REC	INFRA RED (RECEIVER)
F	FUSE
H	HEAT/HEATER
HP	HEAT PUMP
JP	JUMPER / PLUG
L	LIVE
M1	FAN MOTOR
M2	PUMP
M3	VANE MOTOR
N	NEUTRAL
PCB1	CONDENSATE CONTROL
PE	PROTECTIVE EARTH
RL	RELAY
RT	REMOTE THERMOSTAT
RV	REVERSING VALVE
S1	CONDENSATE SENSOR
TP1	THERMAL PROTECTOR
TP2	THERMAL FUSE

BN	MARRON
BK	NOIR
BU	BLEU
GN	VERT
GY	GRIS
OG	ORANGE
PK	ROSE
RD	ROUGE
TQ	TURQUOISE
VT	VIOLET
WH	BLANC
YE	JAUNE
AC	CLIMATISEUR
C	CAPACITÉ
CC	CIRCUIT DE COMMANDE
EH	CHAUFFAGE ELECTRIQUE
-->	NON FOURNI
IRHW	INFRAROUGE (CABLE)
REC	INFRAROUGE (RECEVEUR)
F	FUSIBLE
H	CHAUD / CHAUFFAGE
HP	POMPE A CHALEUR
JP	PLUG
L	PHASE
M1	MOTEUR DE VENTILATEUR
M2	POMPE
M3	MOTEUR DE VOLET
N	NEUTRE
PCB1	COMMANDE DES CONDENSATS
PE	MISE À LA TERRE
RL	RELAIS
RT	THERMOSTAT A DISTANCE
RV	VANNE DE REVERSION
S1	SONDE DES CONDENSATS
TP1	RELAIS THERMIQUE
TP2	FUSIBLE THERMIQUE

BN	BRAUN
BK	SCHWARZ
BU	BLAU
GN	GRUN
GY	GRAU
OG	ORANGE
PK	ROSA
RD	ROT
TQ	TUERKIS
VT	VIOLET
WH	WEIS
YE	GELB
AC	KLIMA ANLAGE
C	KONDENSATOR
CC	REGEL KREIS
EH	ELEKTROHEIZUNG
-->	BAUSEITS
IRHW	INFRAROT (VEHRDRAHET)
REC	INFRAROT (EMPFANGER)
F	SICHERUNG
H	HEIZUNG
HP	WARMEPUMPENAVLAGE
JP	KURTZSCHLUßBRÜCKE
L	PHASE
M1	LUFTER MOTOR
M2	PUMPEN
M3	LUFTKLAPPENMOTOR
N	NEUTRALLEITER
PCB1	KONDENSAT PUMPREGLER
PE	SCHUTZLEITER
RL	RELAIS
RT	FERNBEDIENUNG
RV	UMKEHRVENTL
S1	KONDENSATFÜHLER
TP1	UBERHITZUNGSSCHUTZ
TP2	UBERHITZUNGSSICHERUNG

CC875 L WIRING DIAGRAM

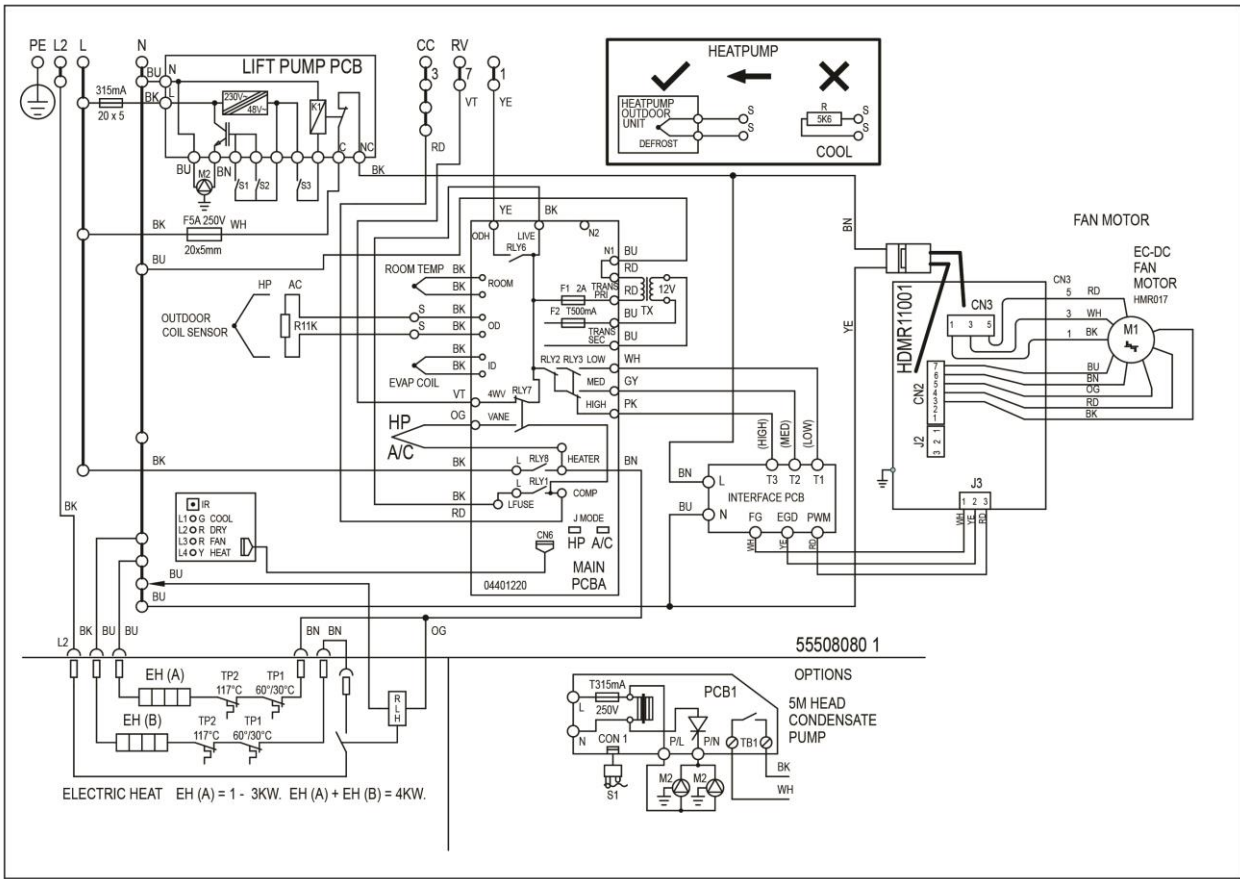

CC875 E WIRING DIAGRAM

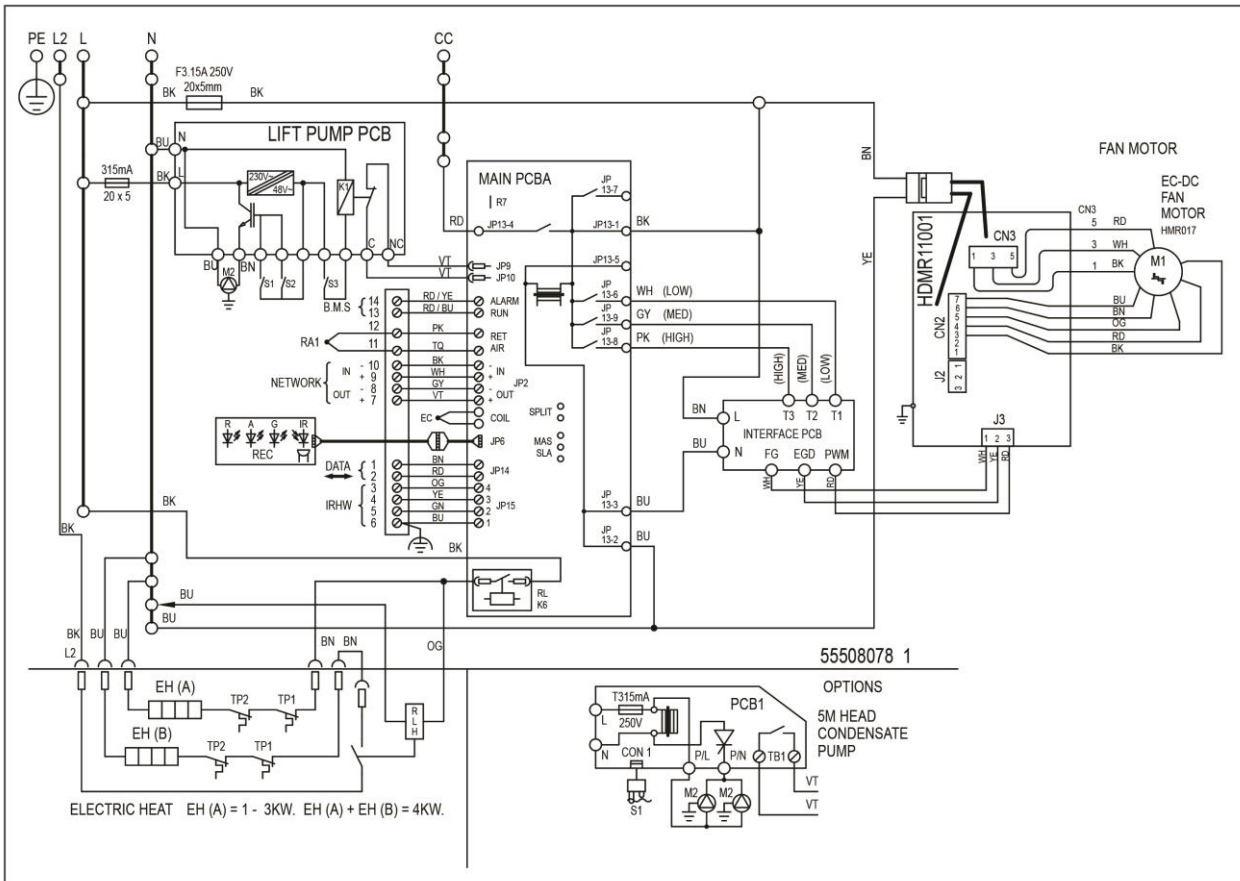

INTERCONNECTING WIRING / INTERCONNEXIONS / VERBINDUNGSVERDRÄHTUNG

CC875

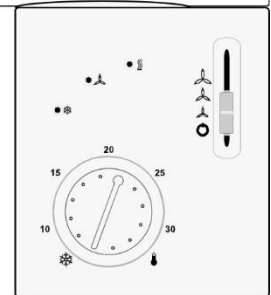
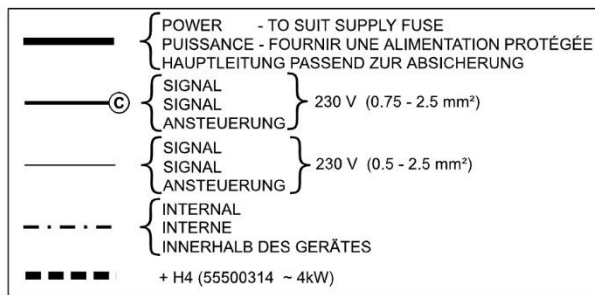
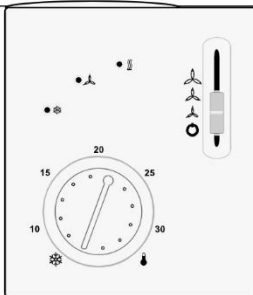
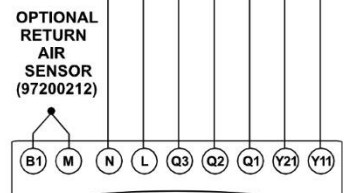
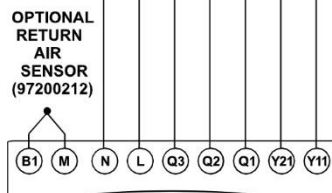
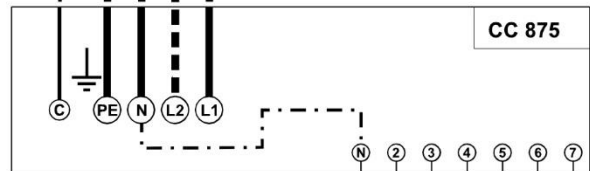
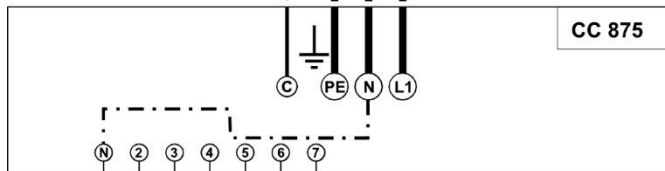
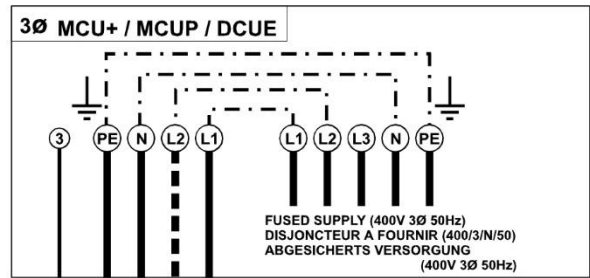
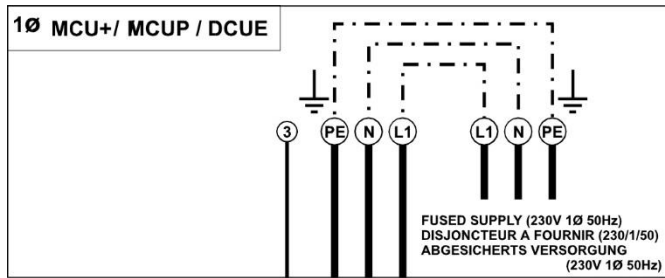

RCC 30 97200211

RCC 30 97200211

WAGO TERMINALS

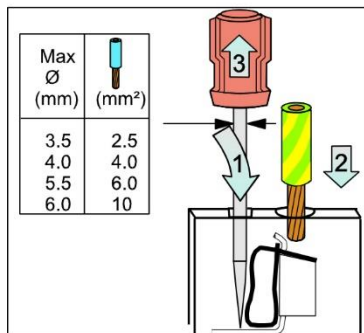

FIRE LINK

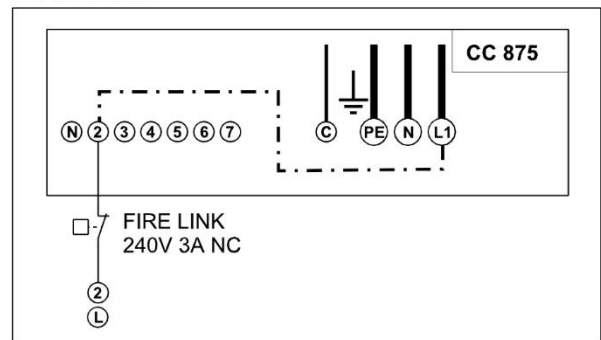

INTERCONNECTING WIRING / INTERCONNEXIONS / VERBINDUNGSVERDRÄHTUNG

CC875 L

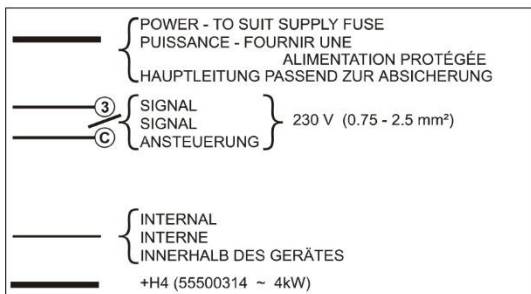
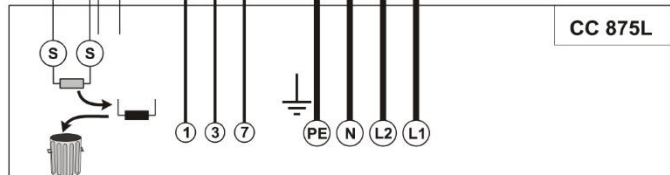
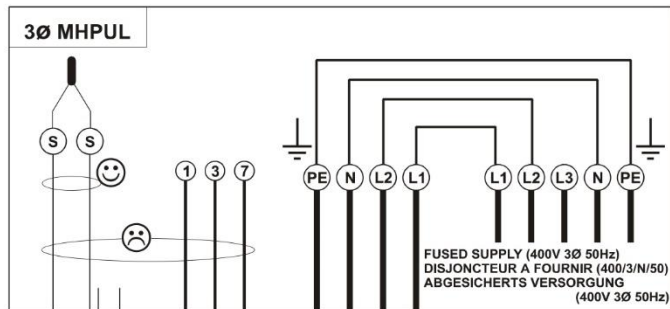
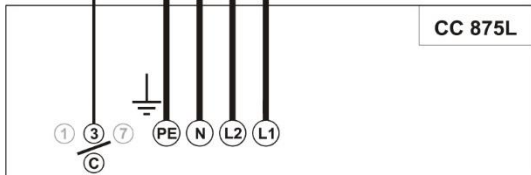
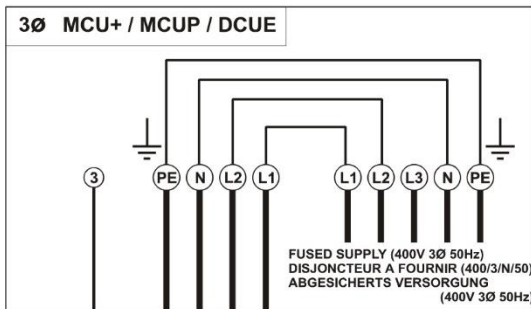
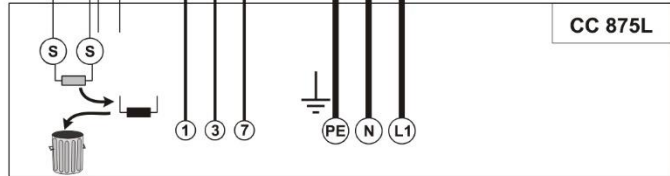
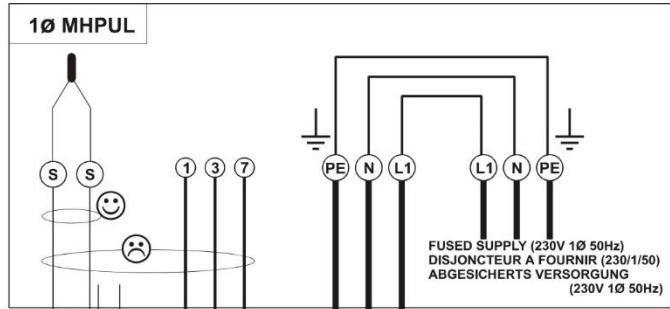
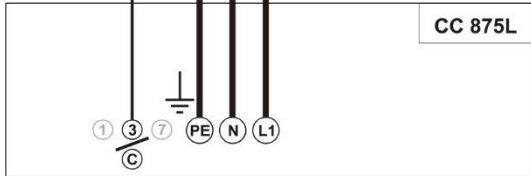
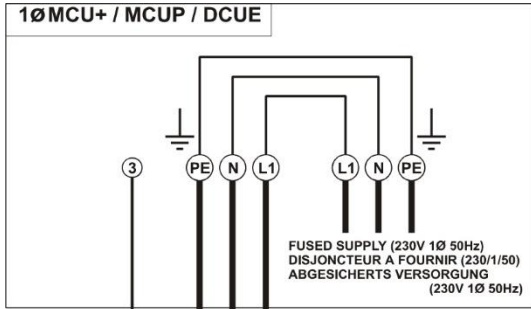

WAGO TERMINALS MHPUL

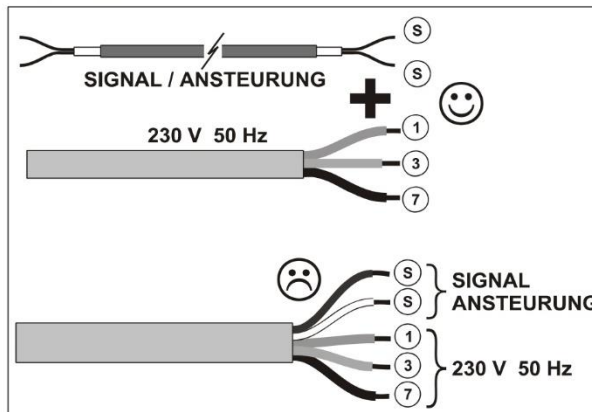
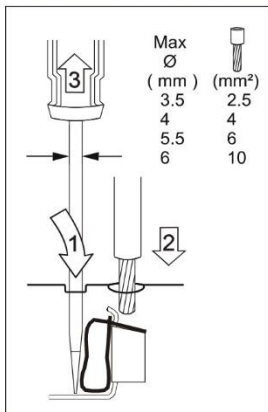

FIRE LINK

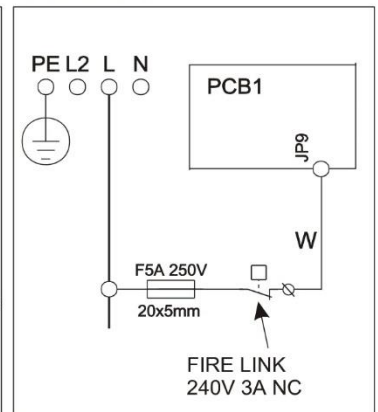

INTERCONNECTING WIRING / INTERCONNEXIONS / VERBINDUNGSVERDRÄHTUNG

CC875 E

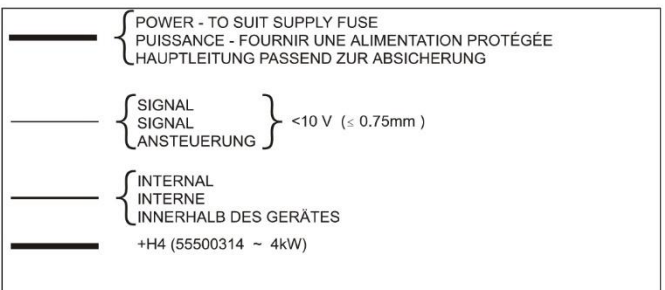
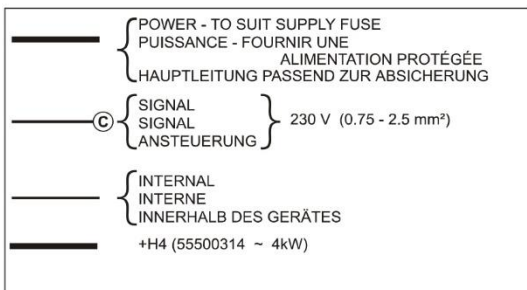
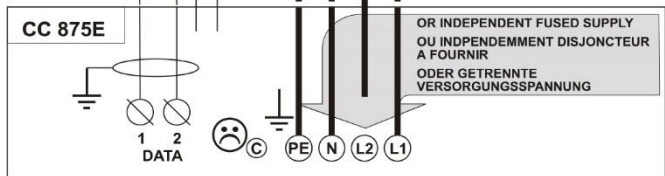
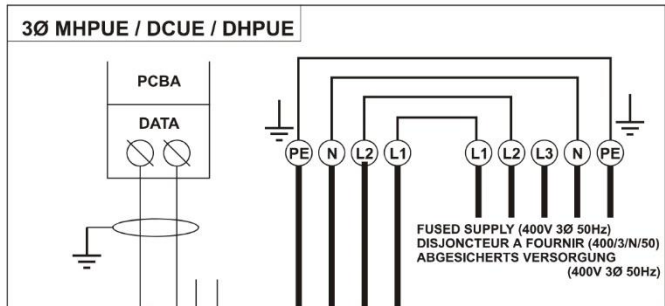
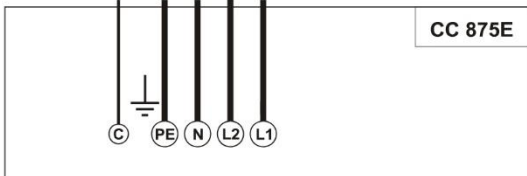
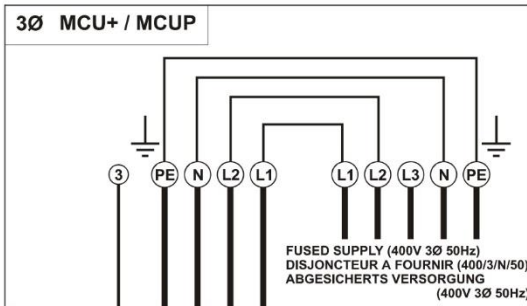
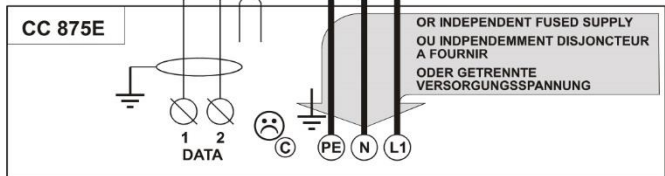
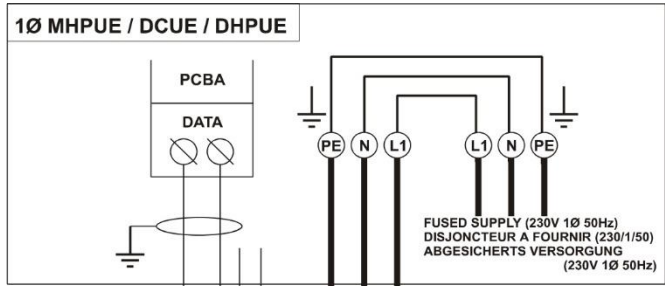
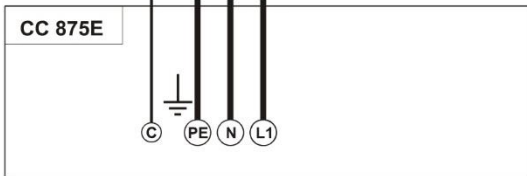
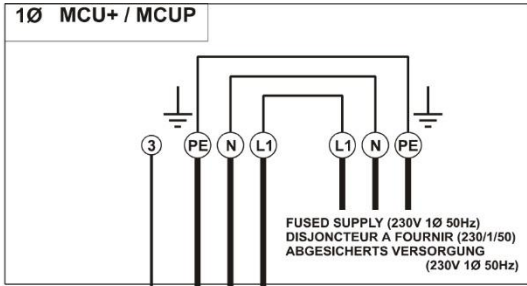

WAGO TERMINALS

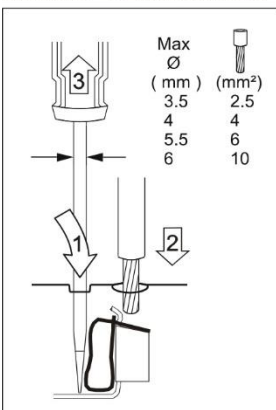

MHPUE / DCUE / DHPUE

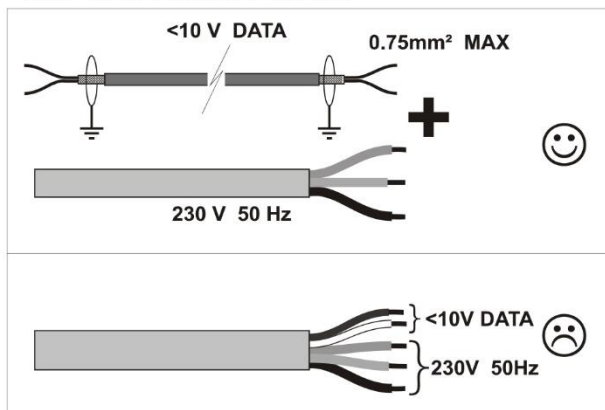

FIRE LINK

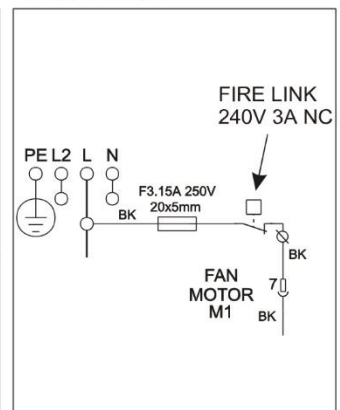

CC875 ELECTROMECHANICAL REMOTE CONTROLLER OPERATING INSTRUCTIONS

97200211 (RCC 30 ELECTRONIC)

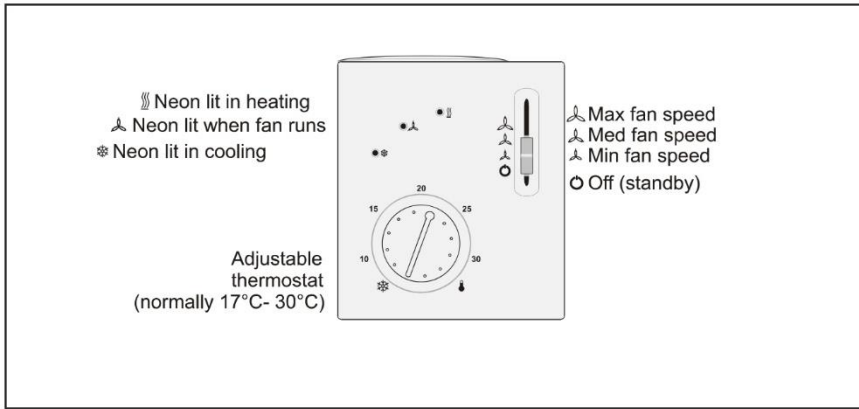

RCC30 THERMOSTAT

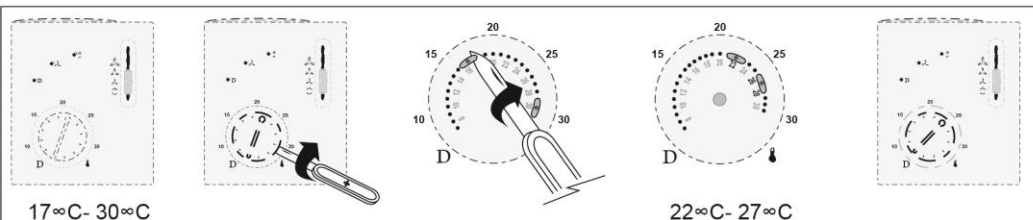
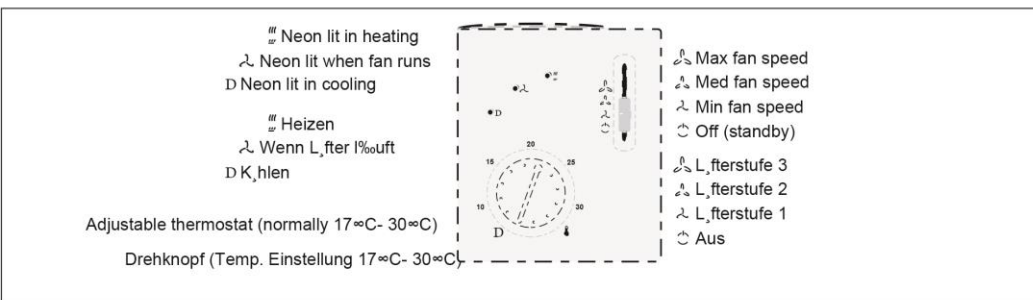
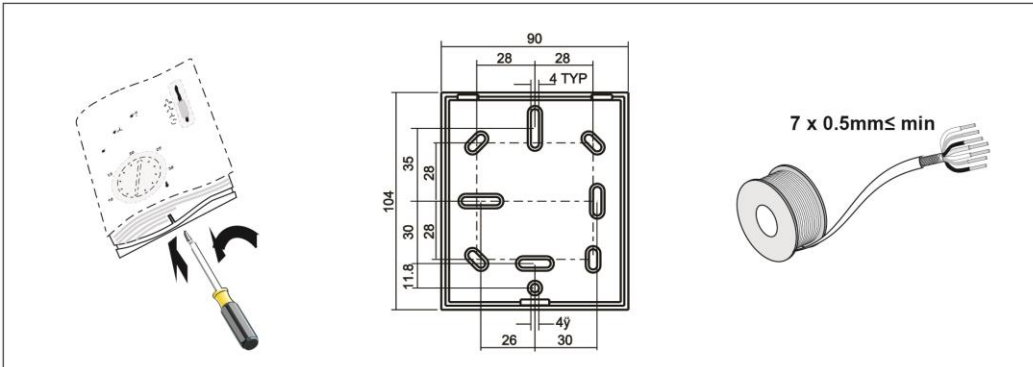
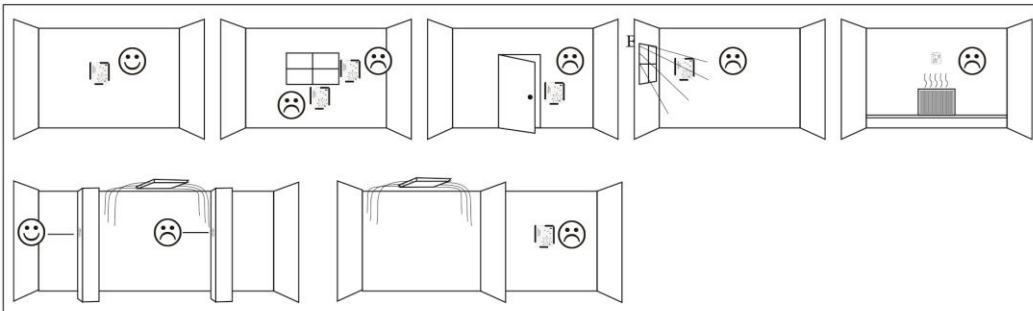

97200212	
Remote room sensor	
Sonde de reprise	
Rückluftfühler	
RCC 30	
CWC(H) 875	

Neutral	L/ve					
Tension d'alimentation 230V~						
Betriebsspannung 230V~						
				Max	Med	Min
N	L	Y11	Y21	Q3	Q2	Q1
N	2	7	6	3	4	5

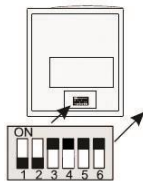

=Factory setting
 =Réglage d'usine
 =Werkeinstellung

ON	Fan control is temperature dependent in all operating modes	Changeover between normal operation and energy saving mode	Changeover activated when contact of switch is closed (NO)	Frost protection disabled	1K In heating mode, 0.5K in cooling mode	2K
OFF	Fan control in normal operation is temperature independent	Changeover between normal operation and standby	Changeover activated when contact of switch is opened (NC)	Frost protection enabled	4K In heating mode, 2K in cooling mode	5K
FUNCTION	Fan control	Operating mode changeover via external switch	Action of switch for externally-operated mode changeover	Standby	Switching differential	Dead zone in normal operation
MARCHE	La commande du ventilateur est dépend de la température dans tout les régimes	Commutation entre régime normal et régime d'économie	Commutation activée lorsque le contact est fermé (NO= normalement ouvert)	Contrôle antigel desactive	1K en régime chauffage, 0.5K en régime refroidissement	2K
ARRRET	En régime normal, la commande du ventilateur est indépendante de la température	Commutation entre régime normal et état de veille	Commutation activée lorsque le contact est ouvert (NC= normalement fermé)	Contrôle antigel active	4K en régime chauffage, 2K en régime refroidissement	5K
SIGNIFI-CATION	Commande de ventilateur	Commutation du régime via un contact externe	Sens d'action du contact pour la commutation externe du régime	Etat de veille	Différentiel	Zone neutre en régime normal
ON	Die Ventilatorsteuerung ist in allen Betriebsarten temperaturabhängig	Umschaltung zwischen Normaltrieb und Energiesparbetrieb	Umschaltung aktiviert wenn Kontakt geschlossen (NO=normal offen)	Frostschutz-funktion gesperrt	1K im Heizbetrieb, 0.5K im Kühlbetrieb	2K
OFF	Die Ventilatorsteuerung ist im Normaltrieb temperaturunabhängig	Umschaltung zwischen Normaltrieb und Betriebsbereitschaft	Umschaltung aktiviert wenn Kontakt offen (NO=normal geschlossen)	Frostschutz-funktion freigeben	4K im Heizbetrieb, 2K im Kühlbetrieb	5K
BEDEUTUNG	Ventilator-steuerung	Betriebsarten-Umschaltung über einen externen Kontakt	Wirksinn des Kontaktes für die externe Betriebsarten-Umschaltung	Betriebs-berettschaft	Schaltdifferenz	Totzone im Normal-betrieb
	1	2	3	4	5	6

CC 875 L REMOTE CONTROLLER.

CC 875 L indoor units are supplied with a remote controller, wall mounting bracket and two batteries.

The controller operates remotely by infrared signals and the bracket may be used to park the controller for convenience.

Slide open the front cover: press down on the top at the marked area and push off the cover. Insert the batteries ensuring correct polarity. The display will blank and reset. Replace the cover by sliding into position.

Operating instructions are on page 42.

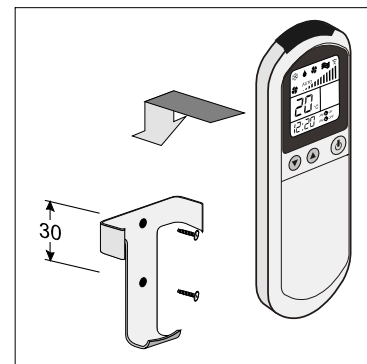
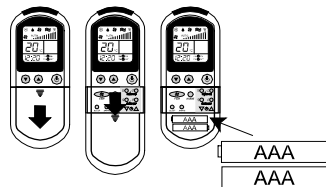

875E REMOTE CONTROLLER.

875E units are supplied with a remote controller, wall mounting bracket, PP3 (9 volt) battery, screws and wall plugs.

The controller operates either remotely by infrared signals, when the wall mounting bracket may be used to park the controller for convenience, or may be hard wired to the unit (via the wall mounting bracket) in applications where infrared is inappropriate, e.g., high lighting level, no direct line of sight etc..

1. Preparation

Open the battery cover at the bottom rear of the controller by sliding out and hinging up, push the polarised connector onto the battery, slot into the controller and close the cover. The controller is now ready for operation as shown on page 44.

For convenience, the wall mounting bracket may be secured to a wall and used to park the controller.

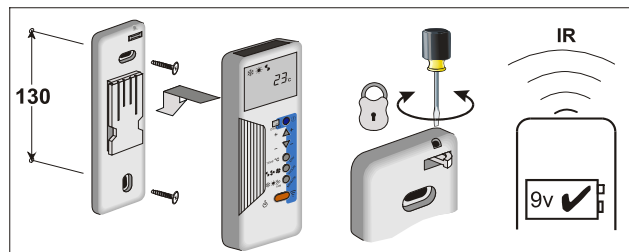

2. Hard wired

Use four core screened cable (available from TEV in 100m drums, part number 00526077). The screen should be clamped to ground in the 875E unit but **NOT** connected at the wall bracket end.

NOTE: Great care should be taken to ensure that the wiring is correct, refer to the diagram and table below.

The cable should be connected prior to mounting the bracket, taking great care to ensure that the 4 contact blades remain free to exert spring pressure on the handset terminals.

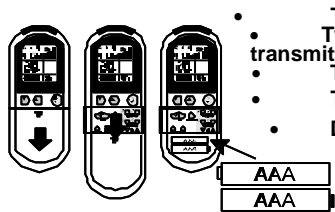
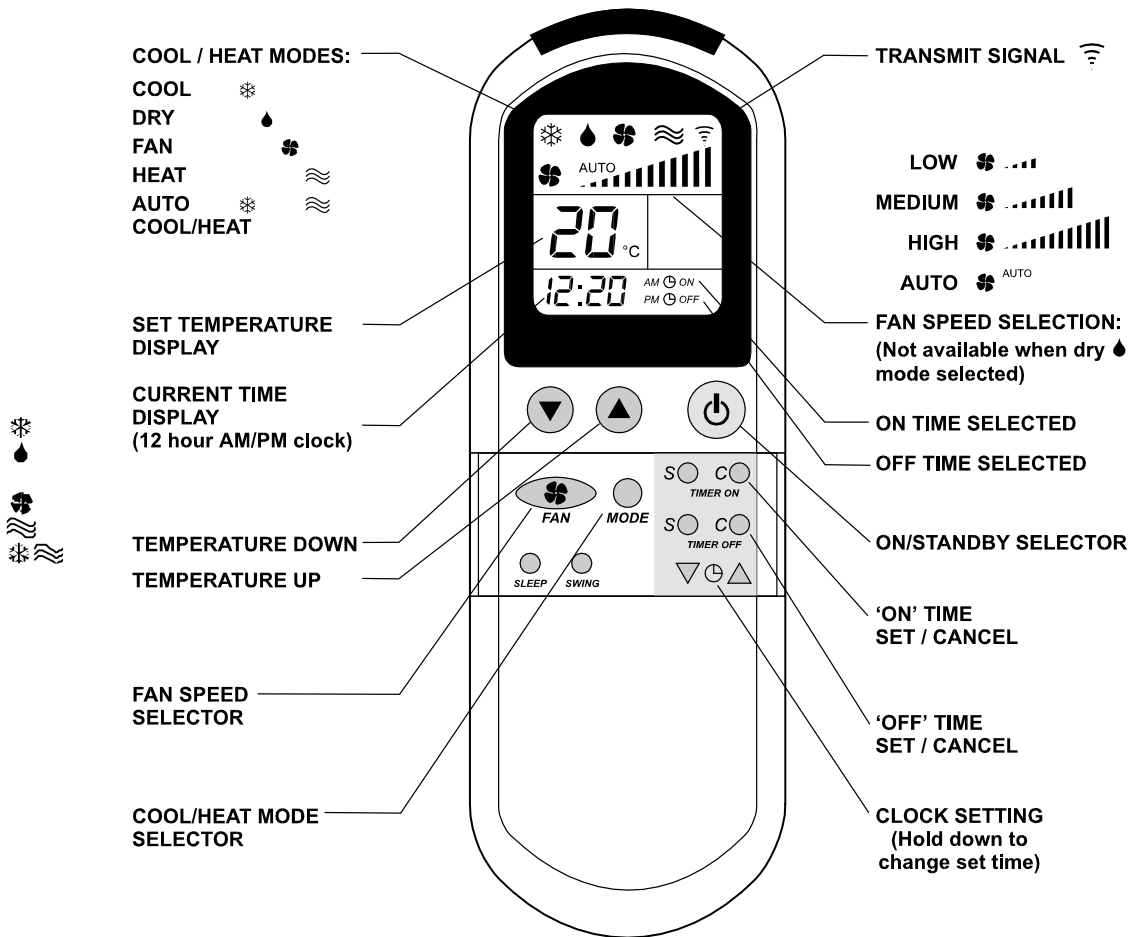

- The handset should be pointed towards the unit.
- Two seconds after the last button press, the whole displayed programme is automatically transmitted.
- The unit responds with 1 beep.
- The transmit symbol A flashes whilst transmission is taking place.
- Displayed values may be re-sent at any time by pressing the pink H button twice.

1. Remote Controller Power Up

Slide off the front cover and insert two "AAA" size 1.5V batteries.

The initial display will show:

COOL

TEMPERATURE

TIME



HIGH FAN SPEED

2. Setting Cool/Heat/Dry Modes

COOL - Unit cools when required but cannot heat

DRY - Unit removes moisture by cycling cooling at low speed, humidity is reduced, but room temperature is not changed.

FAN ONLY - No cooling or heating - fan only

HEAT - If heating is available, unit heats when required but cannot cool.

AUTO COOL/HEAT- Unit cools or heats when required (if heating is available)

3. Setting the Fan Speeds

Repeated pressing of the 'fan speed selection' button selects low, medium, high and auto speeds. In 'auto' selection, the fan runs at high speed when there is a difference of more than 2°C between the room temperature and the set (required) temperature, and low speed when less than 2°C.

4. Setting the Temperature ▼⏸▲

Press the [up] or [down] 'set temperature' button to alter the display between 16°C and 30°C. By holding both buttons down, the display is changed between °C and °F.

5. Setting the Clock (Current time)

The [up] and [down] buttons must be held down for 3 seconds before they operate. Continue to hold the button down for rapid change.

6. Programming the Timer

The 24 hour timer can have one ON command or one OFF command or one ON/OFF cycle in a 24 hour period. Blank ON and OFF timer windows indicate that the timer is not programmed.

7. Setting the ON Time

Press the TIMER ON set [S] button and step to the required ON time. Hold the button down for repeated stepping. Press the TIMER ON [C] button to cancel the ON time.

8. Setting the OFF Time

Press the TIMER OFF [S] button and step to the required OFF time. Hold the button down for repeated stepping. Press the TIMER OFF [C] button to cancel the OFF time.

9. Only ON Time Selected

Unit will turn ON at the selected time and stay ON.

10. Only OFF Time Selected

Unit will turn OFF at the selected time and stay OFF.

11. Use of the Pink H ON/STANDBY button when time programmes are selected

At any time, pressing the Pink button will either start the unit or return it to standby mode. The unit will remain at this condition unless an appropriate ON or OFF time has been programmed.

12. Cold Start

In Cool or Heat mode, not Auto, after more than 3 days without power, or after 2 hours of non-operation, the set temperature is automatically raised (in heating mode) or lowered (in cooling mode) by 2°C until this temperature is reached or the unit has run for 20 minutes after which the unit operates with the displayed temperature. This decreases the time taken to reach set point.

13. Fan Speed (heat pump systems only)

In heat pump systems, the indoor fan always starts at low speed in heating mode, and changes to the selected speed when the indoor coil is warm, returning to low speed when not calling for heating.

14. Off cycle delay

To prevent operational problems, cooling restart is delayed for 3 minutes following power up, or from the time the unit was last cooling or heating, (if heat pump). Cooling or heating, (if heat pump) will operate for a minimum of 2 - 3 minutes

15. Displays

Cool D Green	Dry I Red	Fan 4 Red	Heat F Amber	DIAGNOSTICS
OFF	OFF	OFF	OFF	No power, manual OFF, timed OFF, condensate high level, fault in condensate
ON	OFF	ON	OFF	Cooling mode selected
ON	OFF	ON	BLINKS	AUTO - predominantly cooling
OFF	OFF	ON	ON	Heating mode selected
BLINKS	OFF	ON	ON	AUTO - predominantly heating
OFF	OFF	ON	OFF	Fan mode selected
OFF	ON	ON	OFF	Dry mode selected
OFF	OFF	OFF	BLINKS	Outdoor unit defrosting

Diagnostics

OFF	OFF	BLINKS x 4	OFF	Room sensor missing
OFF	OFF	BLINKS x 4	OFF	Indoor coil sensor missing
OFF	BLINKS	BLINKS x 4	OFF	Heat pump only, outdoor coil sensor missing
BLINKS	OFF	BLINKS x 1	OFF	Compressor overload

16. Heat Pump Only

If the outdoor coil temperature reaches 68°C, the compressor and outdoor fan will stop until the coil cools to 50°C.

17. Commands Refused

- Attempts to set temperatures outside the display range are not transmitted.
- If heating commands are refused, the installer's programming is incorrect - call the engineer.

18. Battery Replacement

It is advisable to replace the batteries as soon as the display begins to fade. Correct transmission cannot be guaranteed if the battery is failing.

2 x 1.5V AAA
batteries

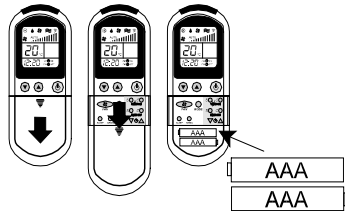

19. Power Cuts

The unit permanently memorises its settings.

20. User Maintenance

Isolate the unit at the mains supply before commencing any maintenance work.

The unit should always be used with a filter. In order to maintain efficiency it is important that the filter behind the air intake grille is cleaned regularly:

- Remove the filter(s) from behind the air intake grille.
- Wash the filter (in tepid water only) and shake dry before use.
- Alternatively tap the filter gently to remove dust or vacuum clean.
- To clean the unit use soap or a non-scratch liquid cleaner.

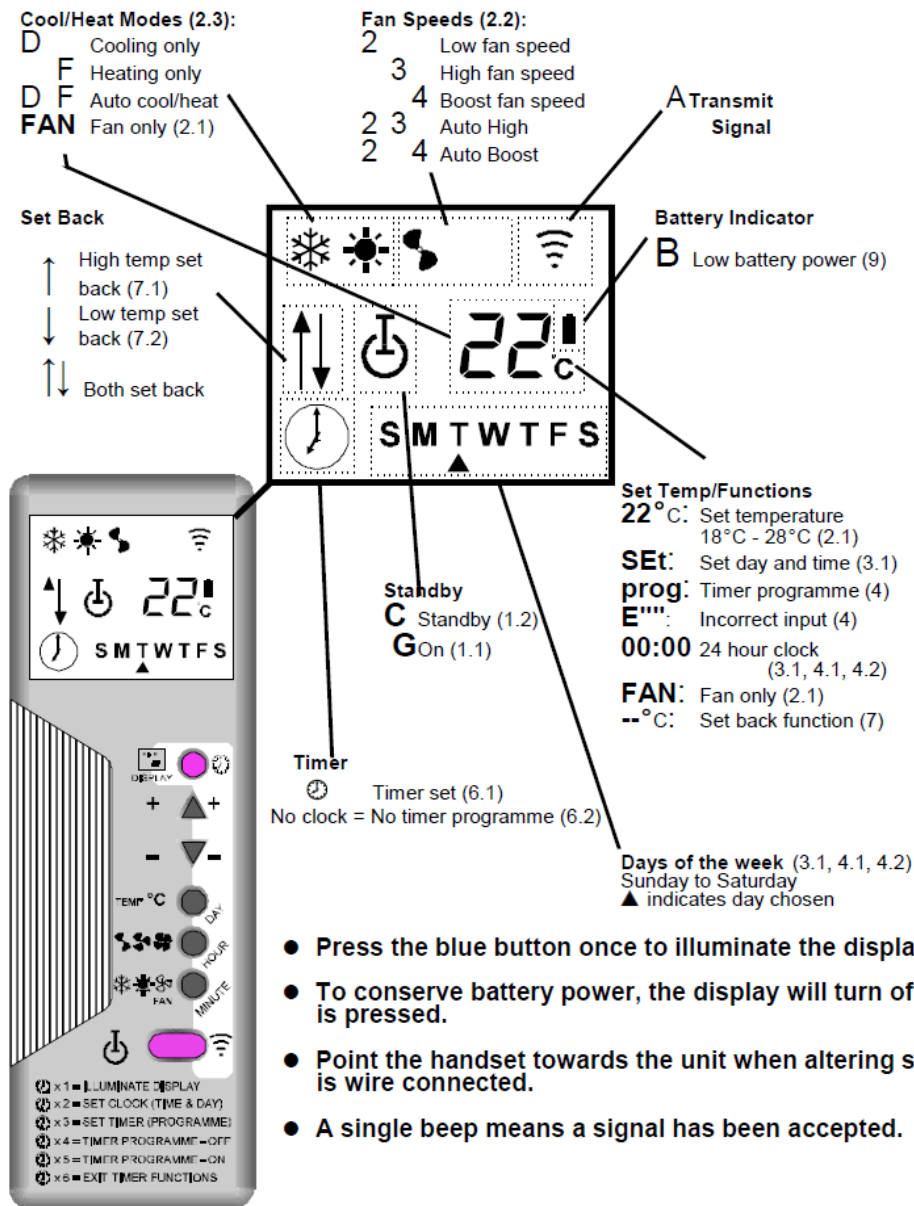

- Press the blue button once to illuminate the display.
- To conserve battery power, the display will turn off after 1 minute if no button is pressed.
- Point the handset towards the unit when altering settings, unless the handset is wire connected.
- A single beep means a signal has been accepted.

1 On/standby

1.1 Starting the unit:

Press the blue button once to illuminate the display.

Press the orange button (C) to switch the unit between 'standby', (red LED on the unit flashing at 5 second intervals), and 'on', (red LED on the unit permanently on).

1.2 Stopping the unit:

Press the blue button once to illuminate the display.

Press the orange button (C) to switch the unit between 'on', (red LED on the unit permanently on), and 'standby', (red LED on the unit flashing at 5 second intervals).

2 Basic Functions

2.1 To change the temperature setting (18°C to 28°C):

- Illuminate the display (blue button).
- Press **TEMP °C** button - the temperature digits will pulse.
- Press the + or - (▲ or ▼) button, whilst pointing the handset towards the unit, (unless the handset is wire connected). Each press of the + or - (▲/▼) button will increase/decrease the temperature setting by 1°C and transmit the new setting to the unit. A single beep means the signal has been accepted.

NOTES:

- Temperature settings cannot be changed if FAN is displayed; pressing the **TEMP °C** button in this state will cause the word FAN to pulse (see 2.3).



2.2 To change the fan speed:

- a. Illuminate the display (blue button).
- b. Press 234 (fan speed) button - the fan symbol will pulse.

- a. Press the + or - (▲ or ▼) button to select the 5 fan speeds 2/3/4/23/2 4 (see page 2), whilst pointing the handset towards the unit, (unless the handset is wire connected). Each press of the + or - (▲/▼) button will increase/decrease the fan speed by 1 step and transmit the new setting to the unit. A single beep means the signal has been accepted.

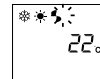

NOTES:

- In auto high and auto boost modes, the fan runs at low speed unless the room temperature is (2° or 3°) different from the set temperature, in which case the fan runs at high or boost respectively.
- Auto high and auto boost functions cannot be accessed whilst 'FAN ONLY' is selected, (FAN displayed, see 2.3).

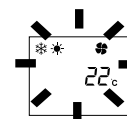

2.3 To change the Cool/Heat/Fan Only Mode:

- a. Illuminate the display (blue button).
- b. Press DF6 (Cool/Heat/Fan Only) - the mode symbols will pulse.
- a. Press the + or - (▲ or ▼) button to select the 4 Cool/Heat modes D/F/DF/FAN (see page 2), whilst pointing the handset towards the unit, (unless the handset is wire connected). Each press of the + or - (▲/▼) button will increase/decrease the mode by 1 step and transmit the new setting to the unit.

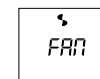

NOTES:

- Transmission of a heat or cool/heat command to a cool only unit will be accepted but the heat function will be ignored – the unit will continue to operate in cooling only mode.
- Each press of the + (▲) button will cycle through the options in the order D/F/DF/FAN, whilst the - (▼) button will cycle in the reverse order.
- Selecting FAN (fan only) will display FAN and cause auto high and auto boost functions to default to low speed.

CLOCK/TIMER FUNCTIONS

(If the clock/timer functions are not required, ignore sections 3 to 7.)

- Clock and timer functions are accessed by repeatedly pressing the BLUE clock button (⌚).
- The other buttons then assume functions shown in the blue stripe.



3 Clock Functions

3.1 To set the correct day and time:

- a. Press the blue button (⌚) twice - the display shows SEt.
- b. Press the DAY button - the display shows 12:00 and the days of the week, with a pulsing arrow (▲) under M (Monday).
- c. Press the + or - (▲ or ▼) button until the arrow is under the correct day:
- d. Press the HOUR button - the hours digits will pulse.
- e. Press the + or - (▲ or ▼) button until the correct hour is displayed: 24.00 hours is displayed as 00:00.
- f. Press the MINUTE button - the minutes digits will pulse.
- g. Press the + or - (▲ or ▼) button until the correct minutes digits are displayed:
- h. Transmit using the orange A button. A single beep means the signal has been accepted.



NOTES:

- Days, hours and minutes are programmable in any order and may be revisited in any order before transmission.
- Once set, the day or time should only need resetting when the clocks go back or forward; if in any doubt, reset.



4 To view or change the 7 day timer programme

4.1 To view the programme:

- a. Press the blue button (⌚) three times - the display shows prog.
- b. Press the DAY button - the screen will display S M T W T F S with an arrow (▲) under M (Monday), the 'on' symbol (G) and 08:00, (the preprogrammed Monday switch ON time).
- c. Pressing the DAY button again will display the 'standby' symbol (C) and 17:30, (the preprogrammed Monday switch OFF time).
- d. Further pressing of the DAY button will step through first the ON and then the OFF time for each of the 7 days and finally back to Monday. The whole week's programme may be viewed, without modification, by this means.



NOTES:

instead, (see 4.2).

4.2 To change the ON or OFF time of any day or days:
(the timed programme will not operate correctly if the clock in the unit has not been set,

see 3.1)

Err

- Press the blue button (⌚) three times - the display shows prog.
- Press the DAY button - the screen will display S M T W T F S with an arrow (▲) under M (Monday), the 'on' symbol (G) and the programmed Monday switch ON time.
- Repeatedly press the DAY Button until the desired day is indicated by an arrow together with the desired 'on' (G) or 'standby' (⌚) symbol.
- To change the Hour:** Press the HOUR button - the hours digits will pulse. Press the + or - (▲ or ▼) button until the desired hour is displayed.
- To change the Minutes:** Press the MINUTE button - the minutes digits will pulse. Press the + or - (▲ or ▼) button until the desired minutes are displayed.
- Press the DAY button to continue to the next ON or OFF time, and repeat until all required days have been re-programmed, then transmit using the orange A button. A single beep means the signal has been accepted.

OFF

22.0

NOTES:

- If an illogical selection is made (e.g. 'off' time earlier than 'on' time, or 'on' time with no 'off' time, or 'off' time with no 'on' time), the programme will not move on to another day, or transmit, until the error is removed. E"" will be displayed each time the DAY, or orange A button is pressed, and the display will switch between 'on' and 'off' times until a logical time is entered.

prog

ON

5 Switching the timer off

5.1 To return a unit, currently running under a timed programme, to MANUAL ON/OFF control:

- Press the blue (⌚) button four times - the display shows OFF.
- Transmit using the orange A button. A single beep means the signal has been accepted.
- The screen will display the basic functions. The clock ⌚ symbol will be removed to show that the unit has been instructed to run under manual ON/OFF control.

2.0

NOTES:

- If the OFF display is transmitted during a timed run period, the unit will continue to run until turned off by pressing the orange A button, (whilst the basic screen is displayed).
- If the OFF display is transmitted during a timed off period, the unit will remain in 'standby' until turned on by pressing the orange A button, (whilst the basic screen is displayed).
- Any setback functions programmed will also be switched off (see section 7).
- The programme OFF signal can be re-transmitted at any time.

6 Switching the timer on

6.1 To run a unit under a timed programme:
(the timed programme will not operate correctly if the clock in the unit has not been set, see

3.1)

- Press the blue button (⌚) five times - the display shows ON
- Transmit using the orange A button. This will transmit the programme in the handset to the unit.. A single beep means the signal has been accepted.
- The screen will display the basic functions and the clock ⌚ symbol to show that the unit has been instructed to run under timed ON/OFF control.

NOTES:

- If the ON display is transmitted during a timed run period, the unit will continue to run until turned off by the timer programme.
- If the ON display is transmitted during a timed off period, the unit will remain in clock controlled 'standby' until turned on by the timer programme.
- Any setback functions programmed will also be restored, (see section 7).
- The programme ON signal can be re-transmitted at any time

7 Set Back Function

During a programmed switch OFF period it is possible to have the unit automatically heat (if electric heating is fitted or it is a heat pump unit) if the temperature falls below a preset LOW limit, or cool if it rises above a preset HIGH limit.

NOTES:

- If either set back temperature is set to anything other than --°C, the indoor unit's fan will run at low speed during the switched OFF period in order to circulate air over the sensor.
- The set back function will apply to all 7 days of the week, even if the unit does not normally run, say at weekends.
- Active set back is indicated by a double flash of the red LED on the unit, repeated at 15 second intervals.

7.1 To set or change the Set Back LOW temperature limit:

- Illuminate the display (blue button).
- Whilst holding down the MINUTE button, press the Blue (⌚) button, then release both buttons - the screen will display --°C. (If a set back temperature has already been set, this temperature and a down arrow ↓ will be displayed).
- If no temperature has been set, press the + (▲) button first, then the + or - (▲ or ▼) buttons to select the minimum temperature to which the room should fall before the unit switches on in heating mode. (Temperature range from 5°C to 1° below the set point temperature).
- Transmit using the orange A button. A single beep means the signal has been accepted.

NOTES:

- The up and down arrows will be added to the basic display, to indicate that set back has been programmed.
- Setting the set back LOW function only will default the setback HIGH function to 30°C
- Pressing the - (▼) button at 5°C will display --°C and remove both the LOW and HIGH set back functions.



7.2 To set or change the Set Back HIGH temperature limit:

- Illuminate the display (blue button).
- Whilst holding down the HOUR button, press the Blue (⌚) button, then release both buttons - the screen will display --°C. (If a set back temperature has already been set, this temperature and an up arrow ↑ will be displayed).
- If no temperature has been set, press the - (▼) button first, then the + or - (▲ or ▼) buttons to select the maximum temperature to which the room should rise before the unit switches on in cooling mode. (Temperature range from 30°C to 1° above the set point temperature).
- Transmit using the orange A button. A single beep means the signal has been accepted.

NOTES:

- The up and down arrows will be added to the basic display, to indicate that set back has been programmed.
- Setting the set back HIGH function only will default the set back LOW function to 5°C
- Pressing the + (▲) button at 30°C will display --°C and remove both the HIGH and LOW set back functions.

8. Low battery power warning

Low handset battery power is indicated by the battery symbol B.

B

NOTES:

- When required, replace the battery with an equivalent alkaline type ensuring that the connector is firmly in position.
- Do NOT use a rechargeable battery.**

9. LED Status and Alarm Indicators

Electronic indoor units have coloured LED's and a sounder to indicate the following status and alarm functions.

LED			Flash Rate ON/OFF (seconds)	Sounder	Condition	Status
Red	Amber	Green				
⌚			ON	OFF	In Operation	Normal
	☀		ON	OFF	Heating Demand	Normal
		❄	ON	OFF	Cooling Demand	Normal
⌚			0.5 / 5.0	OFF	Standby	Normal
⌚			0.5 / 15	OFF	Clock Controlled Standby	Normal
⌚			2 x 0.5 / 15	OFF	Setback	Normal
⌚			0.5 / 0.5	OFF	Filter Clean Advisable	Normal

	☀		0.5 / 0.5	BEEPS	Network Warning	Call Engineer
		❄	0.5 / 0.5	BEEPS	High Condensate Level	Call Engineer
⌚	☀		0.5 / 0.5	BEEPS	Low Pressure Warning	Call Engineer
⌚		❄	0.5 / 0.5	BEEPS	High Pressure Warning	Call Engineer
⌚	☀	❄	0.5 / 0.5	BEEPS	Contactors Overload Operated	Call Engineer
	☀	❄	0.5 / 0.5	BEEPS	Outdoor Fan Fail	Call Engineer
⌚	☀	❄	ON	BEEPS	Sensor Fault	Call Engineer

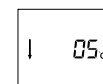
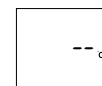

- To avoid unnecessary annoyance, the sounder will stop after 30 seconds and will sound again for 30 seconds if any signal is transmitted to the unit, including start up.

- If the sounder beeps in this way call the Engineer.

NOTES:

- During standby the C LED will flash at 0.5 second intervals as a reminder that the unit has power but is not running.
- To clean the unit use a non-scratch liquid cleaner.

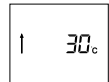

USER MAINTENANCE - FILTER CLEANING

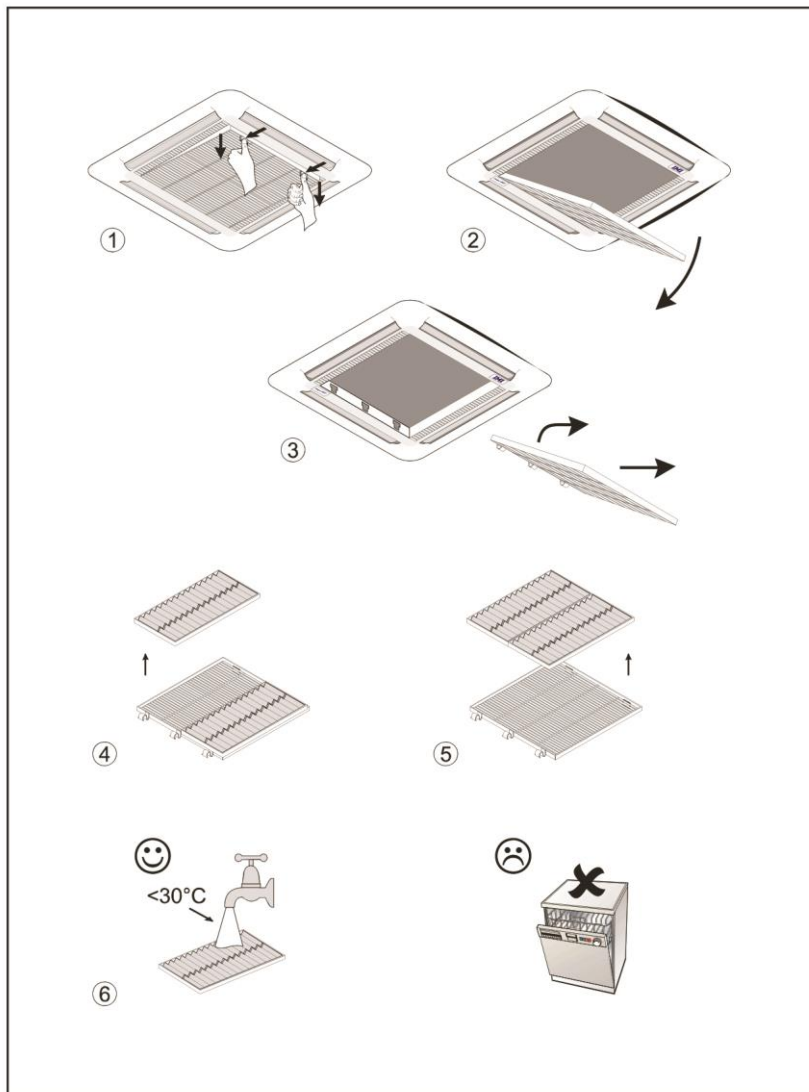

HEATER KITS 1kW 55500311 2kW 55500312 3kW 55500313 4kW 55500314

This kit is for use on CC875 and CWC875 indoor units.
 (It **MUST NOT** be fitted to CWCH875, which have an LPHW coil factory fitted).

ITEM	QTY	DESCRIPTION
1	1	Heater assembly
2	1	Fuse assembly
3	1	Retaining bracket
4	2	Edge clip
5	4	M5 screw

ITEMS 6 - 11
 IN
 4 kW KIT ONLY

ITEM	QTY	DESCRIPTION
6	1	Relay assembly
7	1	No.10 screw
8	1	Orange wire
9	1	Blue wire
10	2	Cable tie
11	1	Link plug
12	2	400V warning label

- It is easier to fit this kit prior to installing the unit
- **DO NOT** blank off any air outlets as this will restrict airflow over the heater elements, causing overheating.
- **ISOLATE THE SYSTEM ELECTRICALLY PRIOR TO INSTALLATION OF THIS KIT (IF INSTALLED)**

FASCIA REMOVAL (if fitted)

Release the two catches on the grille and remove from the fascia complete with filters.
 Release the four retaining screws on the fascia and unclip from the chassis. Store in a clean, safe area

CONDENSATE DRAINING (if the unit has been installed and operated)

IMPORTANT: Prior to removing the chassis it will be necessary to ensure that all the condensate has been removed from the drain.

UNITS WITH A PUMP FITTED

1. Using a 6mm Allen key or a medium sized, flat bladed screwdriver, remove the blanking plug from the drain outlet on the chassis (**Fig. 1**) and collect the condensate in a suitable container.
2. Refit the plug ensuring a good seal.

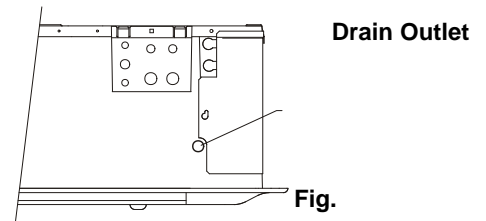

UNITS WITH GRAVITY DRAIN

1. Disconnect the drain hose from the unit, collecting the condensate in a suitable container.
2. Remove the drain stub from the chassis to aid removal through a ceiling grid. (Refit after the chassis is refitted) .

CHASSIS REMOVAL

1. On L and E units only :-
 Remove the return air sensor from the fan guard (slide out from tie wrap).
 Unclip the receiver pcba (**Fig 2.1**).
2. Remove the fan cowl (four screws).
3. Release the internal electrics tray by removing the two screws (**Fig 2.2**)
 Support the tray until both screws are released; do NOT allow to hang by one screw.
4. **If the unit is installed:** hang the internal electrics tray from the lug on the motor shaft using the hook on the tray. Remove the four chassis retaining screws and lower the chassis.
 Unhook the electrics plate from the motor shaft and hook onto a lower fixing lug on either of the coil brackets adjacent to the electrics corner.
5. **If the unit is NOT installed,** move the internal electrics tray into the centre of the fan to allow removal of the four chassis retaining screws. Lift off the chassis.
 Ensure the electrics plate is clear of the fan compartment by resting the plate over the top of the coil.

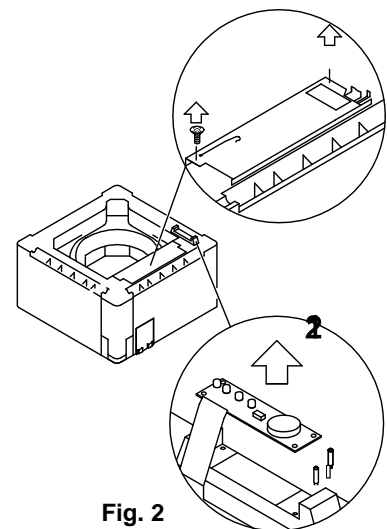
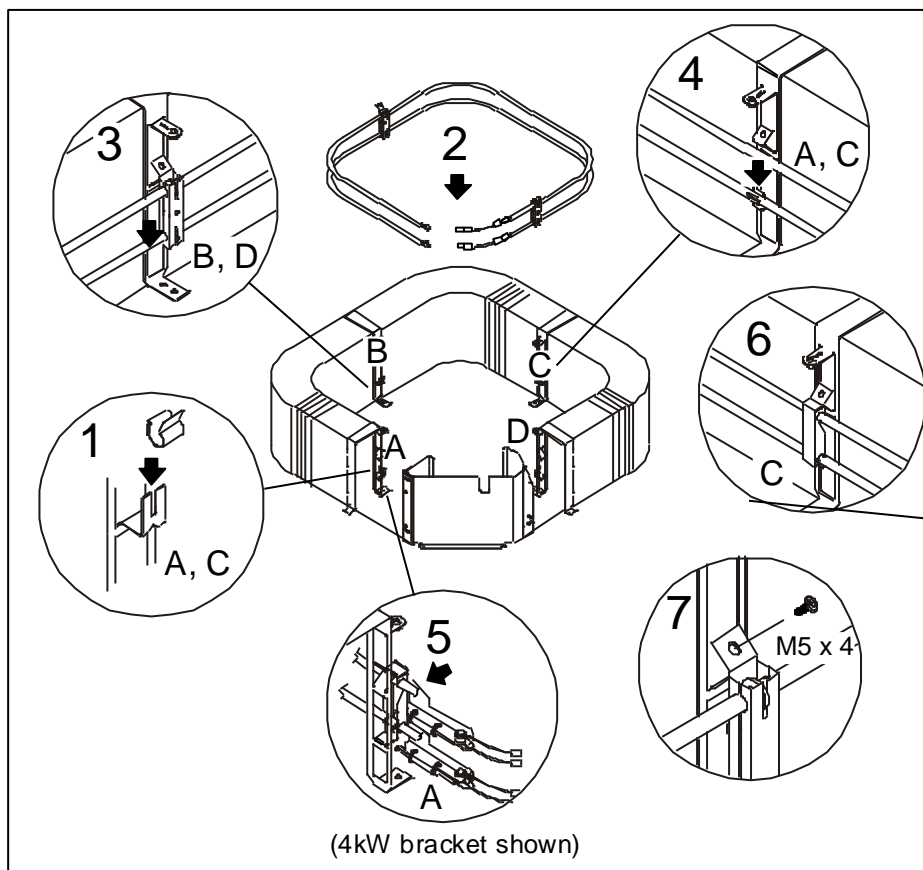

Fig. 2

FITTING THE HEATER ELEMENTS (Numbers refer to the exploded view)

1. Fit two edge clips centrally on the bottom lugs of the coil support brackets **A & C** (#1)
2. Manipulate the heater assembly into the unit underneath the top fixing lugs on the coil brackets: angle the element assembly to effect correct positioning (#2).
2. Fit the heater brackets over the lower lugs of coil brackets **B & D** (#3).
1. When positioned, push the bottom element into the edge clips on coil brackets **A & C** (#4). (This is primarily as an aid to fitting the elements when the unit is installed in a ceiling).
Secure the heater brackets to the coil brackets **B & D** using 2 x M5 screws.
5. Fit the fuse assembly onto the element(s) at coil bracket **A**. (#5: 4kW assembly shown)
Secure the cut-out bracket to the coil bracket using 1 x M5 screw.
6. Fit the single retaining bracket to the element(s) on coil bracket **C** (#6). Secure the cut-out bracket to the coil bracket using 1 x M5 screw.
7. Ensure all screws are tight. (#7)

EXPLODED VIEW (Fan, motor and part of coil omitted for clarity)



WIRING 1kW / 2kW / 3kW KITS

1. Connect the blue wire(s) from the heater element(s) to the in line connectors located on the inside of the coil

- in - fill plate, opposite the factory fitted blue wire(s).
- 2. Connect the brown wire from the thermal fuse assembly to the in-line connector farthest from the base plate opposite the brown wire with white boot.
- 3. Connect the yellow wire from the fuse assembly to the heater element, on the free terminal nearest the blue protective device.
- 4. Tidy the wires with the cable ties

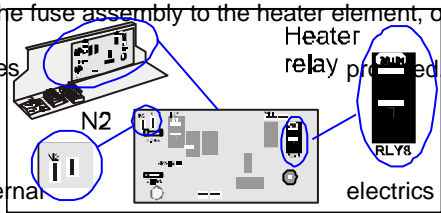

RE-ASSEMBLY

- 1. Refit the chassis, fan cowl, internal electric tray (and return air sensor and receiver pcb on [L] and [E] units).
- 2. **ENSURE ALL FOAM BLANKING PIECES HAVE BEEN REMOVED FROM THE AIR-OFF SLOTS.**
- 3. Reconnect the drain stub pipe(gravity drain units only)and drain hose.
- 4. Refit the fascia.

WIRING 4kW KITS

- 1. Connect two brown wires (from the cutout assy) and two blue wires (from the heater) to the in-line connectors on the inside of the coil in-fill plate (brown opposite brown, blue opposite blue).
- 2. Connect the yellow wires from the fuse assembly to the heater elements, on the free terminals nearest the blue protection devices.
- 3. Fit the kit relay to the internal electric tray using the No.10 screw. **(Fig. 3).**

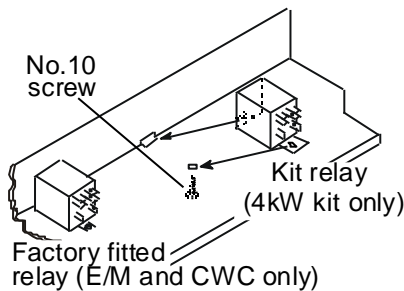

Fig. 3

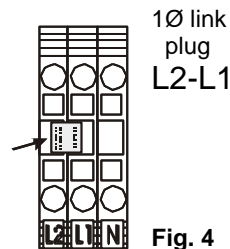

Fig. 4

- 1. **1 Ph units:** Connect the incoming Live supply to L1 and push the link plug hard home between L1 and L2 at the external electric box **(Fig. 4).**
- 3 Ph units: Connect one phase to L1 and another phase to L2. **THE LINK PLUG MUST NOT BE FITTED.**

4kW KIT: ELECTRO-MECHANICAL UNITS: RELAY WIRING

- 1. Remove the orange wire from the kit relay and discard.
- 2. Connect the single terminal ends of the kit wires to the kit relay just fitted:
 - Orange - relay terminal A1 (or a) **(Fig. 5)**
 - Blue - relay terminal A2 (or b)
- 1. Remove the orange and blue wires from the factory fitted relay. Connect to the piggy back end of the orange and blue kit wires and reconnect to the factory fitted relay in the original positions (Orange A1or a, Blue A2 or b).
- 4. Locate the loose black and brown wires on the internal electric trays. Remove the black insulating boots and connect to the kit relay.
 - Black - to 11
 - Brown - to 14.
- 5. Tidy the wires with the cable ties provided.

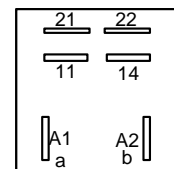
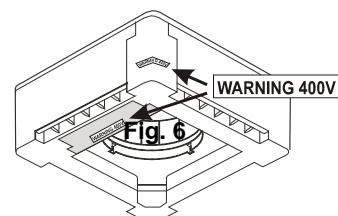

Fig. 5

RE-ASSEMBLY

- 1. Refit the chassis, fan cowl, internal electric tray.
- 2. **ENSURE ALL FOAM BLANKING PIECES HAVE BEEN REMOVED FROM THE AIR-OFF SLOTS.**
- 3. Fit the two 400V warning labels (Fig. 6).
- 4. Reconnect the drain stub pipe(gravity drain units only)and drain hose.
- 5. Refit the fascia.



4kW KIT: 'L' UNITS: RELAY WIRING

1. Remove the orange wire from the kit relay and discard.
1. Join the piggy-back end of the short orange kit wire to the brown wire (4kW brown + orange) already connected to the pcba relay.
2. Connect the other end to the kit relay terminal A1 (or a).
4. Connect the blue wire in the kit to terminal N2 on the pcba.
5. Connect the other end of the blue wire to relay A2 (or b).
6. Tidy the wires with the cable ties provided.

RE-ASSEMBLY

1. Refit the chassis, fan cowl, internal electrics tray, return air sensor and receiver pcba.
2. **ENSURE ALL FOAM BLANKING PIECES HAVE BEEN REMOVED FROM THE AIR-OFF SLOTS.**
3. Reconnect the drain stub pipe(gravity drain units only)and drain hose.
4. Refit the fascia.

4kW KIT: [E] UNITS: RELAY WIRING

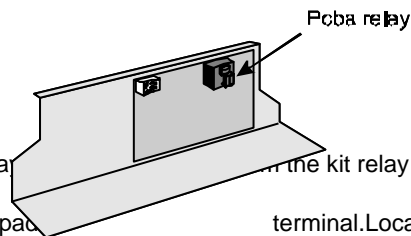

1. Remove the brown wire from the pcba relay in its place.
2. Reconnect the brown wire to the double spade terminal. Locate the loose black, blue and brown wires on the internal electrics tray with the black insulating boots and connect to the kit relay as:-
 Black to No.11 Brown to No.14 Blue to A2 (or b)
 (The loose orange and blue wires provided in the kit are not required for E units).
3. Tidy the wires with the cable ties provided.

RE-ASSEMBLY

1. Refit the chassis, fan cowl, internal electrics tray, return air sensor and receiver pcba.
2. **ENSURE ALL FOAM BLANKING PIECES HAVE BEEN REMOVED FROM THE AIR-OFF SLOTS.**
3. Fit the two 400V warning labels (Fig. 6).
4. Reconnect the drain stub pipe(gravity drain units only)and drain hose.
5. Refit the fascia.

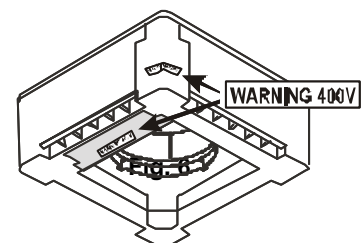

5m HIGH CONDENSATE PUMP KIT 55500303

This kit is for use on all versions of CC875 indoor units and is suitable for condensate removal where a lift of up to a

maximum 5m is required. The pump will run on demand. The sensor has a high level alarm which will switch off the cooling signal until the condensate has dropped below a preset level.

ITEM	QTY	DESCRIPTION
1	1	Pump assembly
2	1	Plastic nut
3	1	Drain plug
4	1	Screw No.10
5	2	Cable tie

- It is easiest to fit this kit prior to installing the unit.
- ISOLATE THE SYSTEM ELECTRICALLY PRIOR TO INSTALLATION OF THIS KIT

FASCIA REMOVAL (IF FITTED)

- 1 Release the two latches on the grille and remove from the fascia complete with the filter intact. Remove the fascia by releasing the four retaining screws and unclipping from the chassis. Store in a clean, safe area.

CHASSIS REMOVAL

IMPORTANT: Prior to removing the chassis it will be necessary to ensure that all the condensate has been removed from the drain.

UNITS WITH GRAVITY DRAIN

- a Disconnect the service drain from the unit and collect any condensate in a suitable container.
- b Remove and discard the drain adaptor from the chassis.
- c Fit the drain plug provided

UNITS WITH A 0.5m LIFT PUMP or HIGH LEVEL ALARM FITTED

- a Using a 6mm Allen key or a medium sized flat bladed screwdriver, remove the blanking plug from the drain outlet on the chassis (Fig.1.) and collect any condensate in a suitable container.
- b Refit the plug ensuring a good seal.

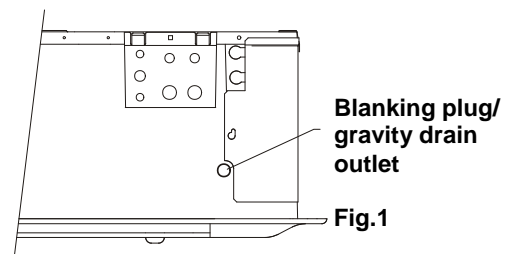

ACCESS TO INTERNAL COMPONENTS

- 1 Remove the external electrics box cover.
- 2 On □L□ and □E□ units, unclip the receiver pcba from the chassis. (Fig. 2.1)
- 3 On □L□ and □E□ units, remove the return air sensor from the fan guard.
- 4 Release the internal electrics tray (2 screws, Fig. 2.2) and remove the fan cowl (4 screws).
- 5 If the unit is installed, hang the internal electrics tray from the fan using the hook fitted to the tray. Remove the four chassis retaining screws and lower the chassis.

If the unit has not been installed, move the internal electrics tray to allow removal of the four chassis retaining screws: lift off the chassis.

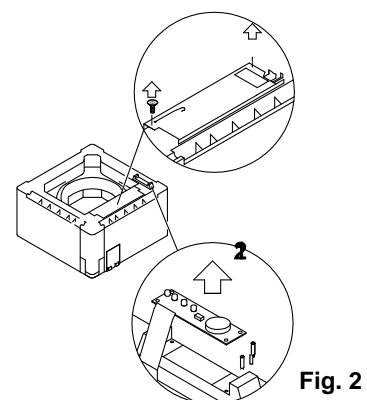

FITTING THE 5m HIGH CONDENSATE PUMP TO 875 UNITS

- 1 E/M models: Remove and discard the red link wire between black plug JP10 and terminal C on the lift pump

pcba.

Remove the yellow wire from second terminal C on the lift pump pcba.

- L or E models: Remove the red wire from the pcba, pull it through to the external electrics panel, disconnect from terminal **C** on the main terminal rail and discard.
- 2 Cut the cable tie securing the hose to the lift pump bracket and pull off the hose from the pump and connector. Remove and discard the connector fitted to the plastic pipe bracket by holding the nut inside and unscrewing the connector.
 - 3 Remove the black plug from JP9/JP10 and the black and blue wires from L and N on the alarm pcba, leaving the wires connected to the unit.
 - 4 Remove the lift pump assembly fixing screw then remove the assembly from the unit.
 - 5 Position the 5m pump assembly (Fig. 3) and, ensuring that the joggle is located in the slot in the coil infill panel, secure using the No.10 screw:
 - 6 Insert the drain connector through the centre hole in the plastic pipe access panel (cutting the insulation if necessary) and, ensuring that the pipe is not kinked or flattened, lock into position with the plastic nut.
 - 7 E/M models only: Connect the free yellow wire (previously disconnected) to the vacant black plug screw terminal.
 - 8 Remove the (unwired) black plug (TB1) from the condensate pump pcba and discard. Fit the wired plug to TB1 and the black and blue wires to L and N on the pcba.
 - 9 Secure the wires to the existing wiring harness using the cable ties.
 - 9 Refit the chassis and fascia.
 - 10 Test as shown on page 4.

Fig. 3

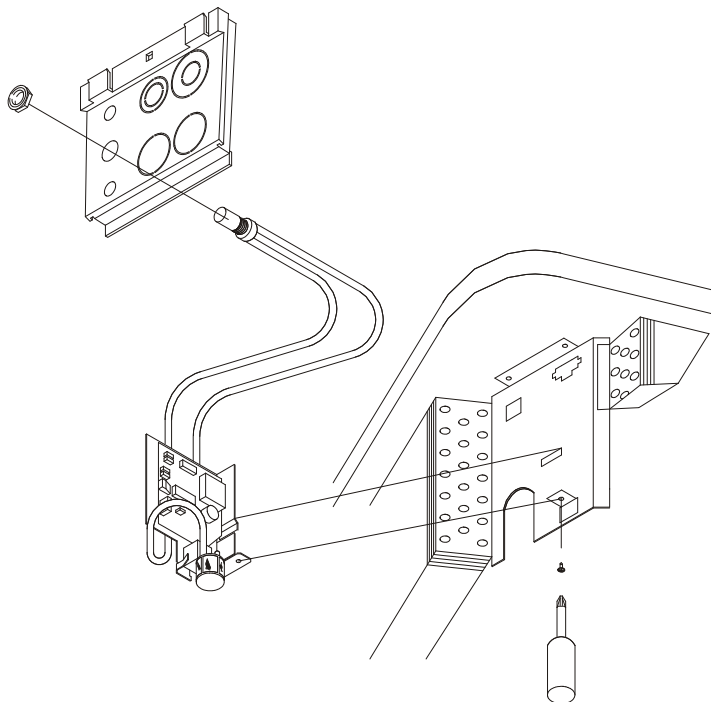

NOTE:

Whenever the electrical supply to a unit fitted with a condensate pump and controls is interrupted, a delay of upto 1 minute will occur, when the supply is reinstated, before cooling or the pump starts.

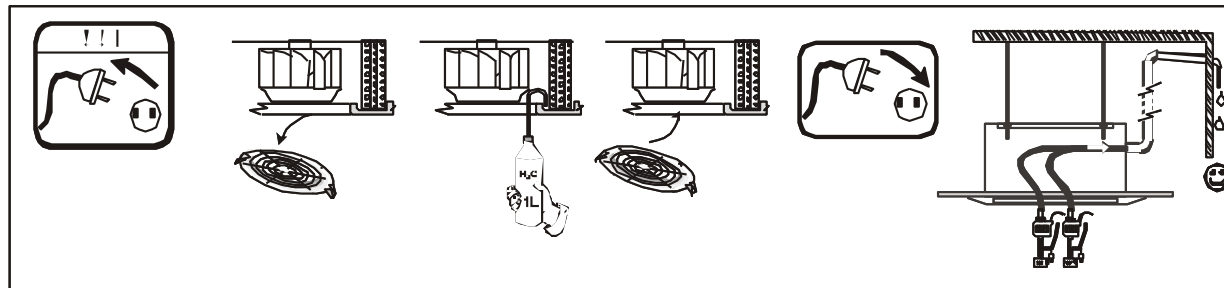
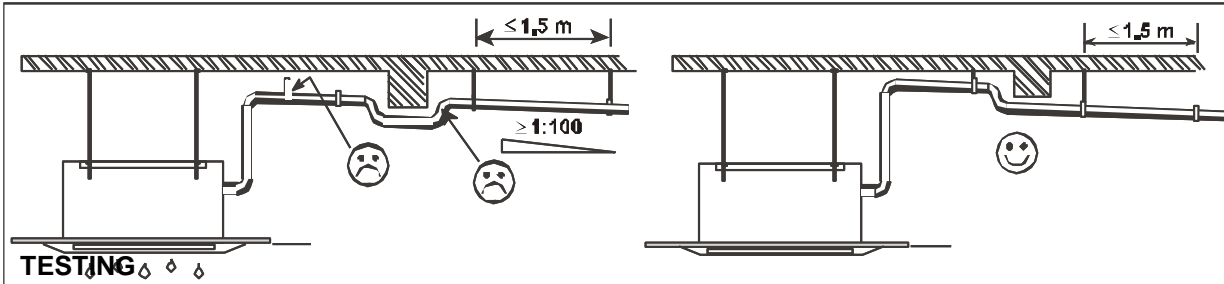
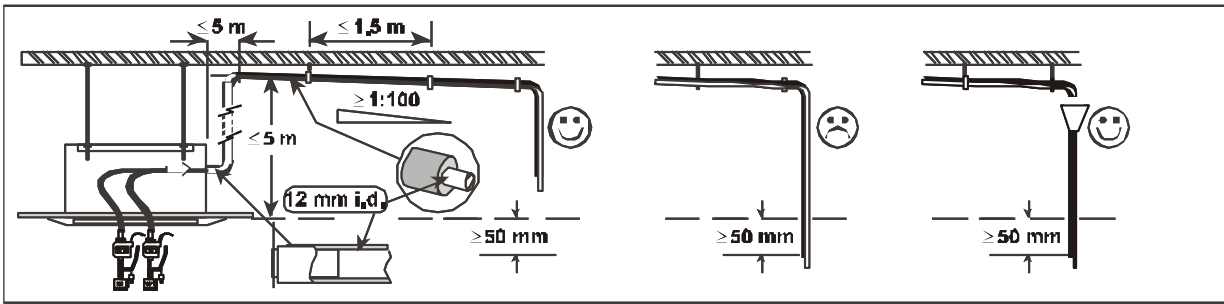

APPLICATION NOTES

- 1 The pump will work against a 5m head. Flow rate is highest with minimum head.
- 2 Long lengths of drain pipe should not be exposed to the outdoor ambient, otherwise freezing of condensate may occur during winter operation.
- 3 It is not advisable to have the outlet of the drain well below the position of the pump, otherwise the syphon effect may open the pump valves.
- 4 For normal applications, i.e. where the drain outlet is level or above the pump or within 1m below it, no extra check valves are needed; the pump has its own internal check valves.
- 5 Ensure that no hoses are kinked, as this could seriously affect the pump performance.
- 6 Regularly clean the filter.

TROUBLE SHOOTING

Unit will not cool	No mains supply to the control board.
Pump does not run	Fuse on control board blown (415mA x 20mm). Sensor disconnected from control board.
Cooling is interrupted	Restriction in pump flow allowing level to Rise and trip overflow circuit. Check for blockage or kink in hoses. Condensate at high level - tripping overflow circuit. Pump and filter blocked - remove and clean.
Excessive pump noise	Air leak in hoses and/or joints. Pumping without water in sump - control board fault. Loose connection between sensor and control board Loose fuse, intermittent mains supply to control board. Water syphoning due to lack of air break.

BMS ALARM INTERFACE KIT 53800423

By fitting a BMS alarm interface kit, a simple common alarm signal is available for volt free input to a BMS network.

Power failure, or any other notifiable alarm state, causes the output relay to de-energise.

Condition OK = system running without fault

Condition Alarm = system mains power loss or notifiable alarm state.

ITEM	No	DESCRIPTION
1	1	BMS Alarm Interface Board
2	4	Mounting Foot (<i>self adhesive for IMPACT-E</i>)
3	4	Mounting Foot (<i>hook type for IMAGE-E</i>)

ITEM	No	DESCRIPTION
4	4	Mounting Foot (<i>long: 4 for IMAGE 600E, 3 for CC875E</i>)
5	1	Orange Wire
6	1	Yellow Wire

MOUNTING

- 1 After gaining access to the electrics panel, fit 3 long mounting feet to the pcb.
- 2 Connect the wires as shown.

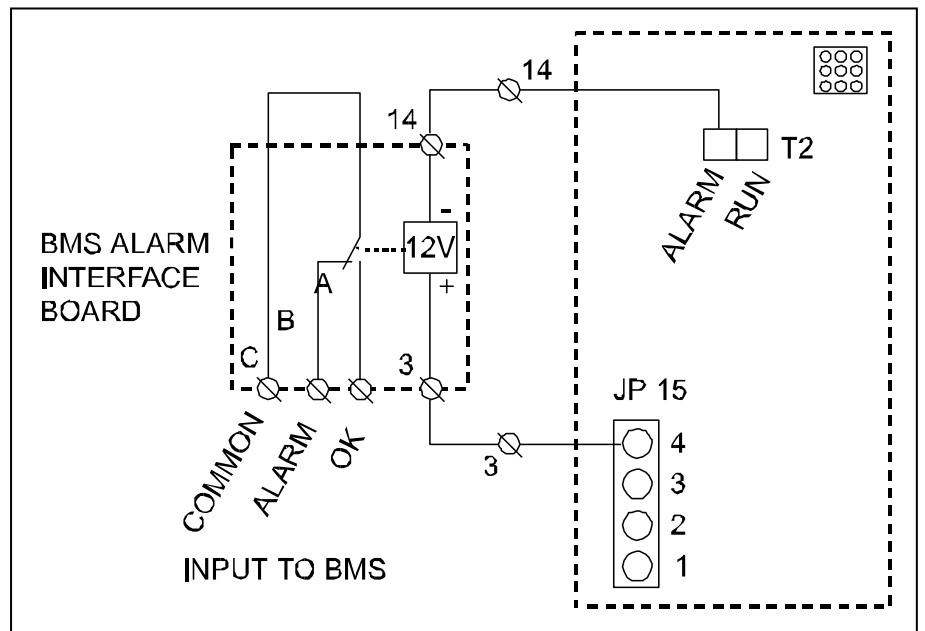
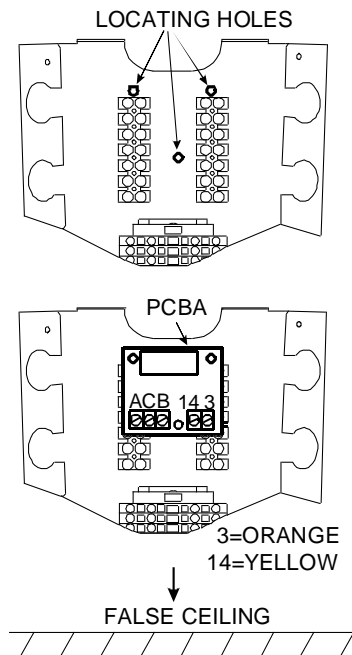

This kit is for use on all CC875 indoor units to provide fresh air to the conditioned space.

ITEM	QTY	DESCRIPTION
1	1	Spigot 100mm diameter
2	4	Screw No. 10

The maximum fresh air that can be introduced into the unit is 5% of the total air volume.

It is easier to fit this kit prior to installing the unit.

ISOLATE THE SYSTEM ELECTRICALLY PRIOR TO INSTALLATION OF THIS KIT

1. Pull out and discard the plastic blanking cap from the relevant corner, **(DO NOT CUT THE POLYSTYRENE)**.
2. Replace with the fresh air supply duct (with the flange nearest the false ceiling when the unit is installed) and secure using the four screws provided.
3. The installer must provide ductwork, a screened source of fresh air and an auxiliary fan.
4. An auxiliary fan must be sized to overcome the resistance of the filter, the ductwork and the IMAGE 875 unit itself. (To prevent excessive noise, the maximum fresh air volume should be 10% of the nominal air volume for any given unit and fan speed)
5. The auxiliary fan should be connected to a separate electrical circuit, appropriately fused and isolated.

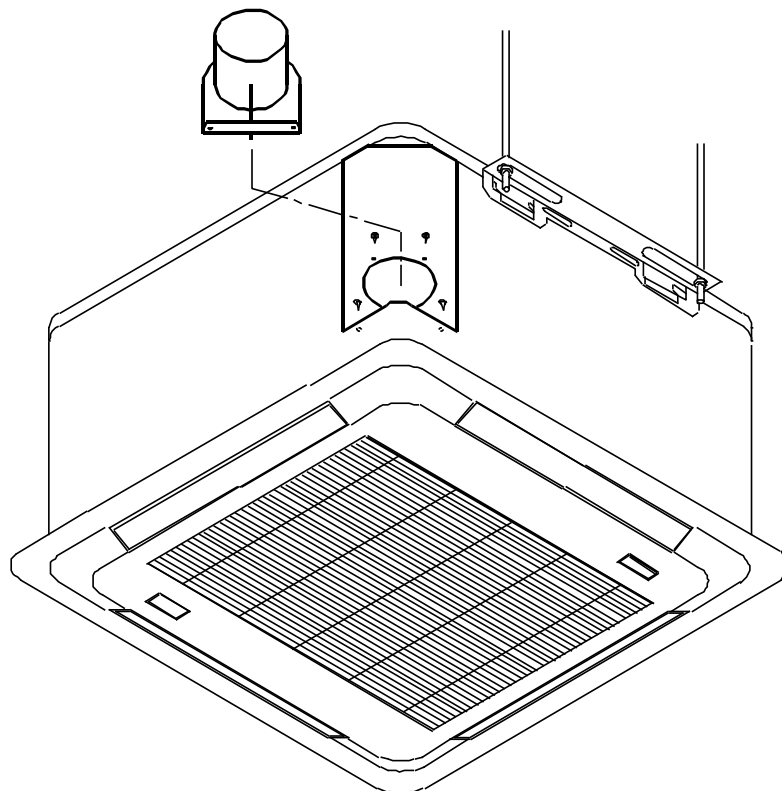

BRANCH DUCT SPIGOT 55500304

This kit provides an air discharge into an adjacent room for all CC875 ceiling cassettes.

ITEM	QTY	DESCRIPTION
1	1	Spigot 150mm diameter
2	2	Screw No. 10

This kit **MUST** be fitted prior to installing the unit.

CHASSIS REMOVAL

1. Remove the external electrics box cover.
2. On 'L' and 'E' units, unclip the receiver pcba (Fig. 1). Also remove the return air sensor from the fan guard.
3. Release the internal electrics tray (two screws (Fig. 1)); Remove the fan cowl (4 screws).
4. Move the internal electrics tray to allow removal of the four chassis retaining screws.
5. Remove the moulded chassis.

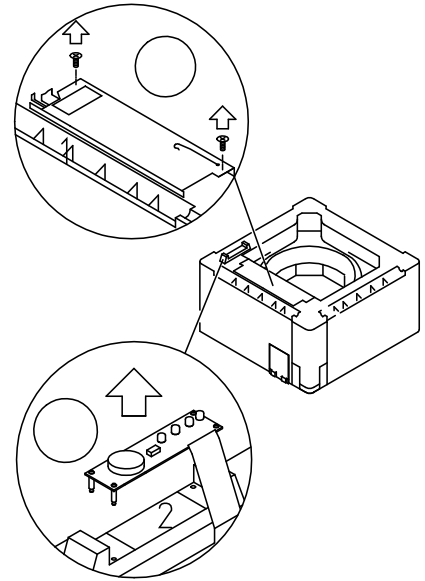

Fig. 1.

FITTING THE KIT

1. Using a small saw blade, carefully cut around the 'U' shaped depression in the side wall of the chassis (area shaded in Fig. 2). Remove any loose beads of material from the edges
2. Secure the spigot to the metal top plate using the two No. 10 screws (Fig. 3).
3. Install the unit on the suspension brackets.
4. Replace the moulded chassis, making a good seal around the spigot.
5. Fit all the removed components.

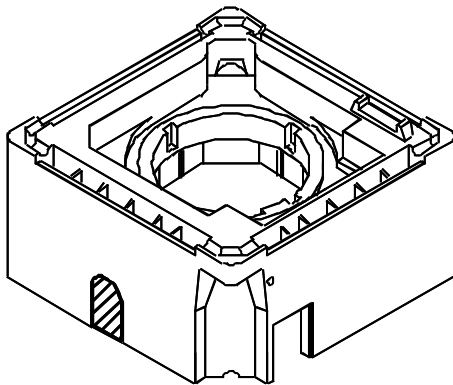

Fig.2.

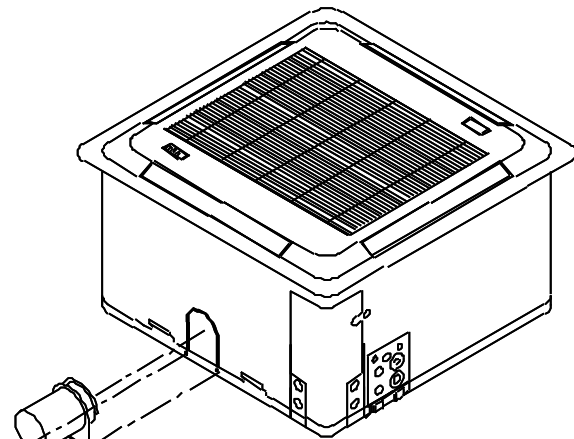

Fig.

3.

This kit is for use with CC875 [E] units where it is desirable to sense room temperature at the wall rather than the unit.

NOTE: An EMC Termination Kit (55200301) MUST be used.

ITEM	QTY	DESCRIPTION
1	1	Sensor Box
2	10m	4 Core Screened Cable

The installer needs to supply:
 2 fixing screws
 2 wall plugs to suit the screws

ISOLATE THE SYSTEM ELECTRICALLY PRIOR TO INSTALLATION OF THIS KIT

- 1 Select a position to mount the sensor taking into account the following comments:
 - a The sensor must be mounted on a flat surface within the area conditioned by the unit to which it is connected.
 - b It is advisable to run the unit in order to locate an appropriate position for mounting the sensor.
 - c Avoid draughts, heat from radiators, temperature variations from hot/cold water pipes and direct sunlight.
 - d Avoid corners of the room where air is likely to stagnate.
 - e Avoid direct air discharge from the unit; on CC875E with a vane motor kit fitted in heating, the air is deflected downwards; in cooling the air flows across the ceiling and down the walls.
 - f Avoid positions where the sensor may be covered or obscured.
 - g If the room contains pillars, mount on the side of the pillar furthest away from the unit. If necessary, consider blocking off the air discharge from the side facing the sensor.
- 2 Depress the clips in the sides of the sensor box with a screwdriver and remove the cover.
- 3 Remove the knockout from the backplate as shown.
- 4 Run the 4 core cable (use screened cable, available in 100m rolls, part number 00526077, for distances greater than 10m) between the unit and the wall sensor. Avoid running the cable in close proximity to any mains wiring.
- 5 Strip back 2 of the 4 cores of the cable at the sensor end by approximately 6mm and, passing the cable through the backplate knockout, connect to the two screw terminals as shown below. Polarity is not important.

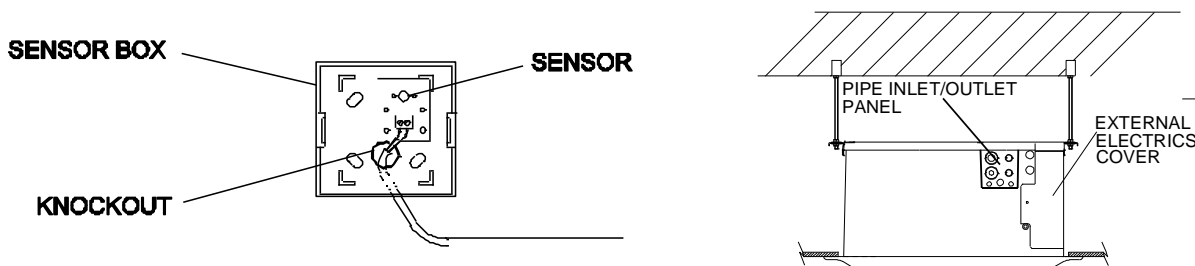

- 6 Prepare the wall to accept the chosen fixings and secure the sensor box to the wall.
- 7 Remove the cover from the mains terminal enclosure on the unit, (shown above). Locate terminals 11 and 12 on the terminal strip.

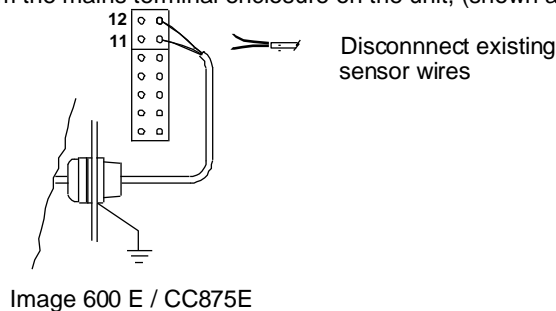

- 8 Disconnect the existing sensor wires from terminals 11 and 12 and tie back out of the way.
- 9 Use an EMC termination kit (55200301). Connect the 2 cores to terminals 11 and 12.
- 10 Test by turning the unit on and switching to different temperatures. A fault is present if all three indicator lights are on and the sounder is pulsing; if this occurs, check all wiring.
- 11 Replace the sensor box lid and mains terminal enclosure cover.

EMC TERMINATION KIT 55200301

This termination gland is required on all CC875 E units wherever low voltage signal cables are used (see table below), to maintain compliance with the EMC Directive. One termination gland can be used for up to 3 cables.

CONTENTS

ITEM	QTY	DESCRIPTION
1	1	Gland Assembly
2	1	Screening Sock
3	2	Cable Tie

Type of connection	No. of cables required
Wall mounted handset	1
Remote temp. sensor	1
Data to MHPUE/DHPUE	1
BMS Control (with alarm)	1 (2)
Networking	2

One termination gland can be used for up to 3 cables. Each cable is four core screened cable, available from TEV in 100m rolls, part number 00526077.

ISOLATE THE SYSTEM ELECTRICALLY PRIOR TO INSTALLATION OF THIS KIT

Method of installation for individual screened or collectively taped screened cable.

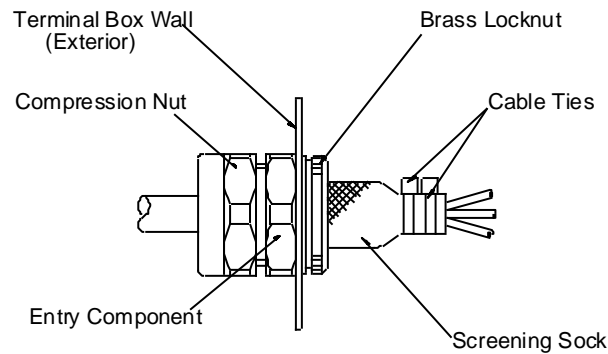

- 1 Prepare the cable(s) by stripping back the outer sheath and the screenings to expose the cores to a length of 150mm.
- 2 Further strip back the outer sheath(s) to expose the individual or collective screening to a length of 25mm. Remove the first (blue) layer and wrap the now exposed earth wire around the shiny foil layer.
- 3 Position the assembled termination with the seal in its relaxed state onto the cable(s) such that the end of the thread is in line with the outer sheath.
- 4 Tighten the compression nut onto the entry component to effect the IP66 neoprene seal. Remove the brass locknut. Cut the screening sock in half and fit half of the screening sock over and around the individual/collective core screens such that the end of the sock is in line with the end of the screening. Tie in position with the cable ties to effect a joint.
- 5 Fit the lock nut over the sock and slightly screw on to the thread.
- 6 For ease of assembly, connect the individual wire cores to the appropriate terminals before pushing the gland assembly into one of the slotted holes in the terminal box. Tighten the lock nut such that the screening sock is secured and anchored and is in direct contact with the internal wall of the terminal box.
- 7 Bend the sock such that it cannot short circuit to any electrical connection.

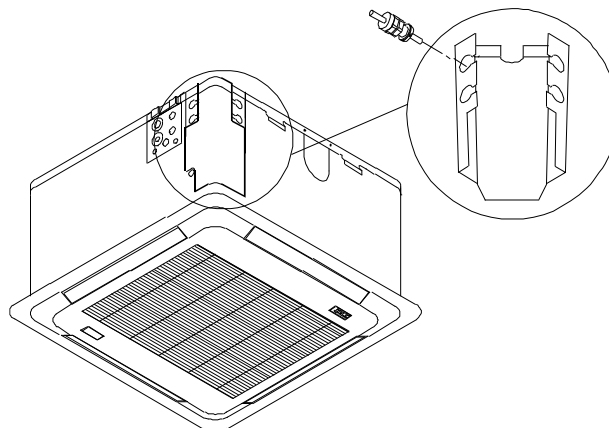

EXPLODED VIEW OF CC875 with COMPONENT IDENTIFICATION

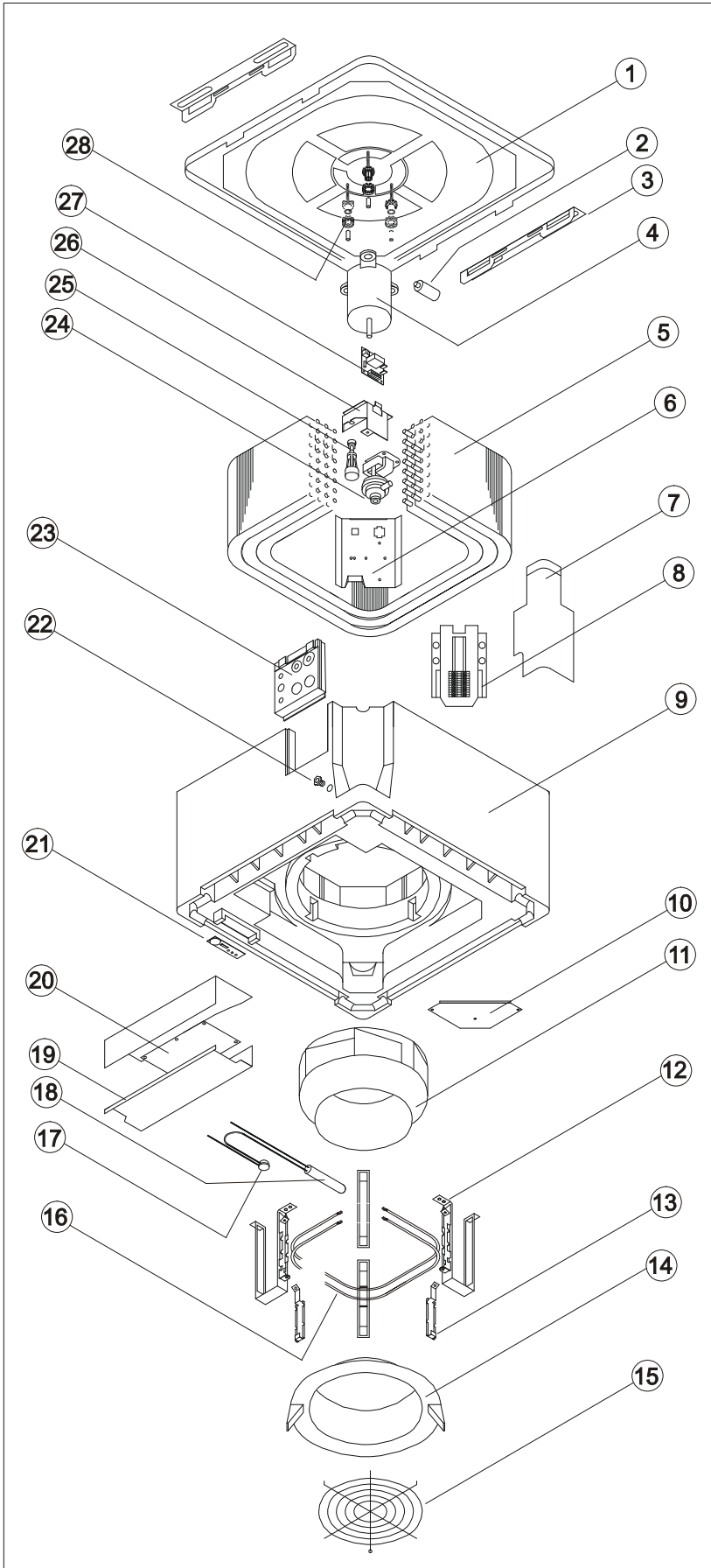

1	Top panel
2	Capacitor
3	Suspension bracket
4	Fan motor
5	Heat exchanger
6	Coil blanking panel
7	Electric box cover
8	External electrics box
9	Chassis
10	Fresh air cover
11	Fan
12	Coil bracket
13	Heater bracket/clip
14	Fan cowl
15	Fan guard
16	Heater element
17	Heater cut out
18	Thermal fuse
19	Internal electrics cover
20	PCBA
21	Receiver board
22	Threaded bung
23	Pipe inset
24	Lift pump
25	Float switch
26	PCBA bracket
27	Condensate PCBA
28	Motor mounting

EXPLODED VIEW OF FASCIA AND VANE ASSEMBLY

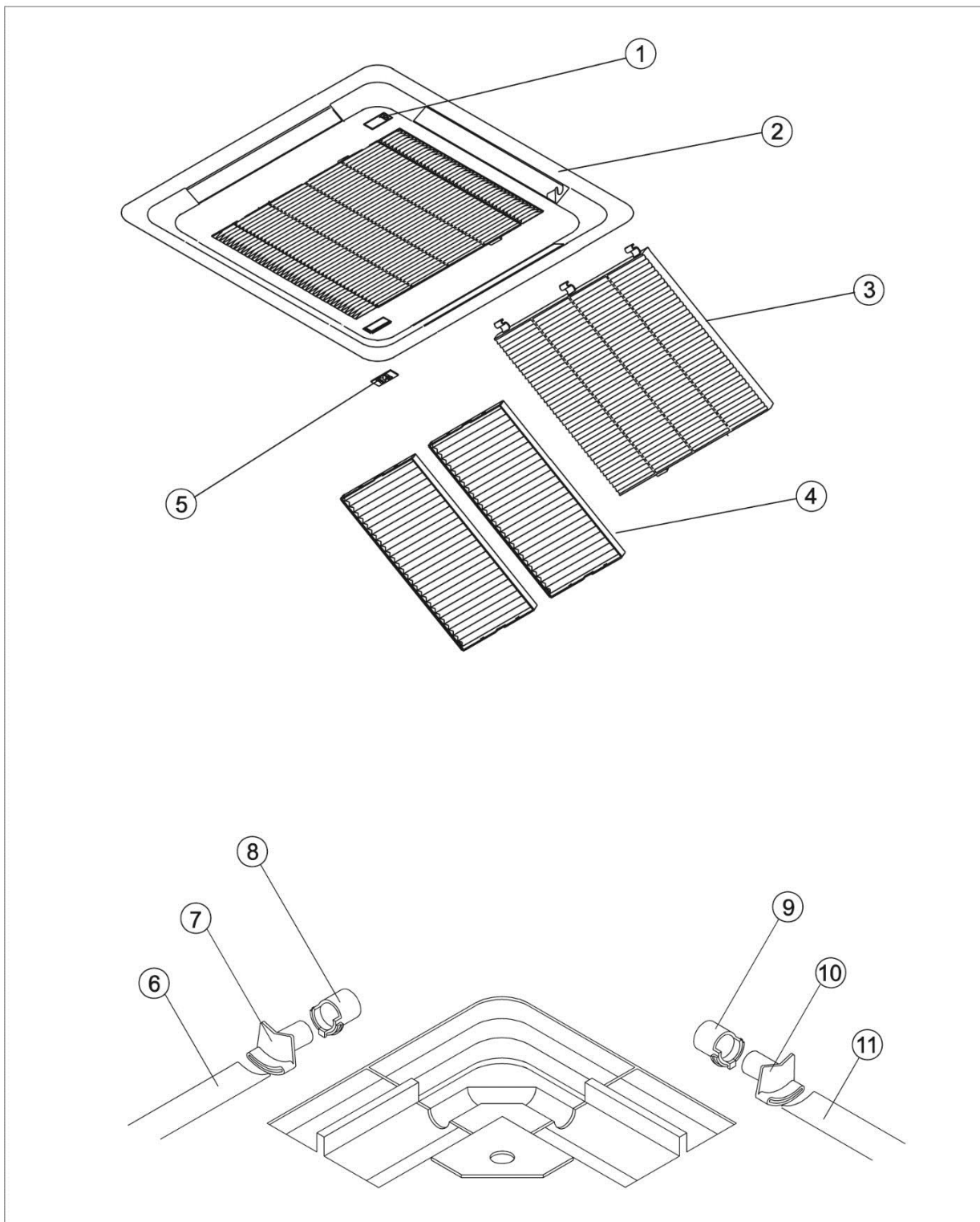

	LED cover
2	Fascia
3	Grille
4	Filter
5	Badge
6	Air deflector vane

7	Vane end cap
8	Vane bearing
9	Vane bearing
10	Vane end cap
11	Air deflector vane

GENERAL FAULT FINDING (ALL SYSTEMS)





	CONDITION	POSSIBLE CAUSE	ACTION
A	Indoor fan motor will not run	No electric supply at socket or switched fuse box	Check fuse rating and replace if necessary. Check for loose electrical connections
		Unit wiring fault	Check wiring and connections
		Fan motor capacitor defective	Replace if faulty
		Fan motor defective	Replace if faulty
		Internal fuse blown	Clear fault and replace fuse
B	Inadequate cooling or heating	Dirty evaporator fins/filter	Clean if blocked
		Evaporator motor not running	As in section A
		Refrigerant shortage or excess	Check for leaks. Repair, evacuate and recharge or check for high head pressure and recover refrigerant if necessary
		Faulty or incorrectly set thermostat	Replace if faulty
		Dirty condenser	Clean if necessary
		Faulty compressor	Replace
		LP cutout circuit open (if LP fitted)	Check as refrigerant shortage or excess
C	Compressor and outdoor fan motor will not run	LP cutout circuit open (if LP fitted)	Check as above
		No electric supply at socket or switch fuse box	Check fuse rating and replace if necessary. Check for loose electrical connection.
		Unit wiring fault	Check wiring and connections
		Capacitor, thermostat, relay or overload defective	Replace if faulty
		Compressor failure	Replace if faulty
		Controls not set properly	Check and rectify
		Off cycle delay operating	If applicable, wait 3 minutes
	High condensate level detected	See G	
Compressor runs, outdoor fan doesn't	Pressure at sensor < 200psig	Normal: or unit may be short of gas	
D	System runs for long periods and will not cycle	Unit underrated for conditioned area	Check heat load against capacity
		Thermostat not operating correctly	Check wiring, position of phial and operation
		Refrigerant shortage	Check for leaks. Recover, repair, evacuate and recharge
	Indoor coil dry or partly sweating	Dirty condenser	Clean fins if necessary
E	Indoor coil frosting	Refrigerant shortage	Check for leaks. Recover, repair, evacuate and recharge
		Dirty evaporator fins/filter	Clean if blocked
		Running in cool ambient without a head pressure	Fit head pressure controller
		If room temperature is also low	Thermostat set too low or cooling permanently
F	Noisy unit	Fan fouling cowl (outdoor unit)	Realign fan
		Worn motor bearing	Replace motor
		Casing or piping vibration	Check cause and rectify
		Loose parts or mounting	Find and tighten
		Bent fan blade	Replace fan
G	Water leaking from unit Units with lift pump or condensate pump	Blocked drain or filter	Clear obstruction
		No supply to pump or loose connection	Secure the supply
		Pumping slowly	Check drain pipes; if clear, replace pump
		Pump windings shorted	Replace pump
		Fouled sensor (5m condensate pump only)	Clean sensor
H	Pump always runs	Faulty sensor or pcb	Replace sensor or pcb
I	No heating	Controls not set for heating	Reset
		Unit wiring fault	Check wiring and connections
		Dirty evaporator fins/filter	Clean
		Faulty thermostat	Check for signal; replace if faulty
		Faulty heater element	Replace
		Faulty heater cutout	Replace, (check for short circuiting)
		Reversing valve jammed	A light tap may free it; preferably replace
J	Overload tripped on three phase units	High voltage supply	Max rated voltage 254v -- check supply
		Compressor failure	Replace
		Fuses blown	Replace fuses and investigate reason for fuses
K	Outdoor unit does not operate	No mains supply	Check fuse rating and replace. Check for loose electrical connections
		Supply below 187V	Check supply
		Isolator switched off	Turn isolator on
		Internal fuse blown	Check fuse and replace
		Data wires disconnected	Reconnect data wires
		No command signal	Check indoor unit
		Off cycle delay operating	Wait in cooling for 3 minutes

SPECIFIC FAULT DIAGNOSIS FOR CC 875L UNITS

CONDITION	POSSIBLE CAUSE	ACTION	
Check for alarms			
i	LEDs flashing - see table below		
ii	If NO external connections are made to alarm terminal 5, the presence of an alarm condition can be tested for by checking for mains voltage at terminal 5; full mains voltage = Alarm; less than mains voltage = Clear.		
The outdoor unit can be caused to operate for test purposes by temporarily linking live directly to terminal 3 (up to 20 seconds delay)			
L	Outdoor unit runs continually at high speed	Charge link still fitted	Remove charge link
		MHPUL in heating	Normal
		Minimum speed adjustment set too high	Reset minimum speed
If all external devices test O.K. the outdoor unit pcb must be replaced			
M	No LED's lit or flashing	Unit commanded to be OFF	Transmit 'ON'
		No mains supply or internal fuse blown. (Fuse F2 on	Check electrical supply and fuses
		Fan motor plug disconnected	Reconnect fan motor plug
		Motor internal thermal protector operated	Check motor and rectify
		Cables to fascia not connected	Reconnect
		Circuit board fault	Check circuit board and replace
		High water level	Check pump circuit (if fitted)
N	All LED's lit, one flashing	Temperature sensor problem	See table below
		Resistor problem (non MHPUL)	Check resistor connected
		Outdoor sensor problem (MHPUL)	Replace outdoor unit sensor/check interconnecting wiring
P	Indoor unit continues after stop/off	Overrun of 30 seconds in heating	Normal
Q	Unit will not respond to infrared commands.	Battery discharged	Replace battery
		Handset corrupted	Reset
R	Unit does not switch on/off at intended times	Power cut has occurred	Send any command from the handset to synchronise the timer
S	Unit not running in intended	Power has been shut off for three or more days, unit	Use handset retransmit button
T	Fan does not run at the intended speed	Heat Pumps Only	Fan runs at low speed until indoor coil is warm, then changes to intended speed
U	Short cycles between cool and heat	System oversized for room	Use cool or heat programmes NOT 'Auto'
V	First operation, room is overcooled	Set point temperature reverts to normal after	Normal
W	Handset will not transmit	Heating commands	Incorrectly configured - see page 23
		Any commands	Battery flat
X	Compressor runs on	Automatic minimum run time of 1.5 minutes	Normal
HANDSET: If the handset fails to respond to button operations, disconnect and then reconnect the battery. The previous programme state is retained in the memory.			

LED STATUS AND ALARM INDICATIONS

Status Displays

Cool  Green	Dry  Red	Fan  Red	Heat  Amber	DIAGNOSTICS
OFF	OFF	OFF	OFF	No power, manual OFF, timed OFF, condensate high level, fault in condensate
ON	OFF	OFF	OFF	Cooling mode selected
ON	OFF	OFF	BLINKS	AUTO - predominantly cooling
OFF	OFF	OFF	ON	Heating mode selected
BLINKS	OFF	OFF	ON	AUTO - predominantly heating
OFF	OFF	ON	OFF	Fan mode selected
OFF	ON	OFF	OFF	Dry mode selected
OFF	OFF	OFF	BLINKS	Outdoor unit defrosting

Diagnostics

BLINKS x 4	OFF	OFF	OFF	Room sensor missing
BLINKS x 4	OFF	OFF	OFF	Indoor coil sensor missing
BLINKS x 4	BLINKS	OFF	OFF	Outdoor coil sensor missing
BLINKS x 1	OFF	BLINKS	OFF	Compressor overload
BLINKS x 2	OFF	BLINKS	OFF	Pump fault

SPECIFIC FAULT DIAGNOSIS FOR CC875L UNITS

A fully electronic system comprising CC875 [E] with MHPUE or DCUE communicates between the units by digital codes. Signals are transmitted every 10 seconds, therefore a delay of up to 10 seconds could occur before the system responds to a command. Similarly if the communication link is broken, the outdoor unit will shut down within 15 seconds. To reset: Switch the mains off to both indoor and outdoor units to reset the microprocessor; the current programme is retained in the indoor pcb memory.

Check for alarms i.e.

i	Audible alarm or LEDs flashing - see below
ii	If NO external connections are made to alarm terminal 5, the presence of an alarm condition can be checked for by testing continuity between L and 5; Alarm = 220ohms, Clear = open circuit. WARNING: All parts of the circuit are at high voltage, if any external connections are made to terminal 5, the continuity meter will be damaged

The outdoor unit can be forced to operate for test purposes by temporarily linking live directly to terminal 3 (up to 20 seconds delay)

L	Outdoor unit runs continually at high speed	Charge link JP6 still fitted	Remove JP6 charge link
		MHPUE in heating	Normal
		Minimum speed adjustment set too high	Reset minimum speed
If all external devices appear O.K. the pcb may need to be replaced			

M	No LED's lit or flashing	No mains supply or internal fuse blown	Check electrical supply and fuses
		Fan motor plug disconnected	Reconnect fan motor plug
		Motor internal thermal protector operated	Check motor and rectify
		Ribbon cable to fascia not connected	Reconnect
		Receiver pcb fault	Check circuit board and replace

N	Regular audible pulsed signal - all LED's lit	Indoor temperature sensor problem	Disconnect data link to identify which unit, if fault clears it is outdoor unit
		Outdoor sensor problem	Replace outdoor unit sensor

O	Indoor unit continues after stop/off command	Overrun of 30 seconds in heating	NORMAL
---	--	----------------------------------	--------

P	Unit will not respond to infrared commands. No audible answer signal	Handset not plugged into wall bracket (if appropriate). Fault in connections between wall bracket and indoor unit	Plug in correctly and check connections
		Battery discharged	Replace battery
		Operating in charge mode	Remove charge link from outdoor unit

Q	Unit answers infrared commands with double audible signal	Communications not yet established. Wait 2 minutes from power up	If electric heater is known to be fitted, double signal indicates open circuit element or thermal protector
		Demanded mode not available	Double signal in response to on/off command indicates under time control

R	Sounder beeps and LED(s) flash 0.5s	Warning of alarm status	Details below
---	-------------------------------------	-------------------------	---------------

S	All LED's lit and continuous audible signal	Microprocessor fault	Replace indoor unit pcb assembly
---	---	----------------------	----------------------------------

T	Short cycles between cool and heat	System oversized for room	Use cool or heat programmes NOT 'Auto' and set to lower speed
---	------------------------------------	---------------------------	---

HANDSET: If the handset fails to respond to button operations, disconnect and then reconnect the battery. The previous programme state is retained in the memory.

LED STATUS AND ALARM INDICATIONS

	LED			Flash Rate ON/OFF (seconds)	Sounder	Condition	Status
	Red	Amber	Green				
Status display				ON	OFF	In Operation	Normal
				ON	OFF	Heating Demand	Normal
				ON	OFF	Cooling Demand	Normal
				0.5 / 5.0	OFF	Standby	Normal
				0.5 / 15	OFF	Clock Controlled Standby	Normal
				2 x 0.5 / 15	OFF	Setback	Normal
				0.5 / 0.5	OFF	Filter Clean Advisable	Normal
Alarm Indications				0.5 / 0.5	BEEPS	Network Warning	Call Engineer
				0.5 / 0.5	BEEPS	High Condensate Level	Call Engineer
				0.5 / 0.5	BEEPS	Low Pressure Warning	Call Engineer
				0.5 / 0.5	BEEPS	High Pressure Warning	Call Engineer
				0.5 / 0.5	BEEPS	Contactors Overload Operated	Call Engineer
				0.5 / 0.5	BEEPS	Outdoor Fan Fail	Call Engineer
				ON	BEEPS	Sensor Fault	Call Engineer